



Beechwood Road, Sheffield, S6 4LN

Offers In Region Of £160,000

🛏️ 2 🚿 1 🚪 1



Why We Love It

Located in the vibrant and popular Hillsborough, Beechwood Road offers residents the best of Sheffield living. The area is known for its friendly community atmosphere and convenient amenities, with Middlewood Road just a short stroll away, providing a variety of shops, cafes, restaurants, and essential services. The location boasts excellent transport links, including the Supertram network, ensuring easy access to Sheffield city centre and beyond. Additionally, Hillsborough Park, a local favourite, offers green spaces for outdoor activities and relaxation.

Why You'll Love It

Beechwood Road is a delightful two-bedroom terraced house located in the heart of Hillsborough. This well-presented home offers comfortable living over two levels.

The ground floor features a spacious living area where a charming fireplace creates a cosy focal point. Leading to a functional kitchen to the rear, with ample workspace and rear garden access.

Upstairs, there are two inviting bedrooms and a 3-piece bathroom. The property is decorated in neutral tones throughout, providing a versatile canvas for personal style.

Externally, the property boasts a small front yard and a large, easy to maintain rear garden, perfect for outdoor activities and relaxation.



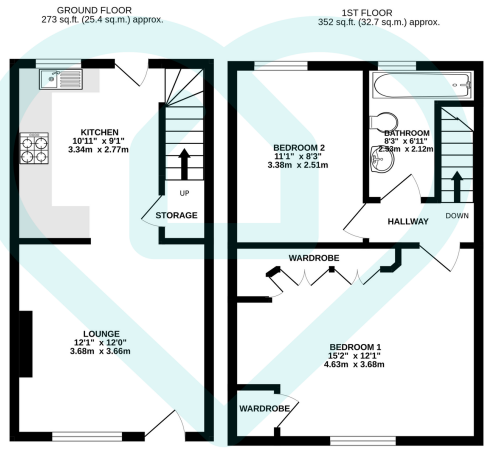

TOTAL FLOOR AREA : 625 sq.ft. (58.1 sq.m.) approx.

This floor plan is for illustrative purposes only. All measurements and layouts are approximations and do not necessarily capture the precise specifications of the property. No responsibility is taken for any error, omission, or misstatement. We always recommend viewing in person to confirm the exact floor plan of a property. Made with Metropix.



- Two Comfortable Bedrooms
- Terraced House in Hillsborough
- Spacious Living Area with Fireplace
- Neutral Décor Throughout
- Large Rear Garden for Outdoor Activities
- Located in Heart of Hillsborough
- Close to Middlewood Road Amenities
- Proximity to Shops, Restaurants, and Cafes
- Excellent Transport Links
- Ideal for First-Time Buyers and Investors



we are morfittsmith

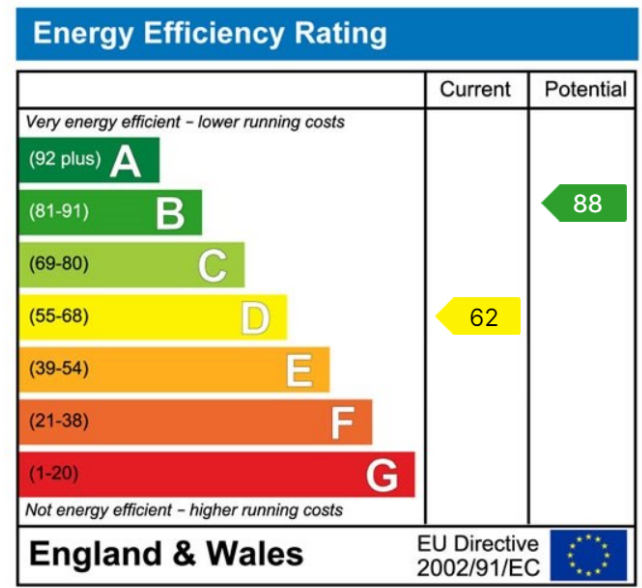

Sales | Lettings | New Homes

VAT Reg Number: 191 3588 84
 Company Reg Number: 08610489
 Company Reg Address: 67 Middlewood Road, Hillsborough, Sheffield, S6 4GX.

The MorfittSmith Building
 67 Middlewood Road
 Hillsborough
 Sheffield
 S6 4GX

Get in touch - arrange an appointment

- 0114 232 1764
- sales@morfittsmith.co.uk
- lettings@morfittsmith.co.uk
- newhomes@morfittsmith.co.uk
- www.morfittsmith.co.uk

- @MorfittSmith
- @MorfittSmith
- MorfittSmith Estate & Letting Agent