





# Langsett Road, Hillsborough, S6 2LL

Offers In Region Of £325,000

🛏️ 6 🚿 2 🚺 2





## Why We Love It

Langsett Road's prime location further enhances its appeal, offering shops and eateries right at your doorstep and a supermarket within walking distance for effortless everyday convenience. Nearby tram stops and bus routes make commuting a breeze, while key road access ensures easy connectivity to surrounding areas. The property's proximity to green spaces like Rivelin Valley and Hillsborough Park provides ample opportunities for outdoor recreation and relaxation, making this an exceptional place to live.

## Why You'll Love It

Upon entering, you are welcomed by an open hallway that leads to a spacious lounge, featuring a charming character fireplace and a large bay window that fills the room with warmth and character. The high ceilings throughout the property add to the sense of space and grandeur. Adjacent to the lounge is a separate family dining room, perfect for gatherings and meals with loved ones. At the end of the hallway, you will find a three-piece bathroom suite and a well-equipped kitchen with ample space for appliances and family cooking. The kitchen offers convenient access to the private back garden courtyard, ideal for outdoor relaxation and entertainment.

Upstairs, the property features three double bedrooms - one with a handy storage cupboard, another bathroom, and an additional kitchen, providing ample accommodation for a growing family or potential tenants. The high ceilings and character fireplaces continue on this floor, enhancing the grandeur and spacious feel. The three-piece bathroom suite on this floor ensures convenience and functionality for daily living.

Ascending to the second floor, you'll find two more double bedrooms, another kitchen, a WC, and a shower, completing the floor plan. The high ceilings on this level again, maintain the airy and open atmosphere.



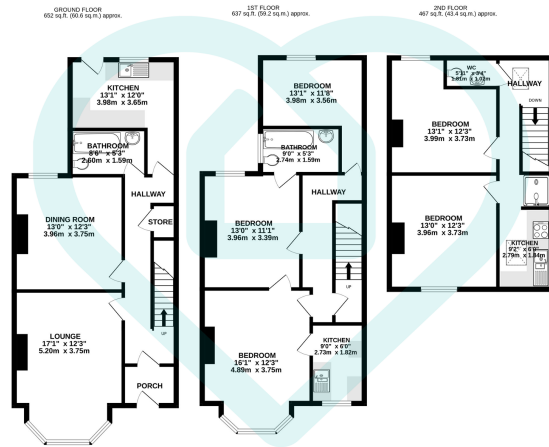

TOTAL FLOOR AREA: 1757 sq.ft. (163.2 sq.m.) approx.

This floor plan is for illustrative purposes only. All measurements and layouts are approximations and do not necessarily capture the precise specifications of the property. No responsibility is taken for any error, omission, or misstatement. We always recommend viewing in person to confirm the exact floor plan of a property. Made with Metropix.



- High Ceilings Throughout
- Prime Location
- Excellent Public Transport Links
- Proximity to Green Spaces
- Spacious Living Areas
- Fantastic Investment Opportunity
- Close to Supermarkets
- Local Schools
- Private Back Garden Courtyard
- Potential 7 Bedroom Home

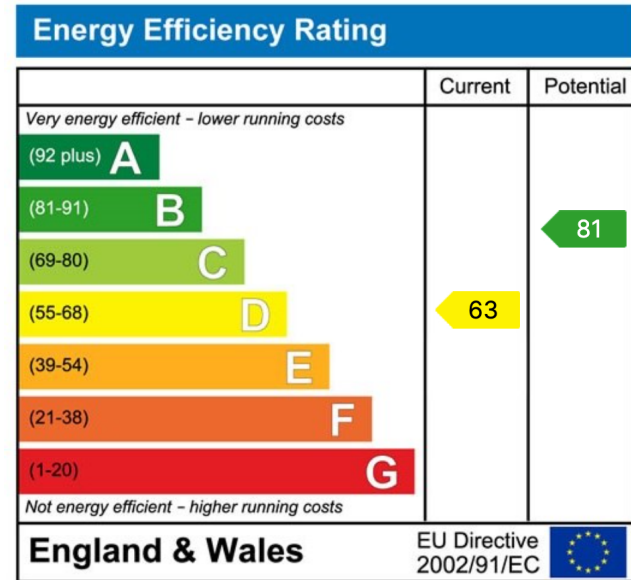

### Sales | Lettings | New Homes

VAT Reg Number: 191 3588 84  
 Company Reg Number: 08610489  
 Company Reg Address: 67 Middlewood Road, Hillsborough, Sheffield, S6 4GX.

The MorfittSmith Building  
 67 Middlewood Road  
 Hillsborough  
 Sheffield  
 S6 4GX

### Get in touch - arrange an appointment

- 0114 232 1764
- sales@morfittsmith.co.uk
- lettings@morfittsmith.co.uk
- newhomes@morfittsmith.co.uk
- www.morfittsmith.co.uk

- @MorfittSmith
- @MorfittSmith
- MorfittSmith Estate & Letting Agent