





# Hunter Road, Hillsborough, S6 4LF

Offers In Region Of £450,000

🛏️ 4 🚿 2 🛋️ 2





## Why We Love It

Hunter Road is ideally located within the sought-after Hillsborough location, offering easy access to local amenities, schools, parks, and excellent transportation links. The property's location provides the perfect balance between peacefulness and city convenience, making it a desirable place to call home!

## Why You'll Love It

Hunter Road is an impressively sized Hillsborough home with no expense spared on every possible improvement.

The ground floor of the home is accessible via the stairs to the front, comprising a living space and kitchen. The living room is a fantastic size with sophisticated décor, a deep bay window affording you a wealth of natural light, and an innovative fireplace feature which functions as a practical log store for the stove in the kitchen. This is a wonderful space for hosting guests and relaxing into the evenings. The large kitchen features stunning modern fittings, sleek integrated appliances and a modern island that doubles as a breakfast bar, making this perfect for enjoying meals together at any time of the day.

The lower ground floor is a really impressive space that has undergone beautiful modernisation, making full use of the original basement. This comprises a generous utility room with ample worktop space and access to the boiler, a shower room, and a stunning reception room. The reception room boasts the same substantial layout of the lounge above it, with a bright bay window and ample room for a myriad of purposes. This would make a fantastic dining room, hobby space, or even a playroom for kids.

On the first floor you will find two bedrooms and the family bathroom. Both bedrooms are a fantastic size with lavish modern décor, one with impressive dual aspect affording you lovely views. The bathroom is a breath-taking four-piece suite with stunning design and freestanding bath affording you a real sense of luxury. There are two further bedrooms on the second floor, each with a dazzling skylight and an arched window. These would make



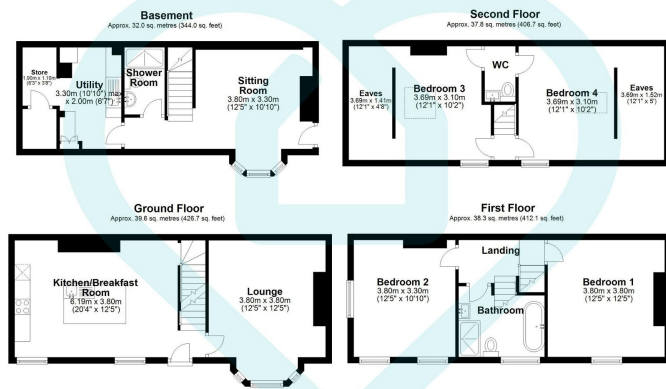

Total area: approx. 147.7 sq. metres (1589.5 sq. feet)

Whilst every attempt has been made to ensure the accuracy of the floor plan contained here, measurements of doors, windows, rooms and any other items are approximate and no responsibility is taken for any error, omission or mis-statement. This plan is for illustrative purposes only and should be used as such by any prospective tenant/purchaser.

Made with Metropix, we are morfittsmith

- Stunning Decor
- Gated Property
- Key Road Access
- Converted Cellar
- Immaculate Inside and Out
- Large Living Space
- A Drive for at Least 2 Cars
- The Outstanding Malin Bridge School a Short Walk Away
- Laundry Room
- Stunning Garden

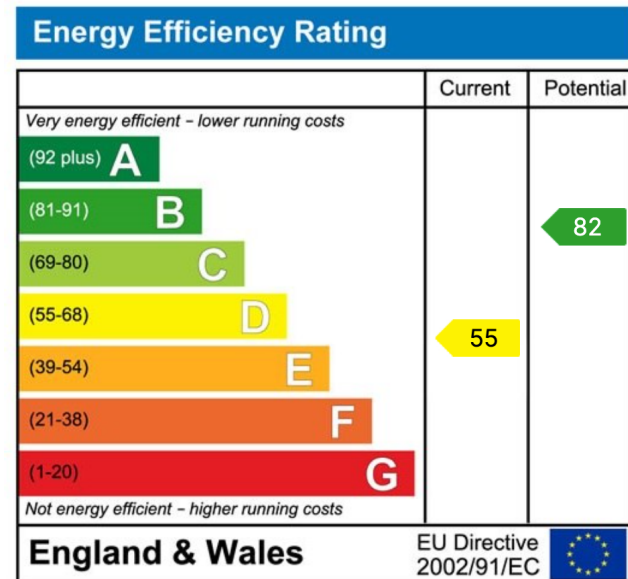

### Sales | Lettings | New Homes

VAT Reg Number: 191 3588 84  
Company Reg Number: 08610489  
Company Reg Address: 67 Middlewood Road, Hillsborough, Sheffield, S6 4GX.

The MorfittSmith Building  
67 Middlewood Road  
Hillsborough  
Sheffield  
S6 4GX

### Get in touch - arrange an appointment

0114 232 1764  
 sales@morfittsmith.co.uk  
lettings@morfittsmith.co.uk  
newhomes@morfittsmith.co.uk  
 www.morfittsmith.co.uk

@MorfittSmith  
 @MorfittSmith  
 MorfittSmith Estate & Letting Agent