



Grange Farm Drive, Worrall, Sheffield, S35 0BD

Offers In Region Of £365,000

3 1 1



Why We Love It

Grange Farm Drive, a gardeners dream. The current owner has an eye for detail when it comes to the presentation of green space, making this home a tranquil space inside and out. This home not only offers comfortable living spaces but also access to surrounding green spaces, providing opportunities for outdoor recreation and leisure.

Why You'll Love It

Upon arrival, you're welcomed by a hallway providing additional storage and w.c. From here, step into your main living/dining area, plenty of space for comfy seating for those cosy film nights or having a catch up with friends and family. Natural light floods the room, creating a warm and inviting atmosphere perfect for both relaxation and entertainment. The beauty of this space is that the kitchen is part open plan into this area making it a great sociable, family home. The kitchen area is well-sized and modern, equipped with all the essentials for culinary creativity. Overlooking the garden is the conservatory, the perfect place to sit and relax on those summer nights with the doors open and take in the quiet. Up to the first floor where you will find three generously sized bedrooms, each providing a peaceful retreat for rest and rejuvenation. Whether you're seeking a cosy haven for relaxation or a functional space for productivity, these bedrooms cater to your every need. A convenient three-piece walk in shower suite, offering modern amenities and functionality. Start your day with an invigorating shower or unwind in the evening with ease. Finishing off the floorplan of this property is the outside space. To the front of the property you benefit from parking for a couple of cars and a garage space perfect for storage or car. Finally the garden, an immaculately presented space with seating areas perfect for soaking up the sun while listening to the sound trickling of water from the pond. Come and escape the hustle and bustle of city life and embrace the tranquillity of Worrall. With its spacious interiors, picturesque surroundings, and convenient location, this three bed detached home offers the ideal retreat for modern living. Schedule a viewing today and discover the serenity and charm this property has to offer.



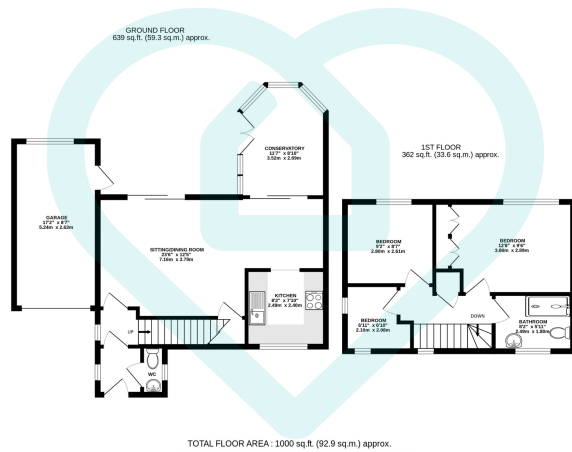

This floor plan is for illustrative purposes only. All measurements and layouts are approximations and do not necessarily capture the precise specifications of the property. No responsibility is taken for any error, omission, or misstatement. We always recommend viewing in person to confirm the exact floor plan of a property. Made with Metropix.



- Sought After Location
- Well Presented
- Substantial Living Space
- Garage
- Detached Property
- Stunning Rear Garden
- 3 Bedrooms
- Proximity to Green Space
- Close to Amenities
- Modern Kitchen

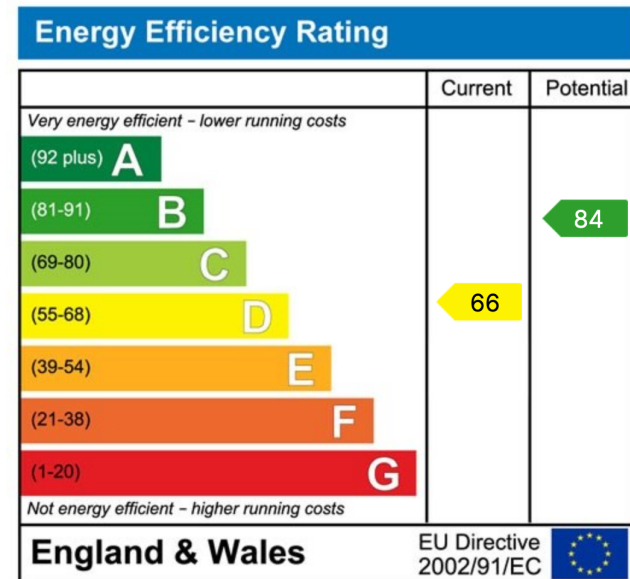

Sales | Lettings | New Homes

VAT Reg Number: 191 3588 84
 Company Reg Number: 08610489
 Company Reg Address: 67 Middlewood
 Road, Hillsborough, Sheffield, S6 4GX.

The MorfittSmith Building
 67 Middlewood Road
 Hillsborough
 Sheffield
 S6 4GX

Get in touch - arrange an appointment



0114 232 1764
 sales@morfittsmith.co.uk
 lettings@morfittsmith.co.uk
 newhomes@morfittsmith.co.uk
 www.morfittsmith.co.uk



@MorfittSmith
 @MorfittSmith
 MorfittSmith
 Estate & Letting Agent