



we are
morfittsmith

Laird Drive
Wisewood,
Sheffield,
S6 4BW



A beautiful, modern, and thoroughly quirky home in the beloved community of Wisewood: Laird Drive.

This decidedly unique four-bed has seen significant extension and improvement making it a very impressive family home.







Time to explore:

Wisewood has secured a very solid reputation and remains a wonderful place to raise a family. It rests just above Hillsborough to the north of Sheffield city centre. Surrounded by great entertainments, good schools, superb shopping and dining, it is a terrific place to call home. This affords it outstanding transport links into the city and across the region. The property itself has its own driveway giving you the opportunity to explore further out into the peaks too. Laird Drive offers you rear access to a private side yard, a lovely terrace deck for dining and entertaining, as well as a lovely lawned garden with flowerbeds.



Step inside your new home:

Having reaped the benefits of its thoughtful and thorough renovations and extensions, Laird Drive has now settled well into its new shape remaining a thoroughly unique and quirky home.

It offers a cosy living room with a bay window leading back to a long dining room and snug. The absolutely immaculate kitchen is a stunning modern space that is simply ideal for making a mess of with cakes and sweet treats. Upstairs the main bedroom has fitted storage and even a wardrobe space so large that it has evolved into a comfy private office. Bedroom two is an ample garden view double and the family bathroom is spotless. But the further extended top floor is where the biggest surprise is. Bedroom three has an outstanding view through its dormer window and even has its own en suite shower room. It is complemented by bedroom four affording this generous home all the space you could want for family life.





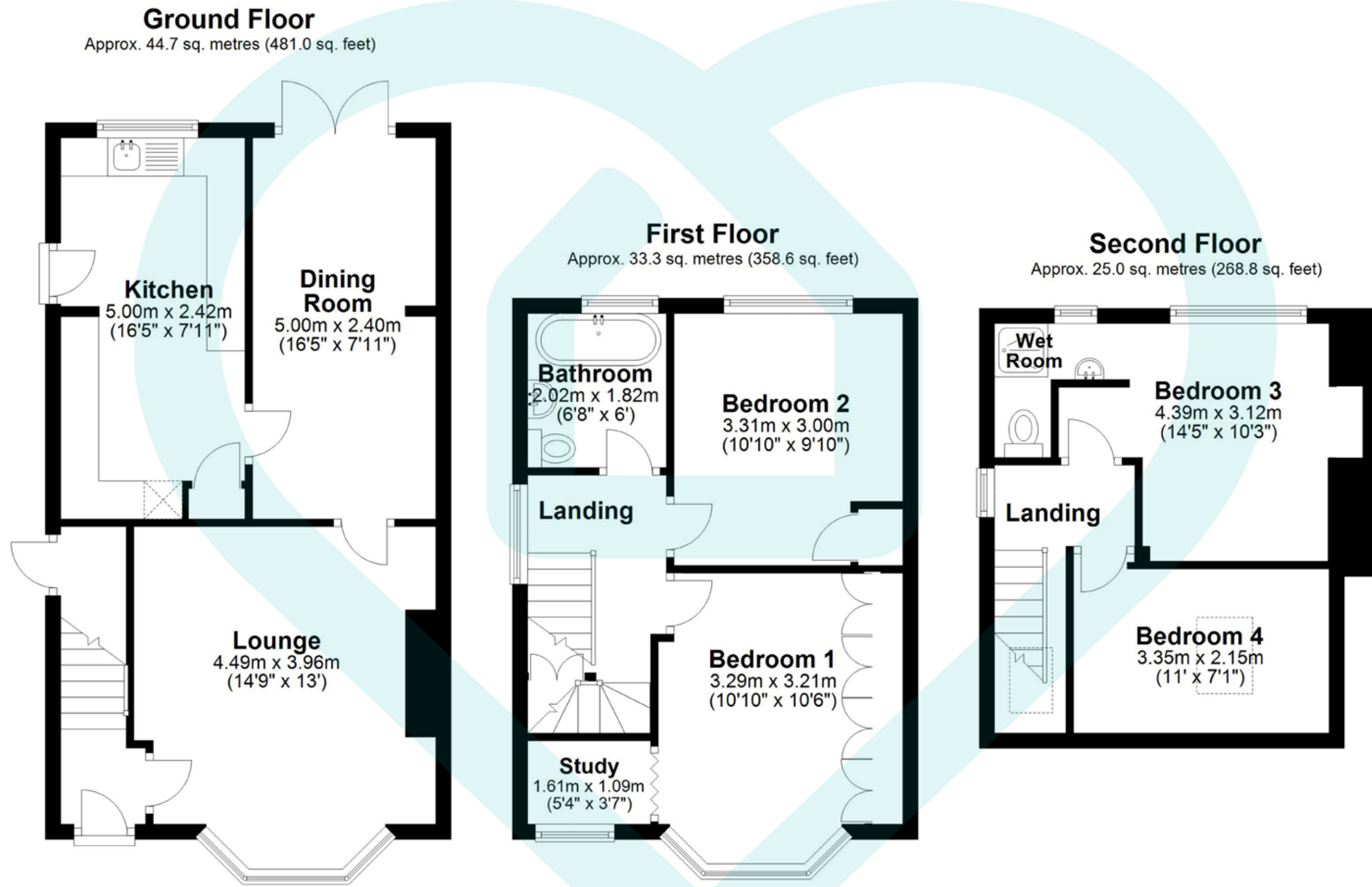

Total area: approx. 103.0 sq. metres (1108.4 sq. feet)

Score	Energy rating	Current	Potential
92+	A		
81-91	B		
69-80	C	69 c	80 c
55-68	D		
39-54	E		
21-38	F		
1-20	G		

Whilst every attempt has been made to ensure the accuracy of the floor plan contained here, measurements of doors, windows, rooms and any other items are approximate and no responsibility is taken for any error, omission or mis-statement. This plan is for illustrative purposes only and should be used as such by any prospective tenant/ purchaser.

IMPORTANT: we would like to inform prospective purchasers that these sales particulars have been prepared as a general guide only, A detailed survey has not been carried out, nor the services, appliances and fittings tested. Room sizes should not be relied upon for furnishing purposes and are approximate. If floor plans are included, they are for guidance only and illustration purposes only and may not be to scale. If there are any important matters likely to affect your decision to buy, please contact us before viewing the property.







The MorfittSmith Building,
67 Middlewood Road,
Sheffield, S6 4GX



0114 232 1764



www.morfittsmith.co.uk



sales@morfittsmith.co.uk



lettings@morfittsmith.co.uk



newhomes@morfittsmith.co.uk



@morfittsmith



@morfittsmith



MorfittSmith Estate & Letting Agent



morfittsmith



sales | lettings | new homes