



Thorpelands Drive  
Allestree Derby



### Property Description

Charming 2-Bedroom Mid-Terrace Bungalow in Allestree in a retirement scheme for over 55's

The property boasts a welcoming lounge, perfect for relaxing or entertaining, and a bright sunroom that allows you to enjoy the garden views all year round. The kitchen is well-appointed with ample storage and workspace, and the bathroom is modern and functional.

The two bedrooms are well-proportioned, offering versatility for those needing guest space, a home office, or extra storage. Outside can be found allocated an parking space as well as a front and rear garden.

Located in Allestree, you'll have the best of both worlds - a tranquil residential area with easy access to local amenities, including parks, schools, and shops. For those commuting or seeking to explore the wider area, excellent public transport links are within easy reach, with regular bus services to Derby city centre and surrounding areas. Major road networks are also nearby.

Don't miss out on this rare opportunity to enjoy bungalow living in a prime location.

## Entrance Hallway

## Lounge

15' x 11' 8" ( 4.57m x 3.56m )

## Sun Room

## Kitchen

8' 9" x 7' 10" ( 2.67m x 2.39m )

## Bedroom One

12' 8" max x 9' 11" ( 3.86m max x 3.02m )

## Bedroom Two

11' 7" x 6' 4" ( 3.53m x 1.93m )

## Bathroom

## Exterior

Allocated parking space, front and rear garden.







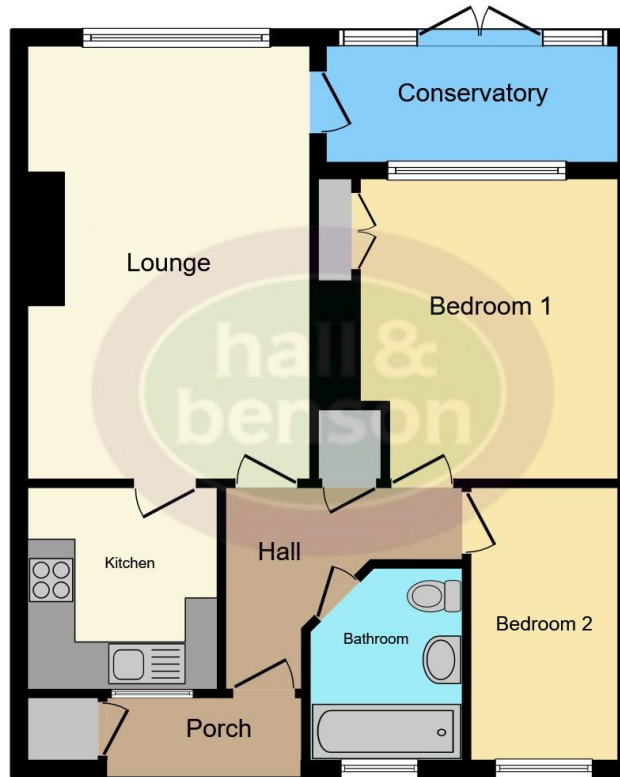

This floor plan is for illustrative purposes only. It is not drawn to scale. Any measurements, floor areas (including any total floor area), openings and orientation are approximate. No details are guaranteed, they cannot be relied upon for any purpose and they do not form part of any agreement. No liability is taken for any error, omission or misstatement. A party must rely upon its own inspection(s). Powered by [www.focalagent.com](http://www.focalagent.com)

To view this property please contact Hall & Benson on

**T 01332 555 945**  
**E [allestree@hallandbenson.co.uk](mailto:allestree@hallandbenson.co.uk)**

E7 Park Farm Centre Park Farm Drive  
DERBY DE22 2QQ

**EPC Rating: C**

**view this property online [hallandbenson.co.uk/Property/ATR102033](http://hallandbenson.co.uk/Property/ATR102033)**

This is a Leasehold property with details as follows; Term of Lease 99 years from 29 May 2018. Should you require further information please contact the branch. Please Note additional fees could be incurred for items such as

1. MONEY LAUNDERING REGULATIONS Intending purchasers will be asked to produce identification documentation at a later stage and we would ask for your co-operation in order that there will be no delay in agreeing the sale. 2. These particulars do not constitute part or all of an offer or contract. 3. The measurements indicated are supplied for guidance only and as such must be considered incorrect. Potential buyers are advised to recheck measurements before committing to any expense. 4. We have not tested any apparatus, equipment, fixtures, fittings or services and it is in the buyers interest to check the working condition of any appliances.

Hall & Benson is a trading name of Connells Residential which is registered in England and Wales under company number 1489613, Registered Office is Cumbria House, 16-20 Hockliffe Street, Leighton Buzzard, Bedfordshire, LU7 1GN. VAT Registration Number is 500 2481 05.

**See all our properties at [www.hallandbenson.co.uk](http://www.hallandbenson.co.uk) | [www.rightmove.co.uk](http://www.rightmove.co.uk) | [www.zoopla.co.uk](http://www.zoopla.co.uk)**



Property Ref: ATR102033 - 0004