



Cheviot Street  
Derby



### Property Description

We are pleased to market this semi-detached property in the highly sort after area of Derby. The ground floor consists of an entrance hallway, lounge, kitchen, and bathroom, with an adjoining lean to leading into the garden. The first floor consists of three bedrooms. The exterior offers a driveway and side access into the garden with patio area. An internal viewing is highly advised.

### Hallway

### Lounge

12' 9" x 12' 1" (3.89m x 3.68m)

Laminate flooring, one radiator with a UPVC double glazed window to the front elevation of the property.

### Kitchen

9' 5" x 12' 7" (2.87m x 3.84m)

Lino flooring. One radiator, wall and base units, window and glass door to rear elevation offering access to the lean to.

### Lean To

To rear elevation with carpeted flooring and access to rear garden.

### Bathroom

Laminate flooring. Three-piece suite, one radiator, UPVC double glazed window to rear.



## Landing

### Bedroom One

12' 7" x 12' 1" (3.84m x 3.68m)

Carpeted flooring. UPVC double glazed window to front elevation, one radiator.

### Bedroom Two

9' 5" x 8' 8" (2.87m x 2.64m)

Carpeted flooring. UPVC double glazed window to rear elevation with a built-in cupboard and one radiator.

### Bedroom Three

6' 2" x 8' 8" (1.88m x 2.64m)

Carpeted flooring. UPVC double glazed window to rear elevation with one radiator.

## Outside

To the rear elevation the garden offers a patio area, flat lawn, and wooden shed.

## Kitchen

9' 5" x 12' 7" (2.87m x 3.84m)

Lino flooring. One radiator, wall and base units, window and glass door to rear elevation offering access to the lean to.







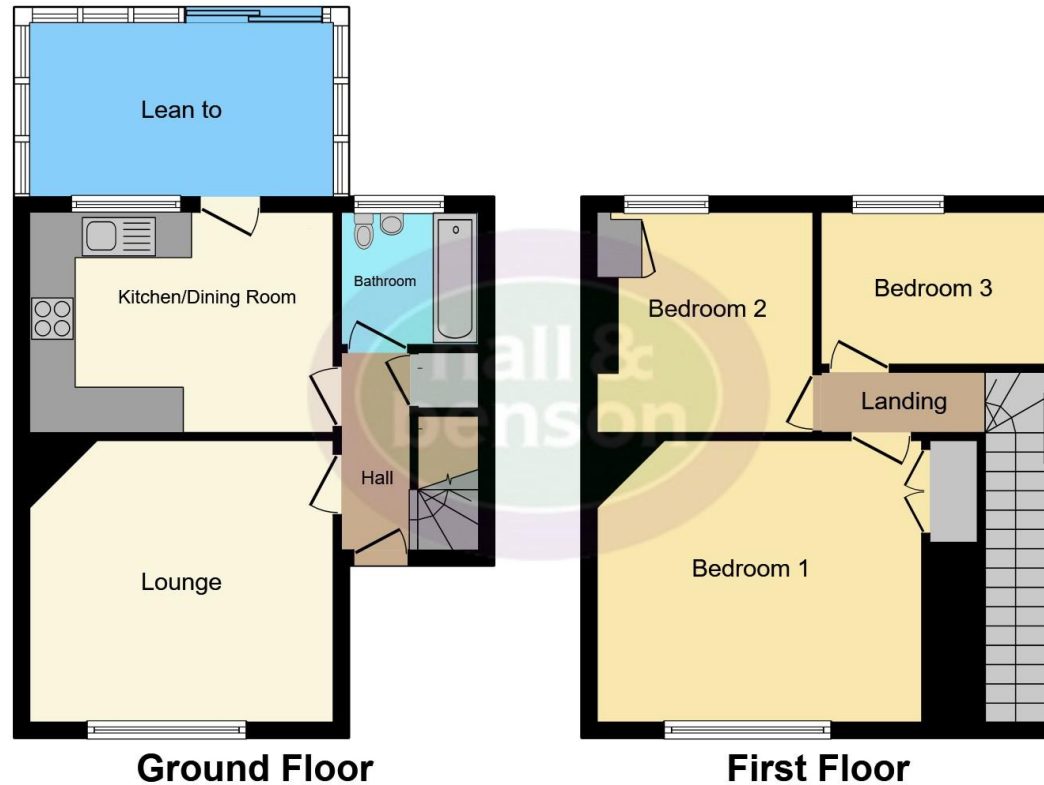

This floor plan is for illustrative purposes only. It is not drawn to scale. Any measurements, floor areas (including any total floor area), openings and orientation are approximate. No details are guaranteed, they cannot be relied upon for any purpose and they do not form part of any agreement. No liability is taken for any error, omission or misstatement. A party must rely upon its own inspection(s). Powered by [www.focalagent.com](http://www.focalagent.com)

To view this property please contact Hall & Benson on

**T 01332 555 945**  
**E [allestree@hallandbenson.co.uk](mailto:allestree@hallandbenson.co.uk)**

E7 Park Farm Centre Park Farm Drive  
 DERBY DE22 2QQ

**EPC Rating: D**

**[check out more properties at hallandbenson.co.uk](http://hallandbenson.co.uk)**



1. MONEY LAUNDERING REGULATIONS Intending purchasers will be asked to produce identification documentation at a later stage and we would ask for your co-operation in order that there will be no delay in agreeing the sale. 2. These particulars do not constitute part or all of an offer or contract. 3. The measurements indicated are supplied for guidance only and as such must be considered incorrect. Potential buyers are advised to recheck measurements before committing to any expense. 4. We have not tested any apparatus, equipment, fixtures, fittings or services and it is in the buyers interest to check the working condition of any appliances.

Hall & Benson is a trading name of Connells Residential which is registered in England and Wales under company number 1489613, Registered Office is Cumbria House, 16-20 Hockliffe Street, Leighton Buzzard, Bedfordshire, LU7 1GN. VAT Registration Number is 500 2481 05.

**See all our properties at [www.hallandbenson.co.uk](http://www.hallandbenson.co.uk) | [www.rightmove.co.uk](http://www.rightmove.co.uk) | [www.zoopla.co.uk](http://www.zoopla.co.uk)**

Property Ref: ATR101989 - 0003