



BRITISH  
PROPERTY  
AWARDS

2018



GOLD WINNER

ESTATE AGENT  
IN STAMFORD

nest  
ESTATES

**Rosamundi, Little Casterton**

Stamford, PE9 4BE

**£435,000**

## SUMMARY

- Three Bedroom Detached Bungalow
- Garage & Off Road Parking
- Walled Garden Area
- Living / Dining Space
- Shower Room & En Suite
- Kitchen Breakfast Room & Utility Room
- Idyllic Village Location
- Over 1300 Sq Ft





Rosamundi, a three bedroom detached bungalow with just over 1300 Sq Ft (approx) of accommodation, set down a quiet lane in the idyllic village of Little Casterton. The property comprises; Entrance Hall, Living / Dining Room, Shower Room, Kitchen Breakfast Room, Utility Room, Three well proportioned bedrooms, En Suite Shower Room To Master, Garage, Off Road Parking, Walled Garden Area and situated only a very short drive away from Stamford's town centre.

Charming Village Living in Little Casterton – A Tranquil Retreat Minutes from Stamford Nestled amidst the rolling Rutland countryside, Little Casterton is a picturesque and peaceful village offering an idyllic rural lifestyle with the benefit of being just a short drive from the historic Georgian market town of Stamford. Known for its characterful stone-built homes and friendly community atmosphere, Little Casterton is perfect for those seeking a quieter pace of life without compromising on convenience.



Surrounded by scenic walks, open fields, and timeless English charm, the village retains a traditional feel, with properties enjoying generous plots and uninterrupted views. Its enviable location places Stamford—just over 1 mile away—within easy reach. This vibrant town boasts a wealth of independent shops, fine dining, excellent schools, and a train station with direct links to Peterborough and beyond, making it a prime spot for commuters and families alike. Little Casterton offers the best of both worlds: the peace and beauty of countryside living with the culture, amenities, and connectivity of Stamford close at hand.











Tenure: Freehold

EPC Rating: TBC

Local Authority: Rutland Council

Services: Oil Fired Central Heating

## DISCLAIMER

Money Laundering Regulation: People who intend to purchase will be asked to show us documents to prove their identity. This will allow us to agree the sale and move forward with your purchase as quickly as possible. 2. We do our best to make sure our sales particulars are as accurate and reliable as we can. However, they are a general guide to the property and if something is particularly important to you, we will be happy to check information for you. As regards measurements, the approximate room sizes are intended as a general guide. You must verify dimensions of rooms yourself before ordering any carpets or furniture. 3. As regards services, we have not tested the services or any equipment including appliances in this property. We advise prospective buyers to carry out their own survey, service report before making their final offer to purchase. 4. This sales information has been issued in good faith. However, it does not constitute representation of fact or form part of any offer or contract. The information referred to in these particulars should be independently verified by any prospective buyer or tenant. Neither Nest Estates nor any of its employees has the authority to make or give any representation or warranty whatever in relation to this property.

**Ground Floor**  
Approx. 123.7 sq. metres (1331.1 sq. feet)

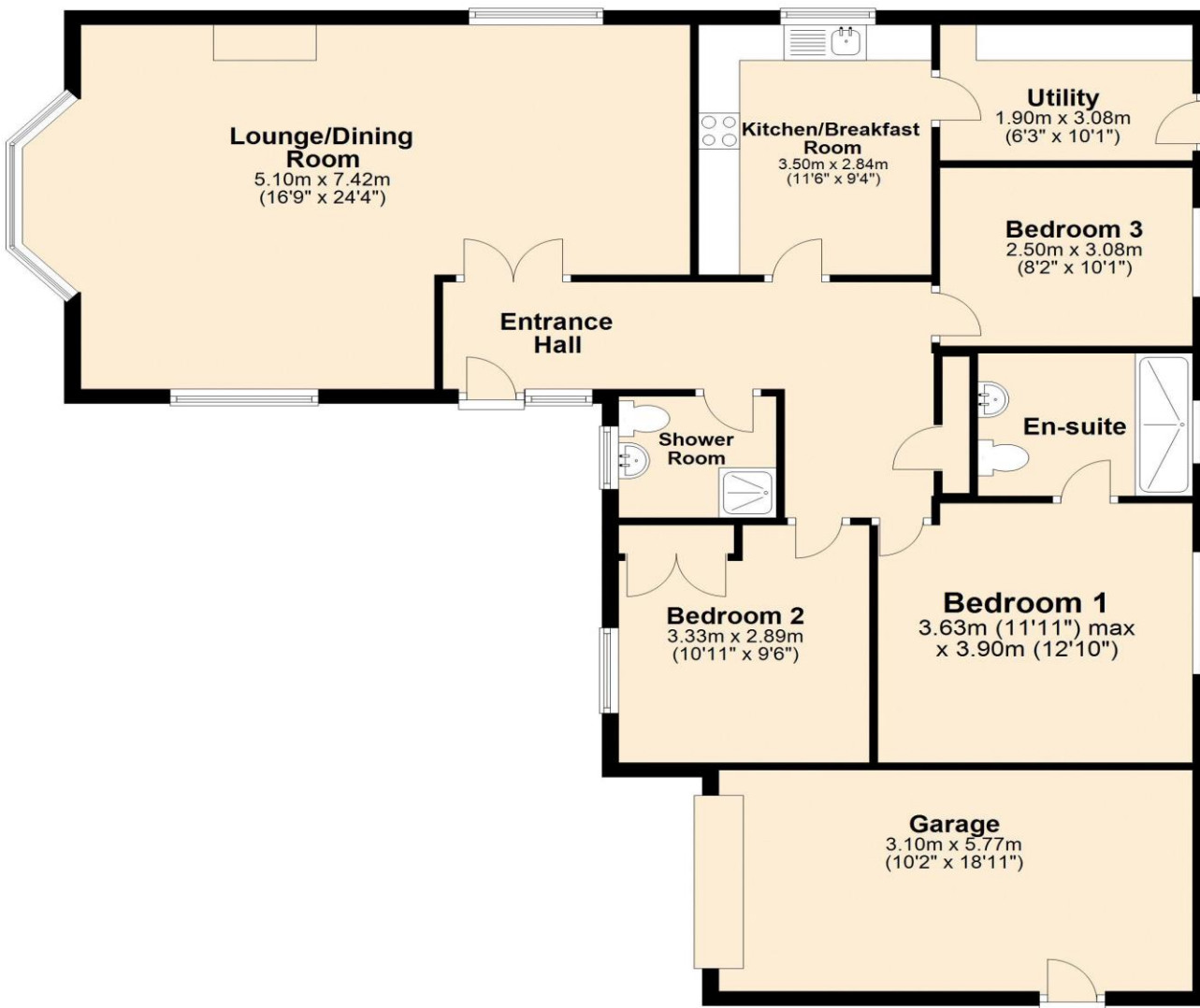

Total area: approx. 123.7 sq. metres (1331.1 sq. feet)

**nest**  
ESTATES

8-9 Red Lion Street Stamford Lincolnshire PE9 1PA

01780 238110

[info@nestestates.co.uk](mailto:info@nestestates.co.uk)

[www.nestestates.co.uk](http://www.nestestates.co.uk)