



BRITISH  
PROPERTY  
AWARDS

2018



GOLD WINNER

ESTATE AGENT  
IN STAMFORD

nest  
ESTATES



**Wharf Road,**  
Stamford, PE9 2EB  
**Offers in Excess of £230,000**



# SUMMARY

- 3 bedroom Stone Terrace Cottage
- Close to town
- Generous lawned garden
- Extended to the rear
- 2 Reception rooms
- Lots of potential
- 
- 







**\*\*\*NO CHAIN\*\*TOWN LOCATION WITH HUGE POTENTIAL & ORIGINAL FEATURES\*\*** Unique opportunity for an extended, three bedroom character property with a generous garden only a 2 minute from Stamford town centre. Ideally positioned on Wharf Road allowing easy access into town and to the A1. Accommodation briefly comprises of an entrance hall through to lounge with feature fireplace, dining room with the potential to be converted into an open plan living/dining room, kitchen, pantry, three-piece family bathroom. The first floor offers a master bedroom, a double bedroom and a further third bedroom. Externally the property benefits from a generous laid to lawn garden. The historic market town of Stamford with from many shops, garden centres, churches, public houses and hotels to be found, along with indoor swimming pool, leisure centre and good medical facilities. Other recreational amenities in the area include several golf courses, Burghley House and Rutland Water between Stamford and Oakham for fishing, sailing and other pursuits. Not only benefiting from excellent primary & secondary schools near by, education in the town is exceptional, provided by the renowned Stamford Endowed Schools. Additional state and independent schooling can be found in nearby market towns such as Bourne, Market Deeping and Oakham. High speed trains from Peterborough (only 15 miles away) to London Kings Cross take approximately 46 minutes; ideal for the commuter. The A1 road is only 1 mile away.



Tenure:

EPC Rating: **D**

Council Tax Band: **B**

Local Authority:

Services:

## DISCLAIMER

Money Laundering Regulation: People who intend to purchase will be asked to show us documents to prove their identity. This will allow us to agree the sale and move forward with your purchase as quickly as possible. 2. We do our best to make sure our sales particulars are as accurate and reliable as we can. However, they are a general guide to the property and if something is particularly important to you, we will be happy to check information for you. As regards measurements, the approximate room sizes are intended as a general guide. You must verify dimensions of rooms yourself before ordering any carpets or furniture. 3. As regards services, we have not tested the services or any equipment including appliances in this property. We advise prospective buyers to carry out their own survey, service report before making their final offer to purchase. 4. This sales information has been issued in good faith. However, it does not constitute representation of fact or form part of any offer or contract. The information referred to in these particulars should be independently verified by any prospective buyer or tenant. Neither Nest Estates nor any of its employees has the authority to make or give any representation or warranty whatever in relation to this property.

**Ground Floor**  
Approx. 50.6 sq. metres (544.7 sq. feet)

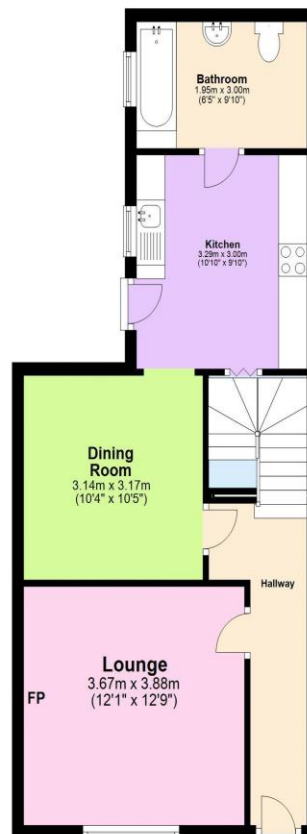

**First Floor**  
Approx. 34.7 sq. metres (373.4 sq. feet)

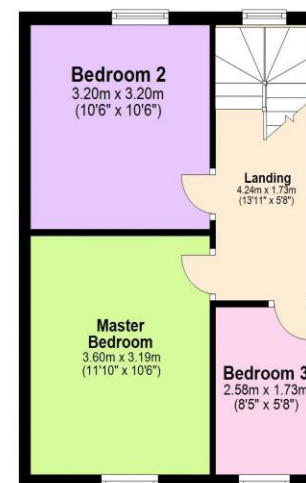

Total area: approx. 85.3 sq. metres (918.1 sq. feet)

1. Money Laundering Regulations.....People who intend to purchase will be asked to show us documents to prove their identity. This will allow us to agree the sale and move forward with your purchase as quickly as possible.
2. We do our best to make sure our sales particulars are as accurate and reliable as we can. However, they are a general guide to the property and if something is particularly important to you, we will be happy to check information for you. As regards measurements, the approximate room sizes are intended as a general guide. You must verify dimensions of rooms yourself before ordering any carpets or furniture.
3. As regards services, we have not tested the services or any equipment including appliances in this property. We advise prospective buyers to carry out their own survey, service report before making their final offer to purchase.
4. This sales information has been issued in good faith. However, it does not constitute representation of fact or form part of any offer or contract. The information referred to in these particulars should be independently verified by any prospective buyer or tenant. Neither Nest Estates nor any of its employees has the authority to make or give any representation or warranty whatever in relation to this property.  
Plan produced using PlanUp.

**nest**  
ESTATES

8-9 Red Lion Street Stamford Lincolnshire PE9 1PA

01780 238110

info@nestestates.co.uk

www.nestestates.co.uk