



BRITISH
PROPERTY
AWARDS

2018



GOLD WINNER

ESTATE AGENT
IN STAMFORD



nest
ESTATES

Glen Close, Little Bytham

Grantham, NG33 4PS

Offers in Excess of £260,000

SUMMARY

- Landscaped Tiered Rear Garden
- Field Views To The Front Of The Property
- Detached Double Garage
- Kitchen
- Living Room
- Three Bedroom Family Home
- Bathroom
- Idyllic Village Location





*** SENSATIONAL TIERED REAR GARDEN ***
 DETACHED DOUBLE GARAGE *** Three bedroom family home, set in an idyllic village location, briefly comprising; Kitchen, Living Room, Bathroom, Three well proportioned bedrooms, Detached Double Garage, Field views to the front & Landscaped Rear Garden. 1. Money Laundering Regulations.....People who intend to purchase will be asked to show us documents to prove their identity. This will allow us to agree the sale and move forward with your purchase as quickly as possible. 2. We do our best to make sure our sales particulars are as accurate and reliable as we can. However, they are a general guide to the property and if something is particularly important to you, we will be happy to check information for you. As regards measurements, the approximate room sizes are intended as a general guide. You must verify dimensions of rooms yourself before ordering any carpets or furniture. 3. As regards services, we have not tested the services or any equipment including appliances in this property. We advise prospective buyers to carry out their own survey, service report before making their final offer to purchase. 4. This sales information has been issued in good faith. However, it does not constitute representation of fact or form part of any offer or contract. The information referred to in these particulars should be independently verified by any prospective buyer or tenant. Neither Nest Estates nor any of its employees has the authority to make or give any representation or warranty whatever in relation to this property.



Tenure:

EPC Rating:

Council Tax Band: **A**

Local Authority:

Services:

DISCLAIMER

Money Laundering Regulation: People who intend to purchase will be asked to show us documents to prove their identity. This will allow us to agree the sale and move forward with your purchase as quickly as possible. 2. We do our best to make sure our sales particulars are as accurate and reliable as we can. However, they are a general guide to the property and if something is particularly important to you, we will be happy to check information for you. As regards measurements, the approximate room sizes are intended as a general guide. You must verify dimensions of rooms yourself before ordering any carpets or furniture. 3. As regards services, we have not tested the services or any equipment including appliances in this property. We advise prospective buyers to carry out their own survey, service report before making their final offer to purchase. 4. This sales information has been issued in good faith. However, it does not constitute representation of fact or form part of any offer or contract. The information referred to in these particulars should be independently verified by any prospective buyer or tenant. Neither Nest Estates nor any of its employees has the authority to make or give any representation or warranty whatever in relation to this property.

Ground Floor

Approx. 73.5 sq. metres (790.7 sq. feet)

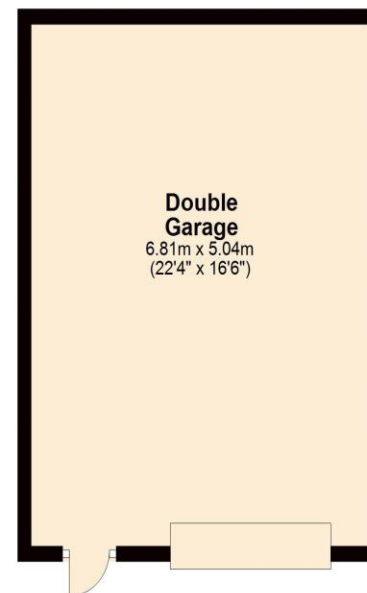
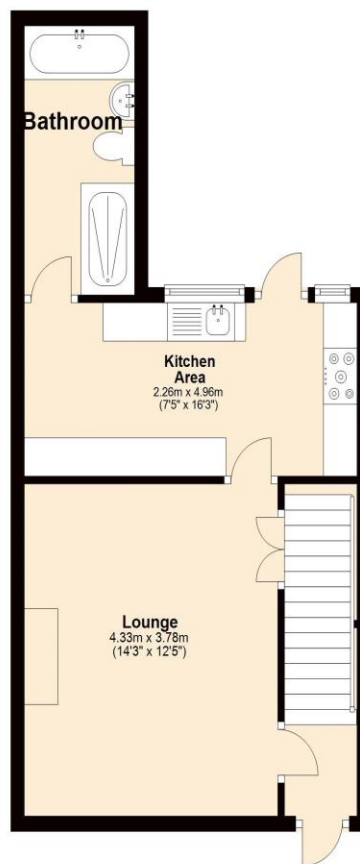

First Floor

Approx. 34.2 sq. metres (368.1 sq. feet)

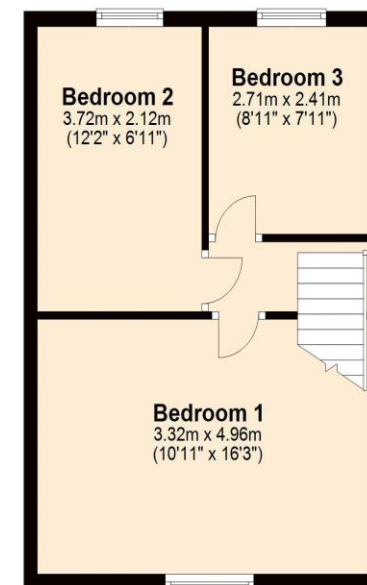

Total area: approx. 107.7 sq. metres (1158.8 sq. feet)

nest
ESTATES

8-9 Red Lion Street Stamford Lincolnshire PE9 1PA

01780 238110

info@nestestates.co.uk

www.nestestates.co.uk