



**Price**  
**£460,000**

**Freehold**

3x  1x  1x 

**Nutley Crescent,  
Goring-By-Sea,  
Worthing, West Sussex,  
BN12**

**OVER 60?**

Secure this property  
for up to **59% less!**

**cubitt&west**  
Helping you move forwards





## Main features

- Well presented property in a very sought after area
- Within close proximity to the pretty Goring seafront
- Light and spacious rooms
- Excellent transport links nearby
- Local amenities including shops, cafes and restaurants within walking distance

## Accommodation

### GROUND FLOOR

#### Hallway

Lounge: 14'2 x 14'0 (4.32m x 4.27m)

Kitchen : 14'0 x 10'6 (4.27m x 3.20m)

Conservatory: 9'7 x 9'5 (2.92m x 2.87m)

#### Bathroom

Bedroom 1: 13'0 x 12'2 (3.97m x 3.71m)

Bedroom 2: 9'9 x 9'5 (2.97m x 2.87m)

Bedroom 3: 11'1 x 8'0 (3.38m x 2.44m)

### OUTSIDE

Front & Rear Gardens

Driveway & Garage

**Ground Floor**  
Approx. 99.0 sq. metres (1065.3 sq. feet)

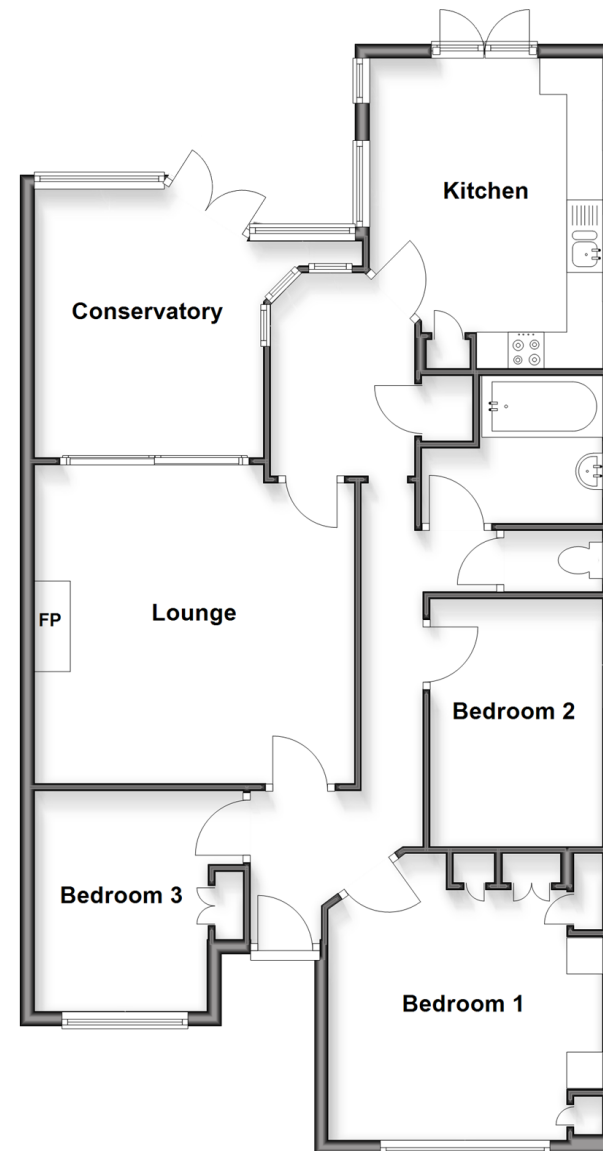

**Call West Worthing - 01903 700657 ■ cubittandwest.co.uk**

- A private rental licensing scheme applies to some properties in this area, please contact us before proceeding
- Legal advice should be taken to verify fixtures/fittings, planning, alterations and/or lease details
- Appliances & services are untested, dimensions are approximate and floor plans are not to scale
- Through a Homewise Home For Life Plan people aged 60+ can secure this property for up to 59% less, by purchasing a Lifetime Lease.

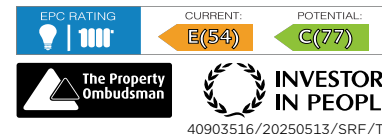

40903516/20250513/SRF/TD