



OVER 60?

Secure this property
for up to **59% less!**

Price

£160,000

Leasehold

2x  1x  1x 

**Downs Close,
Waterlooville,
Hampshire, PO7**

cubitt&west
Helping you move forwards



Main features

- Ground floor flat with allocated parking
- An ideal property for first time buyers or investors
- Communal gardens
- Close to local amenities and transport links
- Offered with no forward chain

Accommodation

GROUND FLOOR

Entrance Hall

Lounge: 18'5 x 10'3 (5.62m x 3.13m)

Kitchen: 8'3 x 7'9 (2.52m x 2.36m)

Bedroom 1: 13'1 x 8'5 (3.99m x 2.57m)

Bedroom 2: 11'0 x 5'9 (3.36m x 1.75m)

Bathroom

OUTSIDE

Allocated Parking Space

Communal Gardens

Ground Floor

Approx. 52.7 sq. metres (567.3 sq. feet)

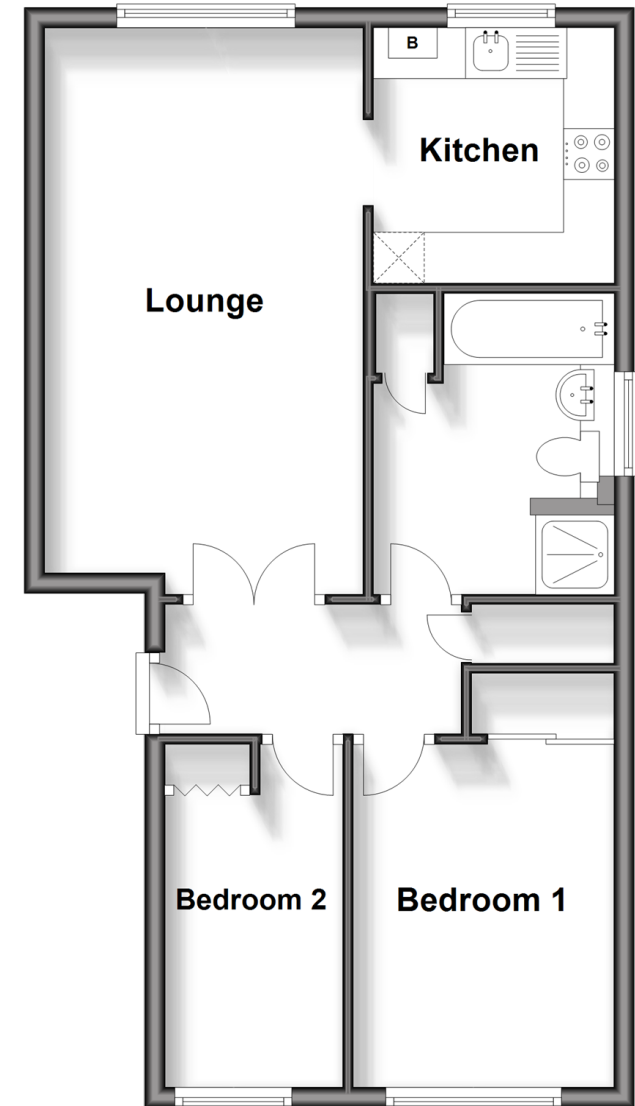

Call WaterlooVille - 02392 267244 ■ cubittandwest.co.uk

- Legal advice should be taken to verify fixtures/fittings, planning, alterations and/or lease details
- Appliances & services are untested, dimensions are approximate and floor plans are not to scale
- Through a Homewise Home For Life Plan people aged 60+ can secure this property for up to 59% less, by purchasing a Lifetime Lease.



42409879/20250122/EH/EC