



RESIDE
—
MANCHESTER



616 12 Leftbank
Spinningfields, Manchester, M3 3AG

Asking Price £280,000



616 12 Leftbank
Spinningfields, Manchester, M3 3AG

An incredibly large one-bedroom apartment, covering 830 square feet, situated in Leftbank—one of the most sought-after developments in the heart of Spinningfields.

Located on the 6th floor, the property boasts an open-plan living and kitchen area, a generously sized paved balcony with stunning riverside views, a double bedroom complete with a fitted wardrobe, and a recently refurbished bathroom.

The apartment also includes a tandem parking space (accommodating two cars) and benefits from a 24-hour concierge service.

MORTGAGE BUYERS WELCOME, full funding from Developer in place.

The Tour
This well-presented one-bedroom apartment is located on the sixth floor of 12 Leftbank. Upon entering, a spacious hallway with wooden flooring leads to three storage cupboards, along with a utility cupboard off the bathroom that houses the washer-dryer.

The lounge and kitchen are designed as separate spaces, creating a practical layout. The kitchen, tucked into its own corner, includes modern appliances such as a Baumatic oven, hob, and micro-oven. Tiled flooring, wooden units, and a glass splashback complete the functional yet stylish design.

The lounge is bright and inviting, thanks to large floor-to-ceiling windows that open onto a paved balcony with riverside views.

The double bedroom is generously sized, featuring built-in wardrobes, carpeted flooring, and access to the balcony through floor-to-ceiling windows. A vertical radiator provides warmth and a contemporary feel.

The bathroom has been recently refurbished, featuring a large bath, modern back-to-wall toilet, sleek sink basin, matt black fixture and fittings and a heated towel rail.





The Area

Spinningfields is a modern and vibrant area located along the banks of the River Irwell. The area has transformed from an industrial area into a thriving business, retail, and residential district.

The property benefits from being an 1-minute walk away from the popular Hardman Square, where you will find shops & popular restaurants like The Ivy, The Alchemist, M&S, Pret a Manger & 20 Stories to name a few, while PureGym is also located close by.

It is only a short walk away from Manchester City Centre, where you have access to the transport links along Deansgate. Additionally, Salford Central Train Station is only a short walk away.

Lease Information

Length of Lease - 155 years from 2001. 131 years remaining.

Service Charge - £3,596.28 per annum - includes car park service charge and buildings insurance.

Ground Rent - £150 per annum.

- Large Double Bedroom
- Spacious Balcony With Riverside Views
- Tandem Parking Included
- Renovated Bathroom
- 24 Hour Concierge
- No Chain
- 830 Sq Ft
- Located in Heart of Spinningfields
- Open Plan Living/Kitchen Area
- Sought After Development

Floor Plan

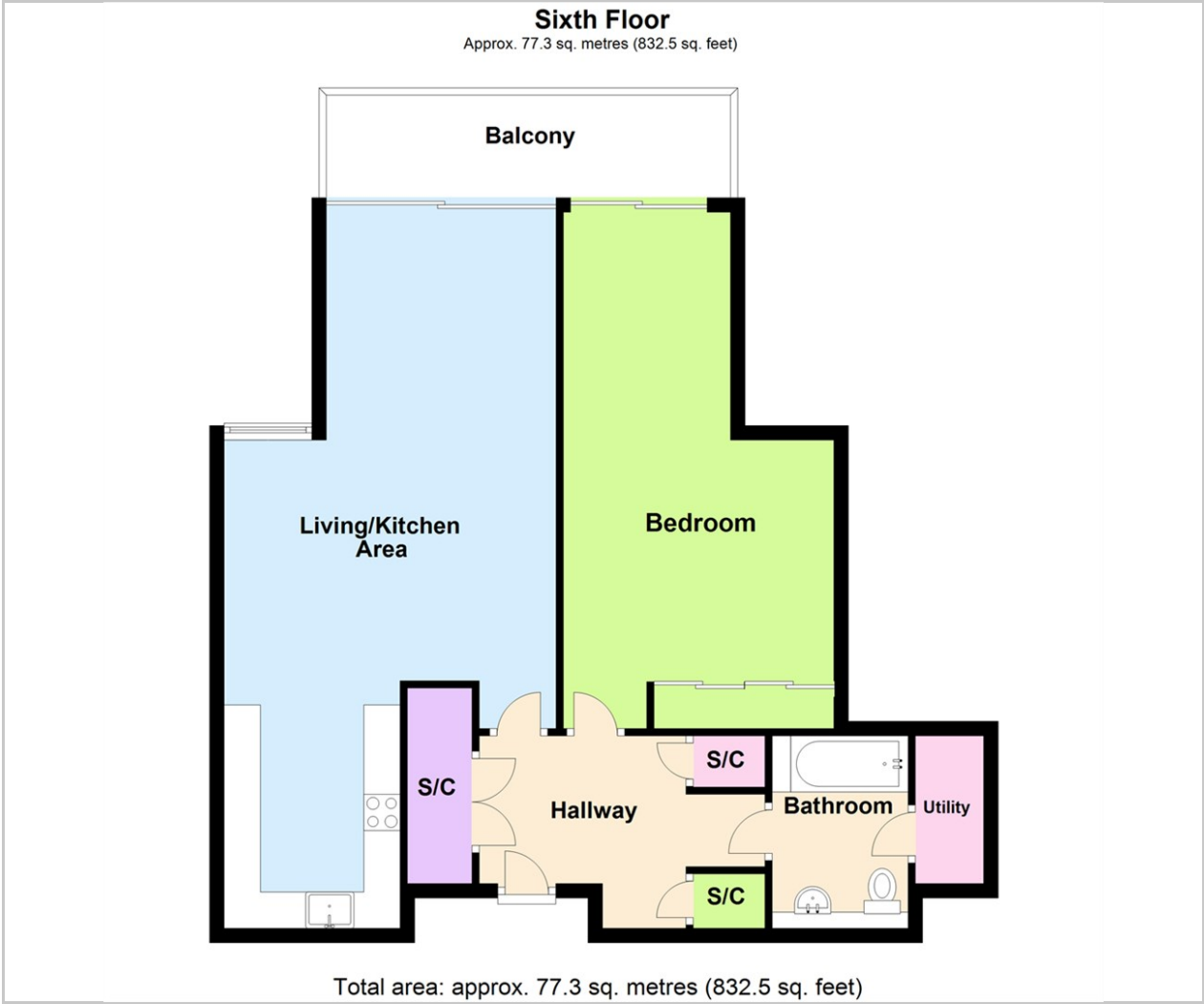

Viewing

Please contact our Reside Manchester Office on 0161 837 2840 if you wish to arrange a viewing appointment for this property or require further information.

These particulars, whilst believed to be accurate are set out as a general outline only for guidance and do not constitute any part of an offer or contract. Intending purchasers should not rely on them as statements of representation of fact, but must satisfy themselves by inspection or otherwise as to their accuracy. No person in this firms employment has the authority to make or give any representation or warranty in respect of the property.

Area Map

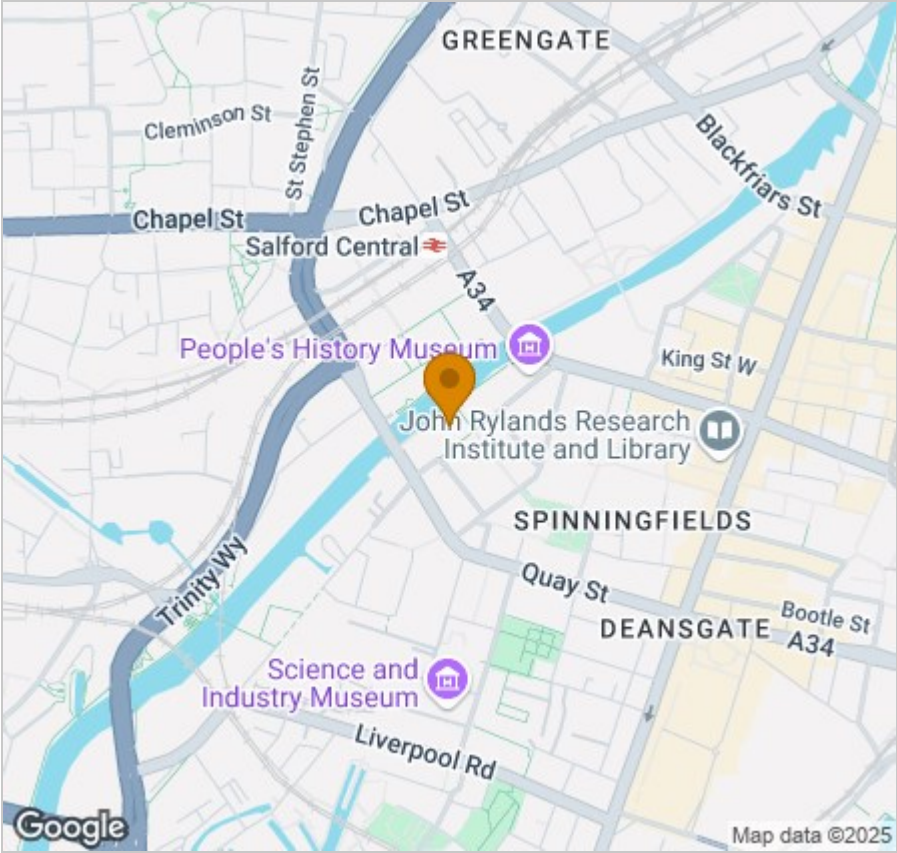

Energy Efficiency Graph

