



RESIDE
—
MANCHESTER



42 The Chambers 2-6 Booth Street
Manchester, M2 4AT

Asking Price £415,000

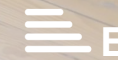

42 The Chambers, Booth St

Manchester, M2 4AT

The Chambers is located right in the very heart of Manchester City Centre on Booth Street, just off Albert Square with views of the Square and Town Hall Spire. Originally converted into apartments around 2000, the building dates back to around 1872 and still remains one of the finest addresses in the City. The development comprises of only 16 individual apartments. Apartment 42 is circa 969 sqft internally and is on the 4th and top floor of the development.

The Development

The Chambers is located right in the very heart of Manchester City Centre on Booth Street, just off Albert Square with views of the Square and Town Hall Spire. Originally converted into apartments around 2000, the building dates back to around 1872 and still remains one of the finest addresses in the City. The development comprises of only 16 individual apartments. Apartment 42 is circa 969 sqft internally and is on the 4th and top floor of the development.

Reception

The open plan lounge and kitchen benefit from restored pine flooring and double glazed sash windows with views of central Manchester. The maple style wooden kitchen units with dark green granite work surfaces and splashback are complemented by Bosch oven and microwave with integrated Baumatic dishwasher. The kitchen benefits from a velux skylight.

Bedrooms

The hallway and bedrooms are fully carpeted with double glazed sash windows. The apartment benefits from individual thermostatically controlled electric panel radiators throughout.

Bathrooms





The bathroom has a white three piece suite with shower over the bath and is fully tiled to bath area. The ensuite is fitted with a white three piece suite with full tiling to shower and sink areas.

- Grade II Listed Building
- Two Double Bedrooms
- Two Bathrooms
- Top Floor
- Original Features
- EPC rating E
- Circa 969 sqft
- Central Location
- No Chain
- Designed In 1872, Converted in 2000



Floor Plan

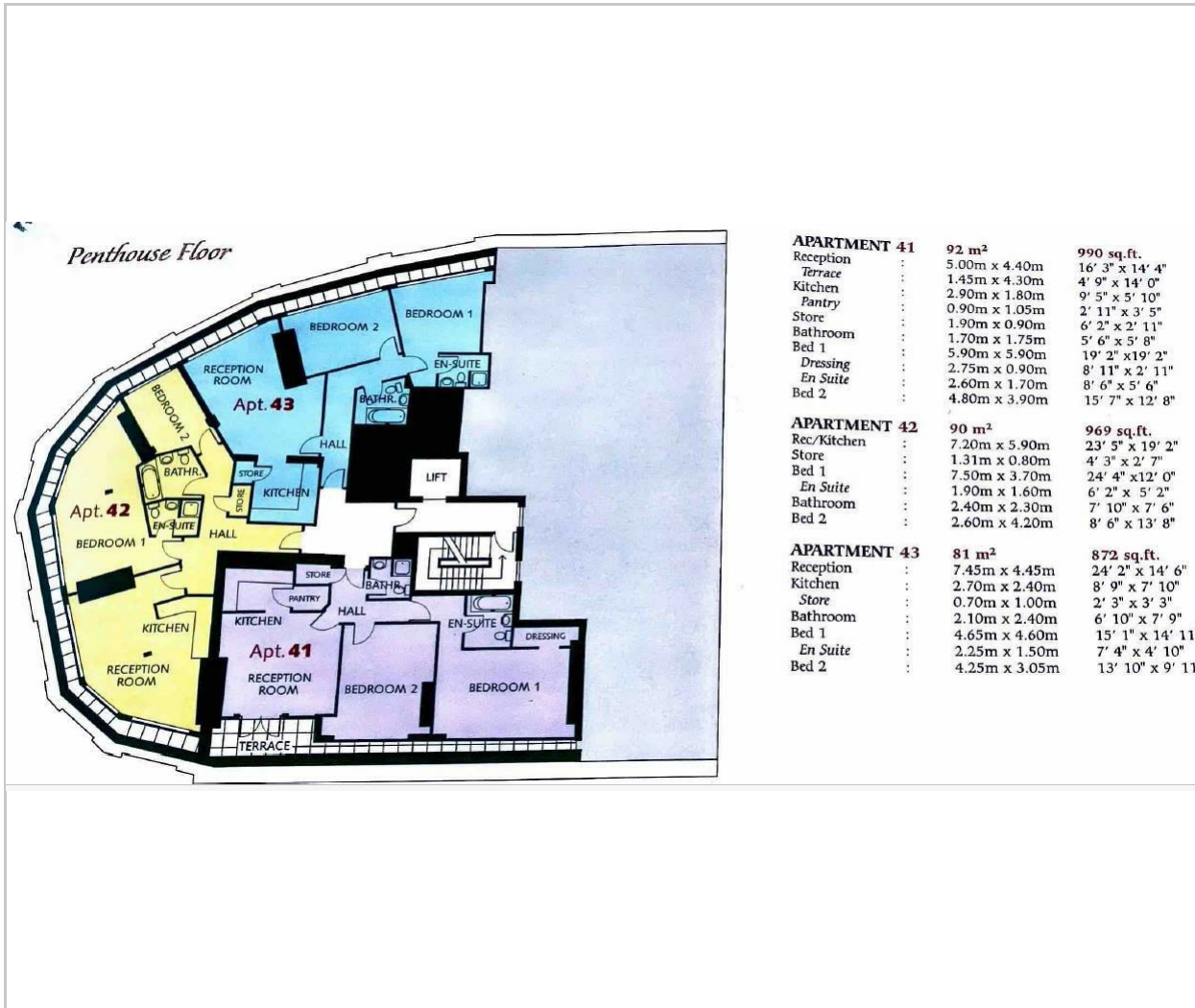

Area Map



Viewing

Please contact our Reside Manchester Office on 0161 837 2840 if you wish to arrange a viewing appointment for this property or require further information.

These particulars, whilst believed to be accurate are set out as a general outline only for guidance and do not constitute any part of an offer or contract. Intending purchasers should not rely on them as statements of representation of fact, but must satisfy themselves by inspection or otherwise as to their accuracy. No person in this firm's employment has the authority to make or give any representation or warranty in respect of the property.

Energy Efficiency Graph

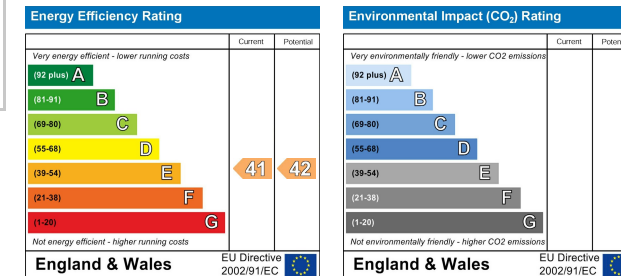

249 Deansgate, Manchester, Greater Manchester, M3 4EN

Tel: 0161 837 2840 Email: info@residemanchester.com www.residemanchester.com