

Floor 0 Building 1

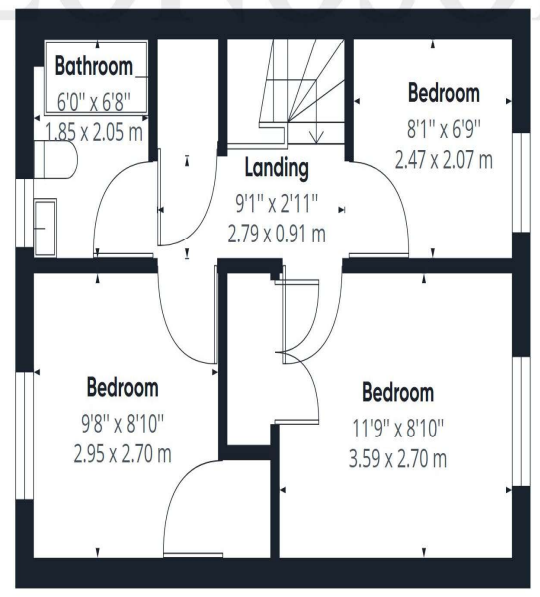

Floor 1 Building 1

LONGSONS



LONGSONS

17 Aircraft Drive, Watton, Thetford, IP25 6ZA

Very well presented modern mid terrace three bedroom house situated in the market town of Watton. The property offers kitchen with integrated appliances, two WC`s, modern bathroom, gardens, gas central heating and UPVC double glazing. Available to rent late August.

Price £1050 pcm To Let





Bedroom Two
9'8" (2.95m) To Wardrobe x 8'10" (2.69m)

Built in wardrobe, UPVC double glazed window to front aspect, radiator.

Bedroom Three
8'1" (2.46m) x 6'9" (2.06m)

UPVC double glazed window to rear aspect, radiator.

Bathroom

Bathroom suite comprising bath with shower over and shower screen, wash basin, WC, tiled splashback, UPVC double glazed window to front aspect, extractor fan, radiator.

Outside Front

Small front garden laid to lawn, path to front door, outside light.

Rear Garden

Enclosed rear garden laid to lawn, paved patio seating area, garden shed, outside tap, outside light, wooden fence to perimeter, gated access to rear with access to side parking area.

All photographs are provided for guidance only.

AGENT NOTE
Photographs used are from previous tenancy, decor, floor coverings and garden may not reflect the current condition

- Mid Terrace House
- Available To Rent late August
- Three Bedrooms
- Very Well Presented Throughout
- Parking
- Gardens
- Kitchen with Integrated Appliances
- Gas Central Heating
- UPVC Double Glazing

Situated on a popular recent development in the Norfolk market town of Watton Longsons are delighted to bring to the rental market this three bedroom mid terrace house. This very well presented house offers kitchen with integrated appliances, parking, gardens, gas central heating and UPVC double glazing.

Available to rent late August

Restrictions Apply: No Pets, No Smokers

Briefly the property offers entrance hall, lounge, kitchen, cloakroom with WC, three bedrooms, bathroom, parking, gardens, gas central heating and UPVC double glazing.

WATTON
Swaffham 10 miles; Thetford 15 miles; Norwich 23 miles
The well-served market town of Watton is in the district of Breckland, just less than 25 miles from Norwich. Perfectly positioned for access to the whole of Norfolk and North Suffolk, this town is thought to be where the 'Babes in the Wood' were abandoned in Wayland

Wood. You will see on the town sign that there are two babes, and a hare jumping over the barrel reflecting the town name; wat being the local dialect word for hare, and ton for barrel. There is a traditional market held every Wednesday morning with produce including freshly caught fish, and there are two supermarkets and a number of independent shops, cafes, restaurants and pubs to enjoy. Within reach is the popular Thetford Forest Park, a number of golf courses, other market towns and not forgetting the cathedral city of Norwich.

Entrance Hall

Composite entrance door to front aspect, stairs to first floor, radiator.

Lounge
14'8" (4.47m) Max x 15'11" (4.85m) Max

L shaped room
Built in storage cupboard, composite entrance door opening to rear garden, UPVC double glazed window to rear aspect, two radiators.

Kitchen

8'11" (2.72m) x 8'4" (2.54m)

Fitted kitchen unit to wall and floor, work surface over, integrated dishwasher, integrated washing machine, space for tall upright fridge/freezer, integrated double electric oven with gas hob and extractor hood over, tiled splashback, cupboard housing gas central heating combi boiler, UPVC double glazed window to front aspect.

Cloakroom

Wash basin, WC, radiator, extractor fan.

Stairs and Landing

Built in storage cupboard with small radiator, radiator.

Bedroom One

11'9" (3.58m) To Wardrobe x 8'10" (2.69m)

Built in wardrobe, UPVC double glazed window to rear aspect, radiator.

