

Alcester Road, Hollywood, Birmingham, B47 5NP

Offers In Region Of £325,000

2 2 2



Charming Period Home with Modern Extensions, Generous Gardens, and Rare Direct Golf Course Access – A Warm and Welcoming Property Offering Comfort, Character, and a Ready-to-Move-Into Lifestyle.

Key Features

- Characterful period home built circa 1900 with charming original style
- Spacious lounge and dining areas ideal for modern family living
- Additional family bathroom providing practicality for everyday life
- Generous rear garden with direct access to the golf course
- Council Tax Band D – efficient and manageable running costs
- Thoughtfully extended with a two-storey addition and bright conservatory
- Two well-sized bedrooms including main with dressing area and en-suite
- Loft insulated and boarded, adding valuable storage space
- Garage offering secure parking or storage solutions
- Ready to move into immediately – blending historic charm with modern comfort

GROUND FLOOR
659 sq.ft. (61.3 sq.m.) approx.

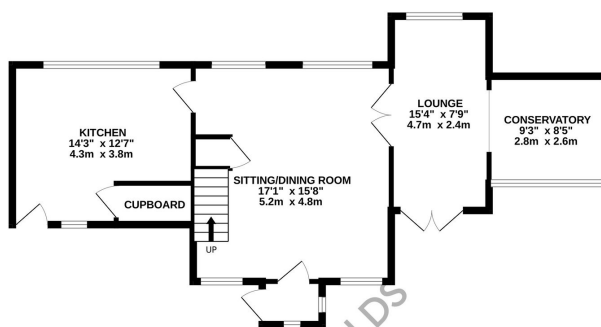

1ST FLOOR
463 sq.ft. (43.0 sq.m.) approx.

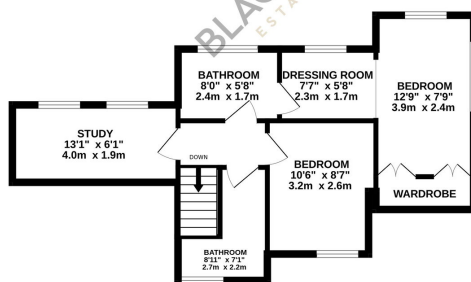

TOTAL FLOOR AREA: 1122 sq.ft. (104.3 sq.m.) approx.

Whilst every attempt has been made to ensure the accuracy of the floorplan contained herein, measurements of doors, windows, rooms and any other items are approximate and no responsibility is taken for any error, omission or mis-statement. This plan is for illustrative purposes only and should be used as such for any prospective purchaser. The services, systems and appliances shown have not been tested and no guarantee as to their operability or efficiency can be given.
Made with Metropix 12/2025