

Glascote Close, Shirley, Solihull, B90 2TA

Offers In Region Of £325,000

3 1 1



This three-bedroom traditional semi-detached home is located in Glascote Close, B90 offering excellent convenience to local amenities, schools, and transport links. Viewings Recommended

Key Features

- Traditional Three Bedroom Semi
- Off Road Parking
- Dining Kitchen to Rear
- Nice Size Rear Garden
- Viewings Highly Recommended
- Garage to Front
- Living Room to Front
- Side Passageway
- Lovely Location
- Close to Local Amenities

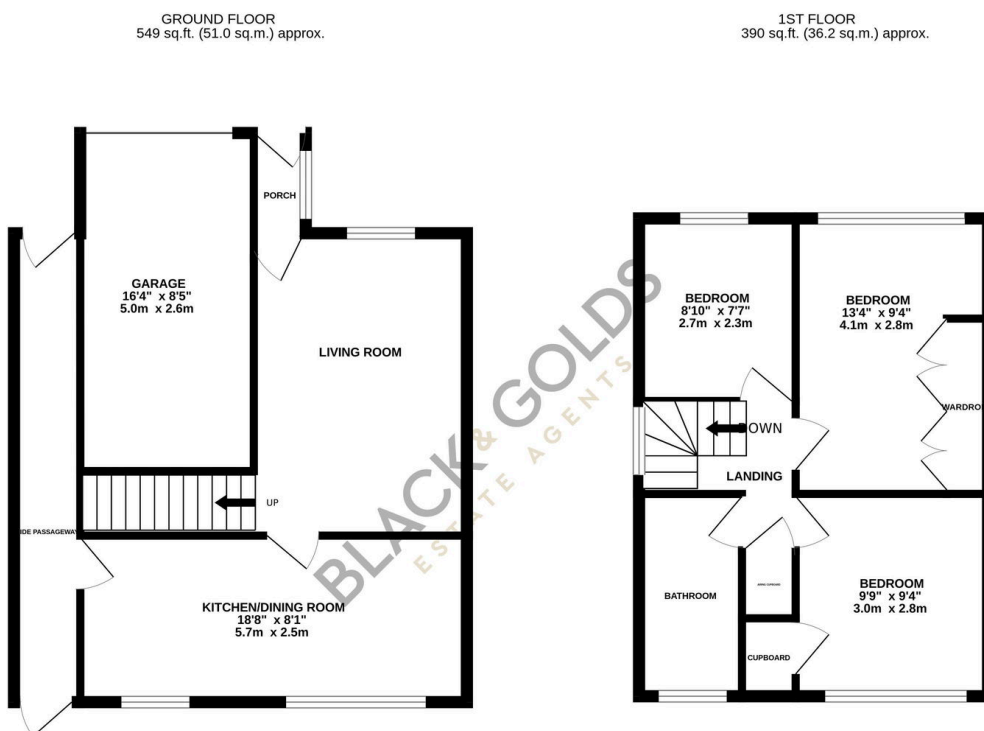

TOTAL FLOOR AREA: 938 sq.ft. (87.2 sq.m.) approx.

Whilst every attempt has been made to ensure the accuracy of the floorplan contained here, measurements of doors, windows, rooms and any other items are approximate and no responsibility is taken for any error, omission or mis-statement. This plan is for illustrative purposes only and should be used as such by any prospective purchaser. The services, systems and appliances shown have not been tested and no guarantee as to their operability or efficiency can be given.

Made with Metropix ©2025