

Scribers Lane, Birmingham, B28 0PD

Offers Over £275,000

3 1 2



A three-bedroom family home in need of some updating, situated on Scribers Lane, B28.

Key Features

- Three Bedrooms
- Living Room
- Popular Location
- Off Road Parking
- Buyers Fee Applies
- Semi Detached
- Dining Kitchen
- Ideal First Time Purchase
- Rear Garden
- Being Sold Through Reservation Fee

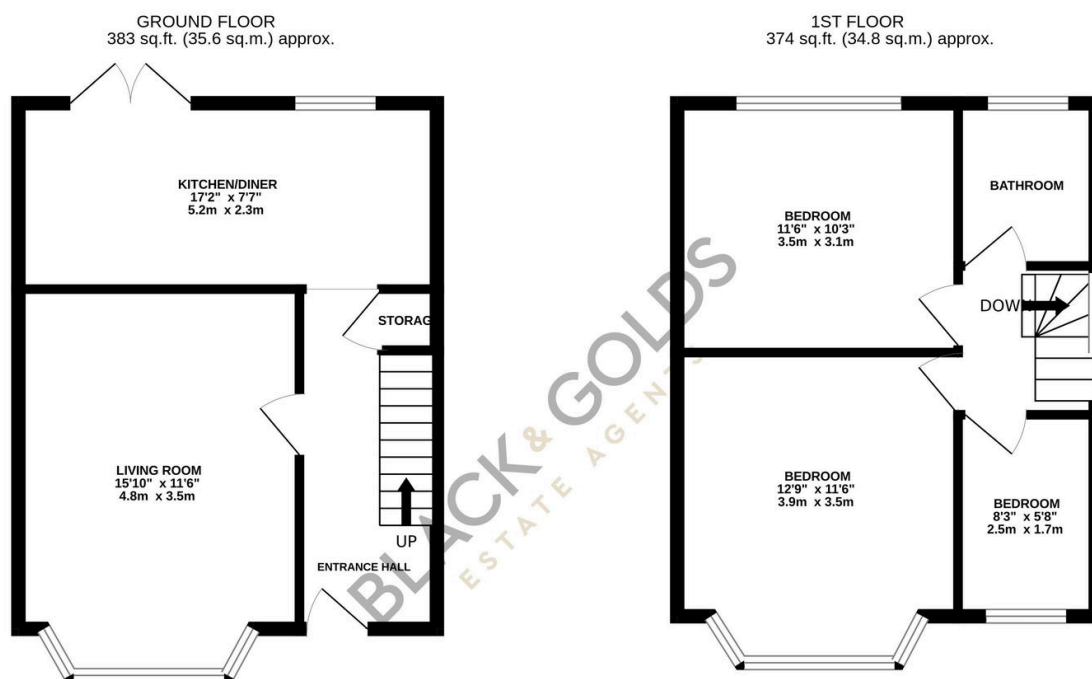

TOTAL FLOOR AREA : 757 sq.ft. (70.4 sq.m.) approx.

Whilst every attempt has been made to ensure the accuracy of the floorplan contained here, measurements of doors, windows, rooms and any other items are approximate and no responsibility is taken for any error, omission or mis-statement. This plan is for illustrative purposes only and should be used as such by any prospective purchaser. The services, systems and appliances shown have not been tested and no guarantee as to their operability or efficiency can be given.

Made with Metropix ©2025