

Berkeley Road, Shirley, Solihull, B90 2HS

Offers Over £360,000

3 1 2



A spacious and extended three-bedroom semi-detached family home located on Berkeley Road, B90. Viewings Highly Recommended

Key Features

- Three Bedroom Family Home
- Semi Detached
- Garage to Rear
- Two Reception Rooms
- Downstairs W.C
- Shower Room to First Floor
- Off Road Parking
- Rear Garden
- Popular Location
- Viewings Recommended

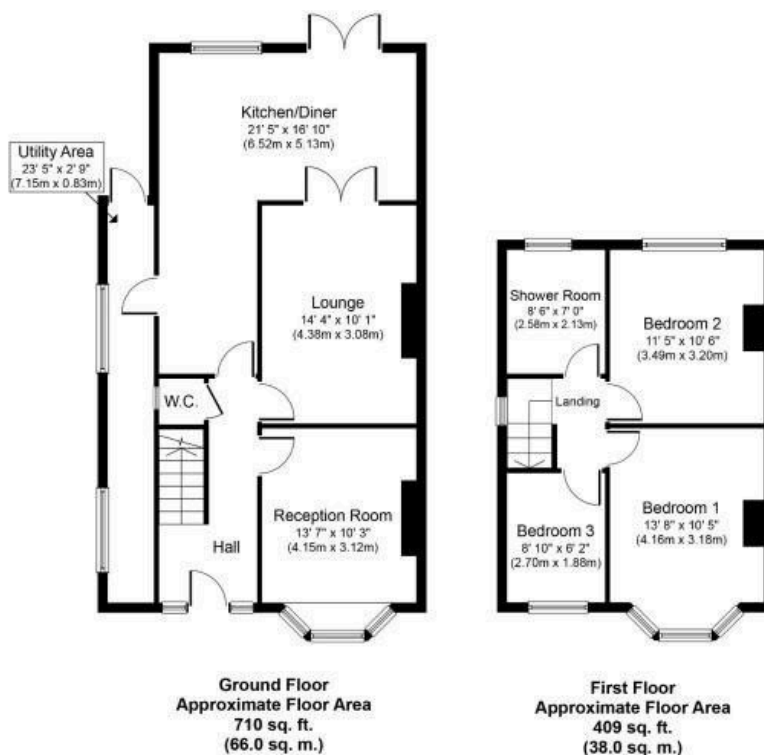

Whilst every attempt has been made to ensure the accuracy of the floor plan contained here, measurements of doors, windows, rooms and any other items are approximate and no responsibility is taken for any error, omission, or mis-statement. This plan is for illustrative purposes only and should be used as such by any prospective purchaser or tenant. The services, systems and appliances shown have not been tested and no guarantee as to their operability or efficiency can be given.

Copyright V360 Ltd 2018 | www.houseviz.com