

## Olton Road, Shirley, Solihull, B90 3NN

Offers Over £270,000

2 1 2



A lovely presented two bedroom semi detached property situated in this popular location of Olton Road, B90. Offered for sale with NO UPWARD CHAIN.

## Key Features

- Two Bedroom Semi Detached Home
- No Upward Chain
- Popular Location
- Two Reception Rooms
- Viewings Highly Recommended
- Off Road Parking

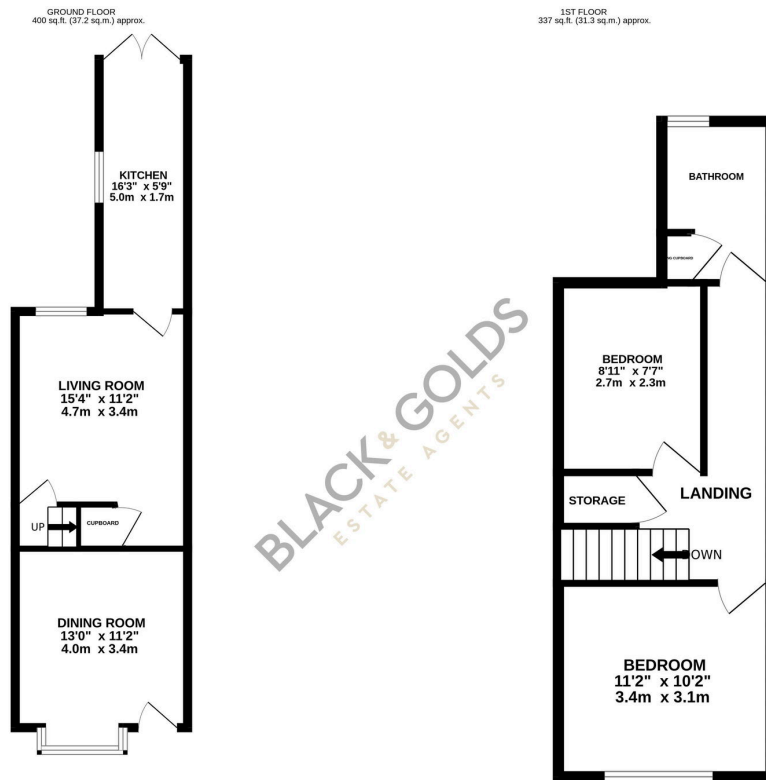

TOTAL FLOOR AREA: 737 sq.ft. (68.5 sq.m.) approx.

Whilst every attempt has been made to ensure the accuracy of the floorplans contained herein, measurements of doors, windows, rooms and any other items are approximate and no responsibility is taken for any error, omission or mis-statement. This plan is for illustrative purposes only and should be used as such by any prospective purchaser. The services, systems and appliances shown have not been tested and no guarantee is given as to their operability or efficiency on the given date.  
Made with Metropix ©2024