

Petersfield Court, Stratford Road, B28

£155,000

2 1 1



A two bedroom, first floor apartment on the Stratford Road, Hall Green. Offered for sale with NO UPWARD CHAIN this property would make an ideal investment opportunity.

Key Features

- Two Bedroom Apartment
- No Upward Chain
- Ideal Investment Opportunity
- Fitted Kitchen
- Off Road Parking
- First Floor
- Popular Location
- Double Bedrooms
- Family Bathroom
- Viewings Recommended

FIRST FLOOR
641 sq.ft. (59.6 sq.m.) approx.

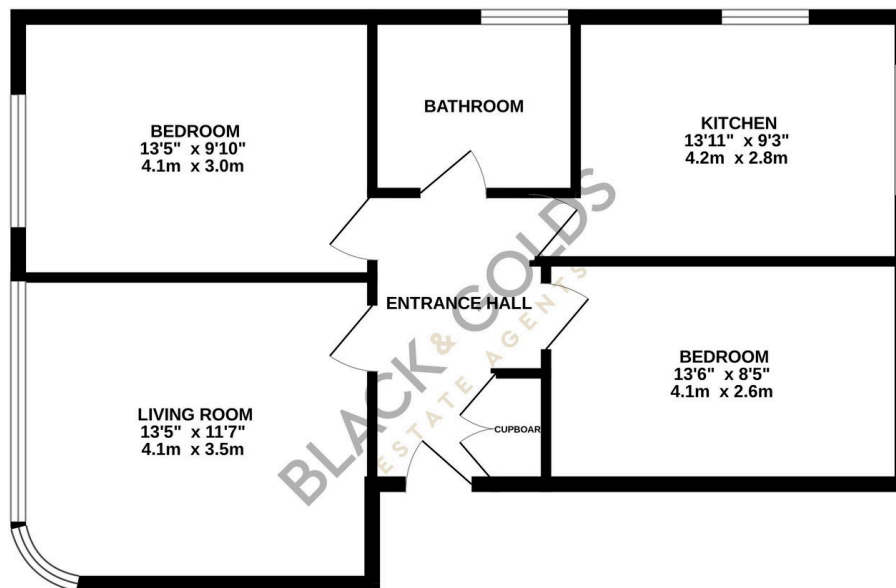

TOTAL FLOOR AREA : 641 sq.ft. (59.6 sq.m.) approx.

Whilst every attempt has been made to ensure the accuracy of the floorplan contained here, measurements of doors, windows, rooms and any other items are approximate and no responsibility is taken for any error, omission or mis-statement. This plan is for illustrative purposes only and should be used as such by any prospective purchaser. The services, systems and appliances shown have not been tested and no guarantee as to their operability or efficiency can be given.
Made with Metropix ©2024