

Ufton Crescent, Shirley, Solihull, B90 3RX

Offers Over £475,000

3 1 2



- Sought-After Location
- Extended Living Room
- Utility Room and Garage
- Large Mature Rear Garden- Potential to extend (subject to planning)
- Tudor Grange Catchment
- Spacious Accommodation
- Versatile Dining Room
- Three Bedrooms
- No Upward Chain
- Viewings Highly Recommended



GROUND FLOOR
759 sq.ft. (70.5 sq.m.) approx.



1ST FLOOR
470 sq.ft. (43.7 sq.m.) approx.

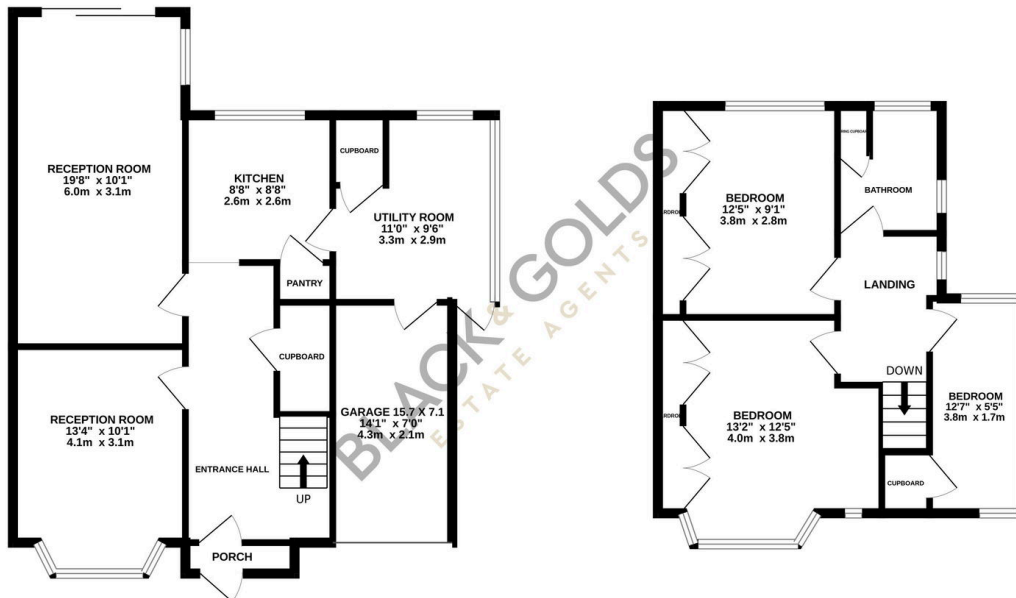

TOTAL FLOOR AREA : 1229 sq.ft. (114.2 sq.m.) approx.

Whilst every attempt has been made to ensure the accuracy of the floorplan contained here, measurements of doors, windows, rooms and any other items are approximate and no responsibility is taken for any error, omission or mis-statement. This plan is for illustrative purposes only and should be used as such by any prospective purchaser. The services, systems and appliances shown have not been tested and no guarantee as to their operability or efficiency can be given.
Made with Metropix ©2024

BLACK AND GOLDS ESTATE AGENTS are pleased to offer for sale this immaculately presented and maintained spacious three bedroom family residence in this lovely location of Ufton Crescent, B90. Viewing highly recommended to appreciate!