

Olton Road, Shirley, Solihull, B90 3NE

Offers In Region Of £265,000

3 1 0



BLACK AND GOLDS ESTATE AGENTS are pleased to offer for sale this three bedroom family residence in this popular location of Olton Road, B90. NO UPWARD CHAIN. Viewings are highly recommended.

Key Features

- A Three Bedroom Property
- Two Reception Rooms
- Conservatory
- Rear Garden
- No Upward Chain
- End Terrace
- Kitchen
- Off Road Parking
- Popular Location
- Ideal Investment

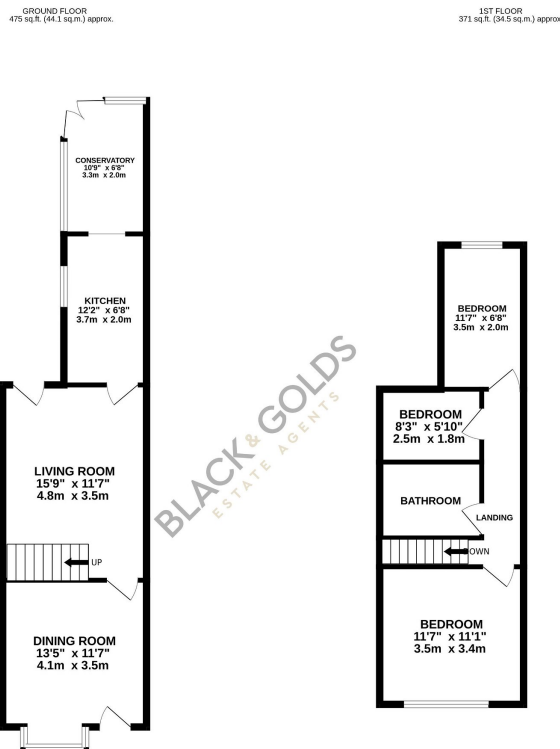

TOTAL FLOOR AREA: 846 sq ft (78.6 sq.m.) approx.

While every effort has been made to ensure the accuracy of the floorplan contained here, measurements of doors, windows, rooms and any other items are approximate and no responsibility is taken for any error, omission or mis-statement. This plan is for illustrative purposes only and should be used as such by any prospective purchaser. The services, systems and appliances shown have not been tested and no guarantee as to their operability or efficiency can be given.
Made with Metropix 02/2024