

Wisemeadows, Shirley, Solihull, B90 1BF

Offers In Region Of £260,000

🛏 2 🚿 1 🚗 1



BLACK AND GOLDS ESTATE AGENTS are pleased to offer for sale this two bedroom family residence in this popular location of Wisemeadows, B90. NO UPWARD CHAIN. Viewings are highly recommended.

Key Features

- A Two Bedroom Property
- No Upward Chain
- Garage
- Rear Garden
- Gas Central Heating
- Semi Detached
- Quiet Location
- Off Road Parking
- Double Glazing
- Viewings Recommended

GROUND FLOOR
335 sq.ft. (31.2 sq.m.) approx.

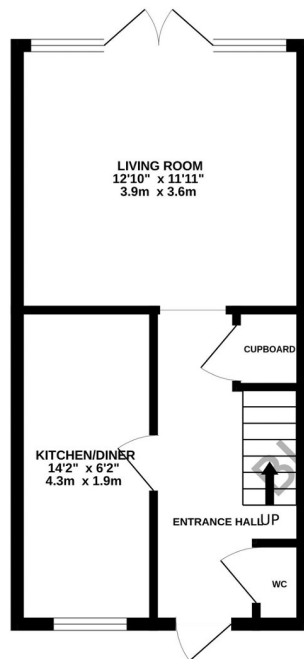

1ST FLOOR
310 sq.ft. (28.8 sq.m.) approx.



TOTAL FLOOR AREA: 645 sq.ft. (59.9 sq.m.) approx.

Whilst every attempt has been made to ensure the accuracy of the floorplan contained here, measurements of doors, windows, rooms and any other items are approximate and no responsibility is taken for any error, omission or mis-statement. This plan is for illustrative purposes only and should be used as such by any prospective purchaser. The services, systems and appliances shown have not been tested and no guarantee as to their operability or efficiency can be given.
Made with Metropix ©2024