

## Creynolds Lane, Cheswick Green, Solihull, B90 4FB

£560,000

🛏 4 🚗 2 🚲 3



BLACK AND GOLDS ESTATE AGENTS are pleased to offer for sale this stunning four/five bedroom semi detached residence with glorious countryside views. Viewings essential to appreciate this home.

## Key Features

- A Stunning Four/Five Bedroom Family Home
- Super Location Between Cheswick Green & Solihull
- Central Heating & Double Glazing
- Spacious And Versatile Living Space
- Please See Property Tour Video
- Stunning Countryside Views
- Extensive Off Road Parking
- Large Rear Garden With Large Covered Deck/Patio
- Media Room to Ground Floor
- Viewings Highly Recommended

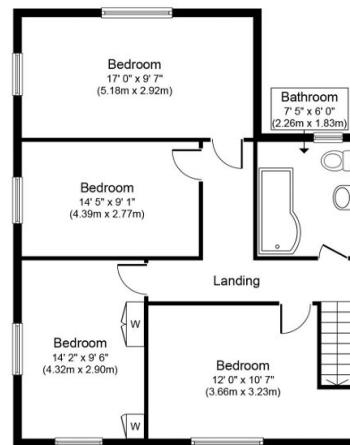

Whilst every attempt has been made to ensure the accuracy of the floor plan contained here, measurements of doors, windows, rooms and any other items are approximate and no responsibility is taken for any error, omission, or mis-statement. The measurements should not be relied upon for valuation, transaction and/or funding purposes. This plan is for illustrative purposes only and should be used as such by any prospective purchaser or tenant. The services, systems and appliances shown have not been tested and no guarantee as to their operability or efficiency can be given.

Copyright V360 Ltd 2024 | www.houseviz.com