

Westfield Avenue, Birmingham, B14 4PN

Offers In Region Of £255,000

3 1 1



BLACK AND GOLDS ARE PLEASED TO OFFER FOR SALE this three-bedroom detached residence situated in Westfield Avenue, B14. Offered with NO UPWARD CHAIN. Viewings Highly Recommended.

Key Features

- Three Bedroom Detached Home
- Living Room
- Off Road Parking
- Rear Garden
- Nice Location
- Great for First Time Buyers
- Dining Kitchen
- Garage
- No Upward Chain
- Viewings Highly Recommended

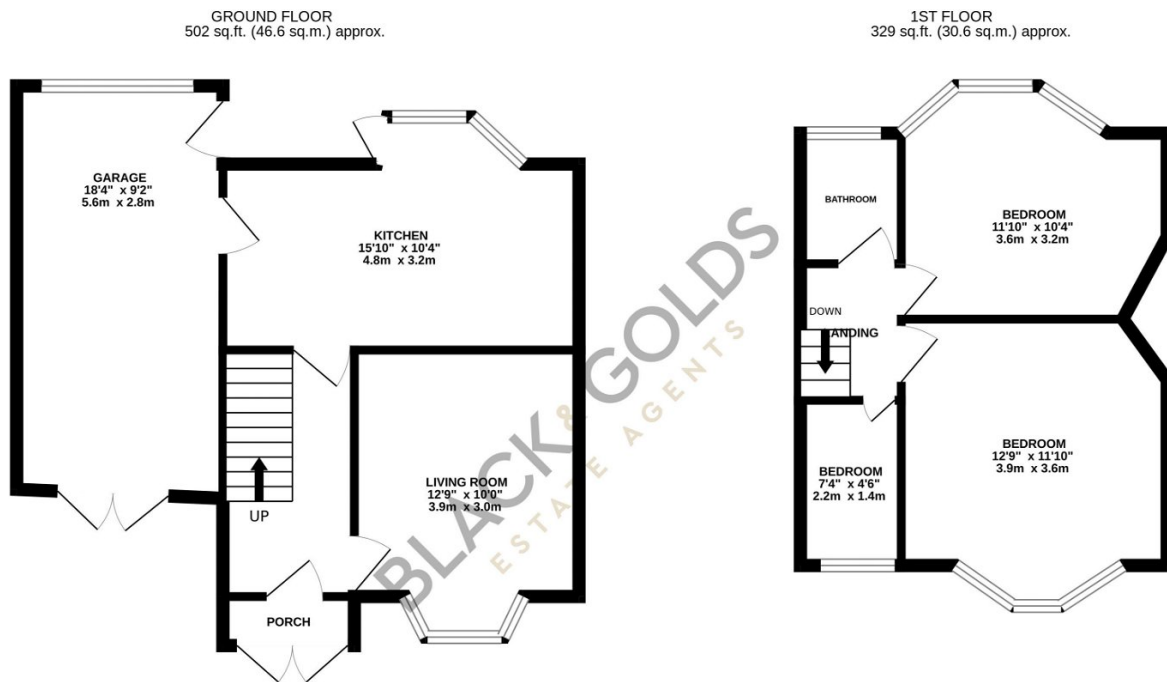

TOTAL FLOOR AREA : 831 sq.ft. (77.2 sq.m.) approx.

Whilst every attempt has been made to ensure the accuracy of the floorplan contained here, measurements of doors, windows, rooms and any other items are approximate and no responsibility is taken for any error, omission or mis-statement. This plan is for illustrative purposes only and should be used as such by any prospective purchaser. The services, systems and appliances shown have not been tested and no guarantee as to their operability or efficiency can be given.
Made with Metropix ©2024