

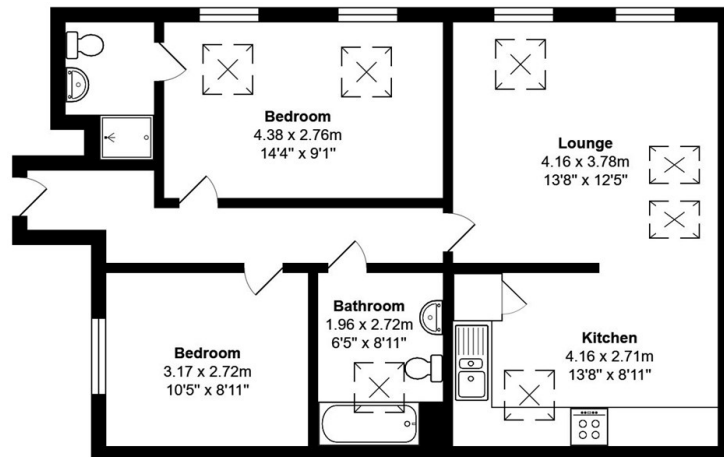

Apartment 23 Woodlands Mill, Mulberry Lane, Steeton, BD20 6PP

£695 PCM

- Two Bedroom Apartment
- Close To Train Links
- Tenancy term - Ask Agent
- Designated Parking
- EPC Rating - Exempt
- Character Features
- Council Tax Band - B



Ground Floor

Total Area: 66.2 m² ... 712 ft²

All measurements are approximate and for display purposes only

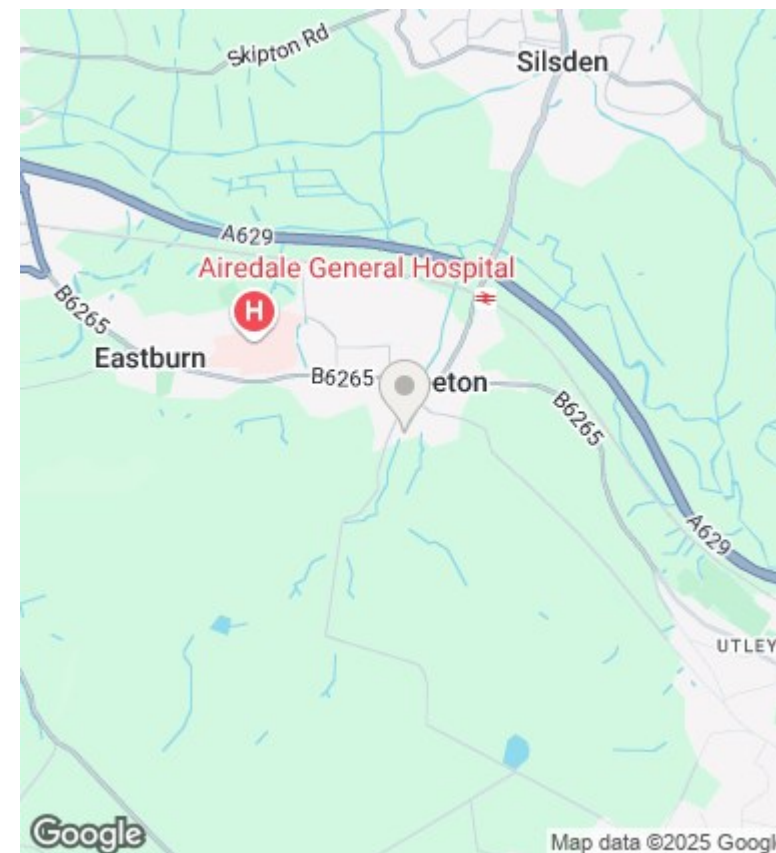

Directions

Viewings

Viewings by arrangement only. Call 01535 636238 to make an appointment.

Council Tax Band

B

EPC Rating: