

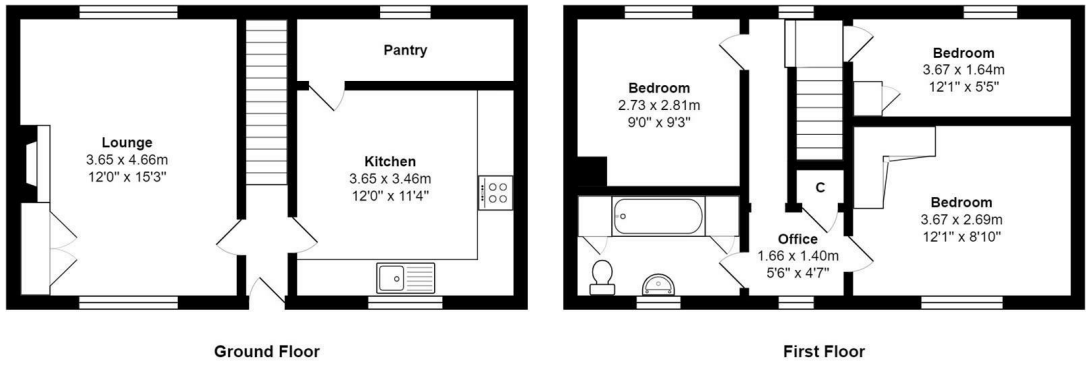

Amber Cottage, Kettlewell, Skipton, BD23 5QZ

Offers In The Region Of £349,950

- STONE BUILT DOUBLE FRONTED COTTAGE
- GENEROUS GARDEN
- WELL PLANNED ACCOMMODATION
- EARLY VIEWING A MUST!
- THREE BEDROOMS
- OFF ROAD PARKING
- COUNRYSIDE VIEWS
- SMALL TWO STOREY DETACHED BARN
- DELIGHTFUL VILLAGE SETTING
- OIL FIRED CENTRAL HEATING



Total Area: 77.5 m² ... 835 ft²
 All measurements are approximate and for display purposes only

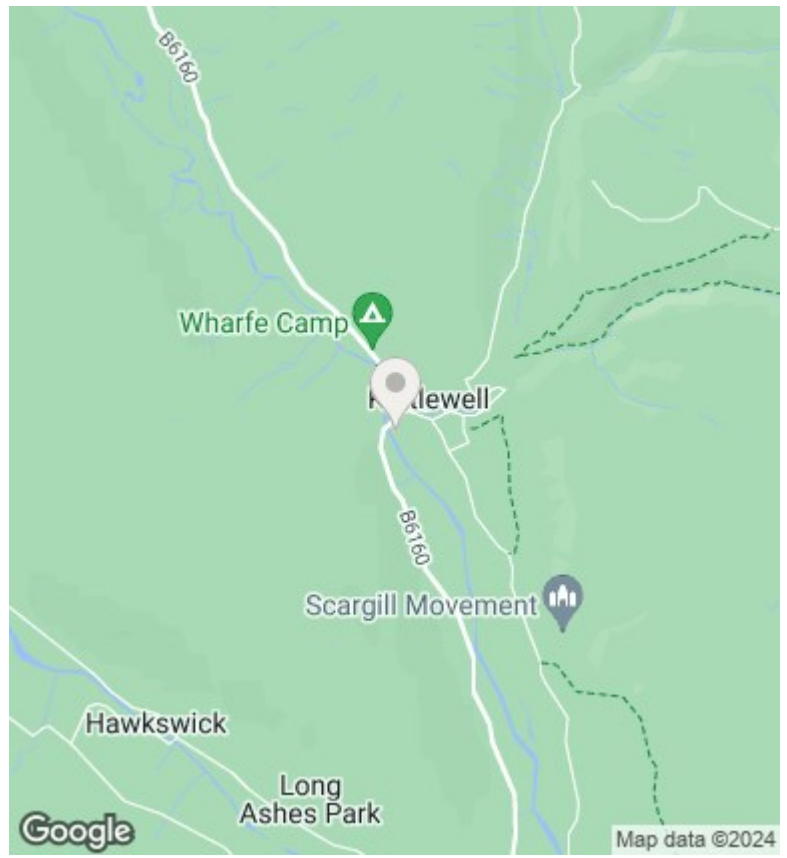

Directions

Viewings

Viewings by arrangement only. Call 01535 636238 to make an appointment.

Council Tax Band

EPC Rating:

E

Energy Efficiency Rating		Current	Potential
<i>Very energy efficient - lower running costs</i>			
(92 plus)	A		90
(81-91)	B		
(69-80)	C		
(55-68)	D		
(39-54)	E	45	
(21-38)	F		
(1-20)	G		
<i>Not energy efficient - higher running costs</i>			
England & Wales		EU Directive 2002/91/EC	