



# Heathcroft Road , Wickford, SS11 8YA Guide Price £300,000

\*\*\*\* GUIDE PRICE £300,000 - £325,000 \*\*\*\*

Welcome to this delightful end of terrace home, now available for viewing now. This charming abode has been maintained in good condition, showcasing two spacious double bedrooms that are perfect for couples seeking room to grow. The property is an inviting place you can call home, filled with warmth and comfort.

As you walk in, you will be greeted by a cosy reception room where you can entertain guests or simply unwind after a long day. The room is tastefully proportioned and offers a wonderful space for relaxation and socialising with sliding door leading to the conservatory.

The property boasts a modern kitchen equipped with up-to-date appliances ready to inspire your inner chef. The kitchen reflects a tasteful blend of contemporary design and practicality, ensuring you can cook up a storm for family and friends.

The property also has a well-appointed bathroom, ensuring your comfort and convenience. The bathroom, like the rest of the home, has been kept in good condition.

## Viewing

Please contact our Cowling & Payne Office on 01268 730707 if you wish to arrange a viewing appointment for this property or require further information.

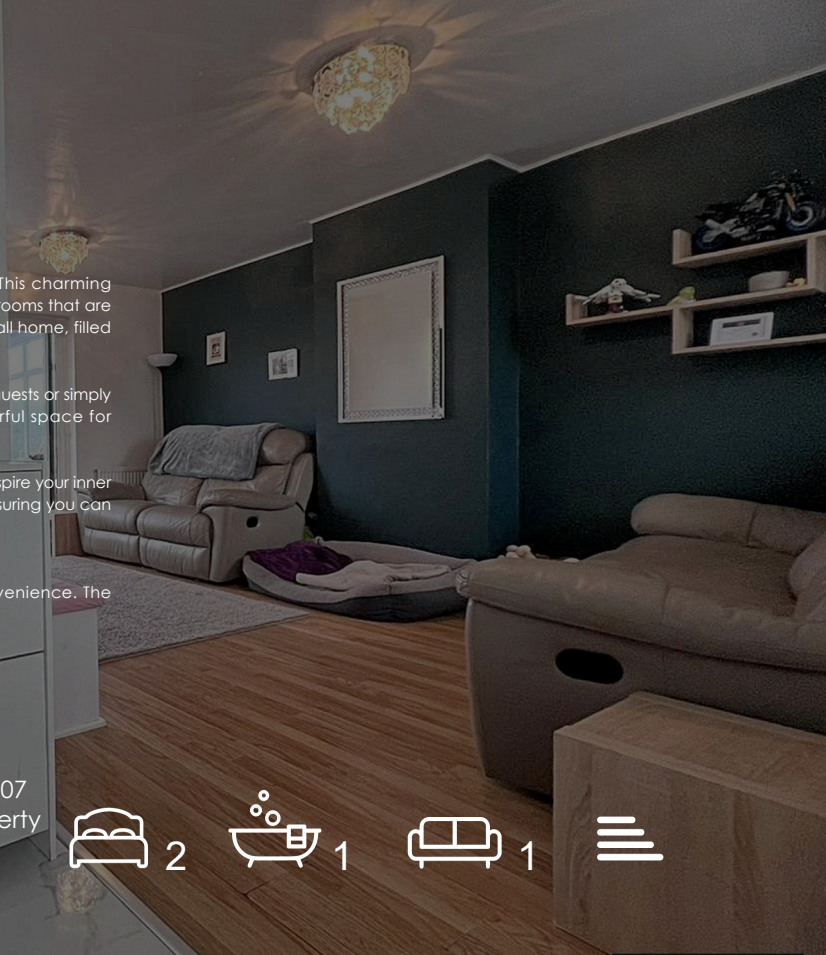



# Floor Plan

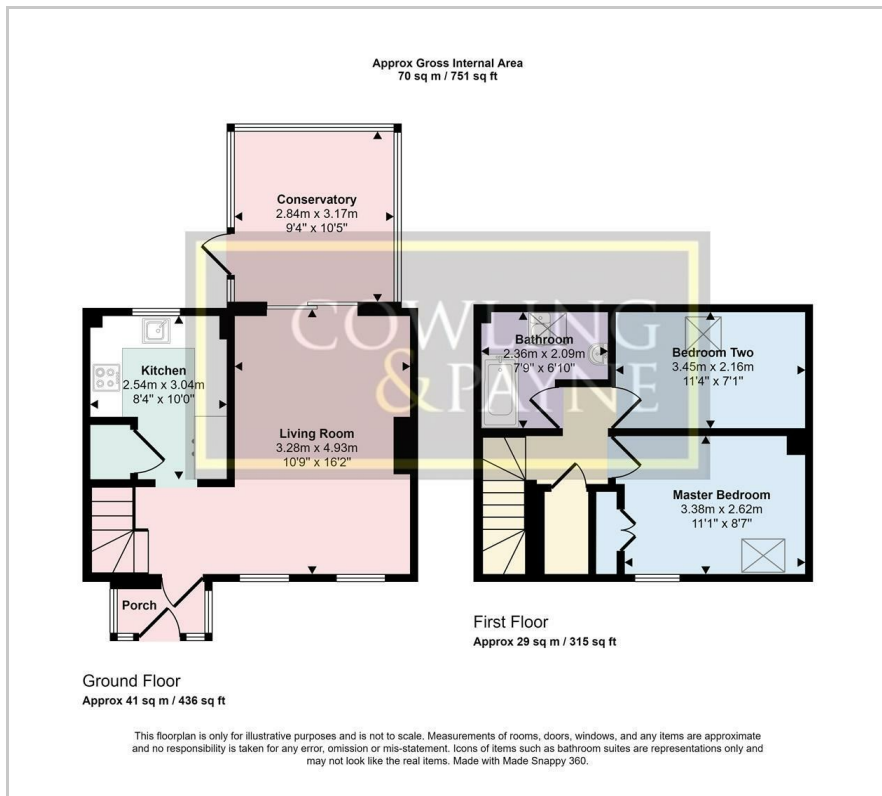

# Area Map



# Energy Efficiency Graph

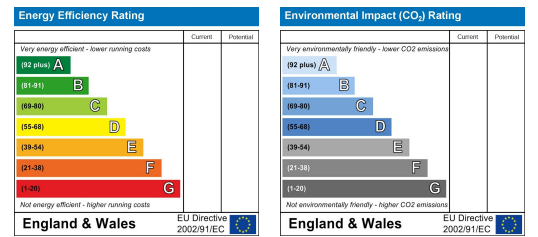

These particulars, whilst believed to be accurate are set out as a general outline only for guidance and do not constitute any part of an offer or contract. Intending purchasers should not rely on them as statements of representation of fact, but must satisfy themselves by inspection or otherwise as to their accuracy. No person in this firm's employment has the authority to make or give any representation or warranty in respect of the property.

2-4 Runwell Road, Wickford, Essex, SS11 7AB

Tel: 01268 730707 Email: info@cowlingandpayne.co.uk <https://www.cowlingandpayne.co.uk>