



# Langenhoe

, Wickford, SS12 9BE

Guide Price £330,000

\*\*\*\* GUIDE PRICE £330,000 - £350,000 \*\*\*\*

Presenting a charming semi-detached property for sale, in good condition and ready to welcome its new owners. This alluring residence is a blend of comfort and convenience, offering a delightful opportunity for those seeking a home with character and potential.

The property features two well-sized bedrooms that provide a peaceful retreat after a long day. With scope for personalisation, these rooms can be tailored to suit any needs, be it a cosy bedroom, a home office or a personal sanctuary. Completing the first floor is the bathroom which is a fair size.

A notable attribute of this home is its well-appointed kitchen. The kitchen is a space that invites you to create, offering the perfect setting for preparing daily meals or hosting dinner parties. Whether you're an aspiring chef or simply enjoy the comforts of home-cooked meals, this kitchen provides the perfect backdrop for your culinary adventures.

The property also boasts a reception room which serves as the heart of the home. This is a space where you can unwind and relax, host guests or enjoy quiet family evenings. The room is bathed in natural light, creating a warm and inviting atmosphere that enhances the overall appeal of the property.

- TWO BEDROOM
- SEMI-DETACHED
- DRIVEWAY & GARAGE
- CHAIN FREE
- CLOSE TO STATION
- CLOSE TO TOWN



## Viewing

Please contact our Cowling & Payne Office on 01268 730707 if you wish to arrange a viewing appointment for this property or require further information.





# Floor Plan

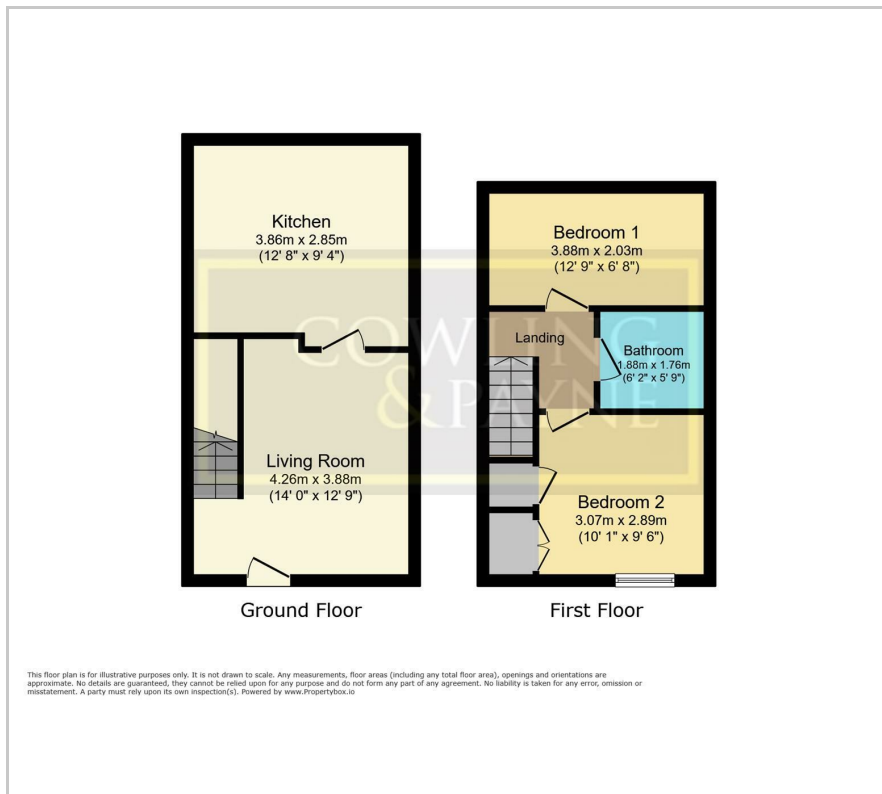

# Area Map



# Energy Efficiency Graph

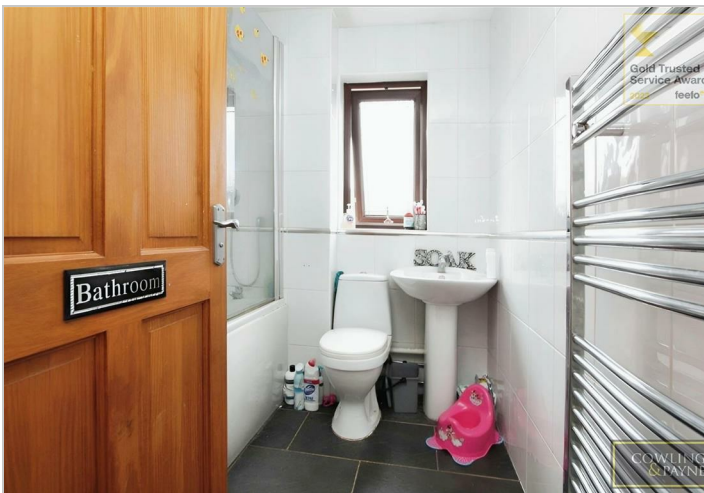
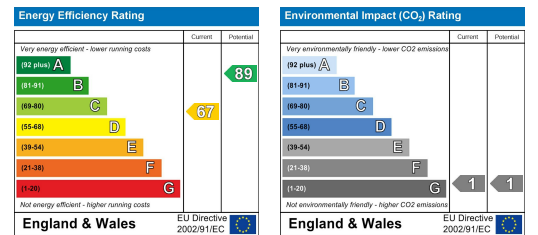

These particulars, whilst believed to be accurate are set out as a general outline only for guidance and do not constitute any part of an offer or contract. Intending purchasers should not rely on them as statements of representation of fact, but must satisfy themselves by inspection or otherwise as to their accuracy. No person in this firm's employment has the authority to make or give any representation or warranty in respect of the property.