



Symonds  
& Sampson

Plot 198, 12 Tumulus Lane  
Nottingham Park, Weymouth, Dorset



# Plot 198, 12 Tumulus Lane

Nottingham Park  
Weymouth  
Dorset DT3 5FZ

An individual Coach House, plot 198 includes open plan accommodation, utility room, two double bedrooms, single garage with parking space to the side.



- Coach House on two levels
  - 2 double bedrooms
- Open plan accommodation
- Garage and two parking spaces
  - Courtyard garden
- Please call Symonds & Sampson Poundbury office on 01305 251154
- Council Tax Banding – Banding TBC

Guide Price £330,000

Freehold

Poundbury Sales  
01305 251154  
[poundbury@symondsandsampson.co.uk](mailto:poundbury@symondsandsampson.co.uk)





## THE PROPERTY

An individual Coach House. Plot 198 is constructed with brick, under a tiled roof with accommodation arranged over two floors.

## ACCOMMODATION

On the ground floor, there is a welcoming good sized entrance hall with a utility room and door to the rear leading to a fully enclosed garden.

On the first floor there is an open plan living area with kitchen offering integrated appliances and dining and living area with a window to the front. There are two double bedrooms a contemporary fitted family bathroom suite, and an airing cupboard.

Please Note:

The drawings and particulars are for illustrative purposes only and shall not form part of any contract. Example images on the brochure are from a typical show home.

## OUTSIDE

The property includes a courtyard garden and a single integral garage and benefits from a parking space to the side of the property.

## SITUATION

Nottingham Park is an exciting new development designed around green open spaces, tree lined avenues, woodland play area and walkways. A good range of amenities can be found within approximately 1 mile including a general store, petrol station, florist, veterinary clinic, supermarket and sport centre, all located on Dorchester Road. There are also both primary and secondary schools close by.

Weymouth town centre can be found within approximately 2 miles and offers a comprehensive range of shops, marina and picturesque harbour, blue flag sandy beach and a range of recreational and cultural facilities. The area also provides the opportunity to enjoy a range of sailing and water sports activities, beaches and walks along the World Heritage Jurassic. There is a mainline rail station at Upwey, approximately  $\frac{3}{4}$  of a mile from the property which provides rail links to London Waterloo and Bristol Temple Meads.

## DIRECTIONS

What3words///marinated.dolly.across

## SERVICES

Mains gas, electric, water and drainage. Gas fired central heating system.

The property will include a NHBC 10-year warranty and benefits from a gas fired central heating system.

Local Authority Dorset Council - Tel: 01305 251010

Council tax band – new build to be assessed  
EPC band - B

Estate management charge  
£155.30 per annum





# PLOT 198

TWO BEDROOM HOME

## FIRST FLOOR

Living/Dining Room  
3.42 x 5.71m (11'3 x 18'9ft)

Kitchen  
2.69 x 2.76m (8'10 x 9'1ft)

Bedroom 1  
3.07 x 3.79m (10'1 x 12'5ft max)  
(Dimensions excluding door recess)

Bedroom 2  
3.10 x 2.67m (10'2 x 8'9ft max)  
(Dimensions excluding door recess)

## GROUND FLOOR

Entrance Hall / Garden Room  
2.86 x 2.68m (9'5 x 8'10ft)

Utility  
1.66 x 2.92m (5'5 x 9'7ft)

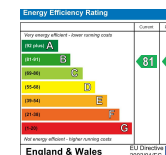

## FIRST FLOOR

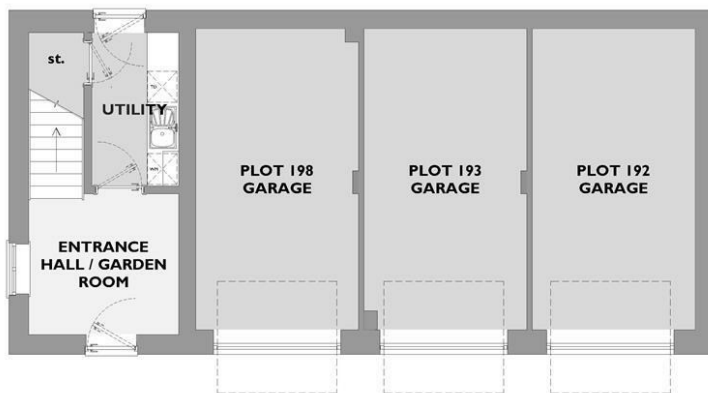

## GROUND FLOOR

Poundbury/PGS/08.05.25



01305 251154

poundbury@symondsandsampson.co.uk  
Symonds & Sampson LLP  
Arch Point House, 7 Queen Mother Square,  
Poundbury, Dorset DT1 3BY



Important Notice: Symonds & Sampson LLP and their Clients give notice that: 1. They have no authority to make or give any representations or warranties in relation to the property. These particulars do not form part of any offer or contract and must not be relied upon as statements or representations of fact. 2. Any areas, measurements or distances are approximate. The text, photographs and plans are for guidance only and are not necessarily comprehensive. It should not be assumed that the properties have all necessary planning, building regulation or other consents and Symonds and Sampson LLP have not tested any services, equipment of facilities. 3. We have not made any investigation into the existence or otherwise of any issues concerning pollution of the land, air or water contamination and the purchaser is responsible for making his/her own enquiries in this regard. 4. The property is sold subject to and with the benefit of all existing wayleaves, easements and rights of way whether public or private, specifically mentioned or not. The vendors shall not be required to define any such rights, privileges or advantages.

SALES | LETTINGS | AUCTIONS | FARMS & LAND | COMMERCIAL | NEW HOMES | PLANNING & DEVELOPMENT