

HUNTERS[®]

HERE TO GET *you* THERE



Ridgeway

ShIPLEY, BD18 1PJ

£950 Per Month



Welcome to this charming property located in the picturesque area of Wrose, Shipley. This delightful house boasts a spacious reception room, perfect for entertaining guests or relaxing with your family. With three cosy bedrooms, there is ample space for everyone to enjoy their own private retreat.

The property features a well-maintained bathroom, ensuring your comfort and convenience. Additionally, the lovely gardens surrounding the house on three sides provide a peaceful sanctuary where you can unwind and enjoy the beauty of nature.

For those in need of storage space or looking to protect their vehicle from the elements, the garage offers a secure and convenient solution. The dining room is ideal for hosting dinner parties or enjoying family meals together.

Equipped with appliances, this property is ready for you to move in and start creating lasting memories. Don't miss out on the opportunity to make this house your home in Wrose, Shipley.



Area Map

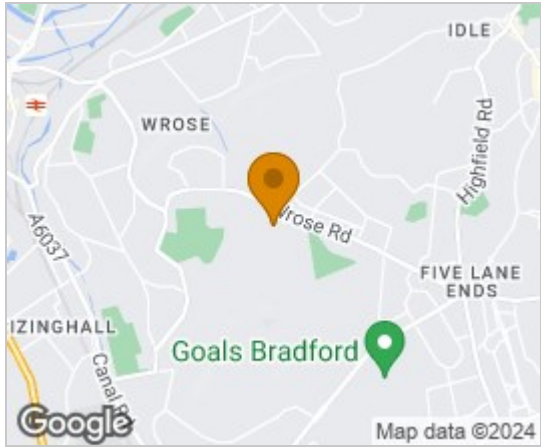

Floor Plans

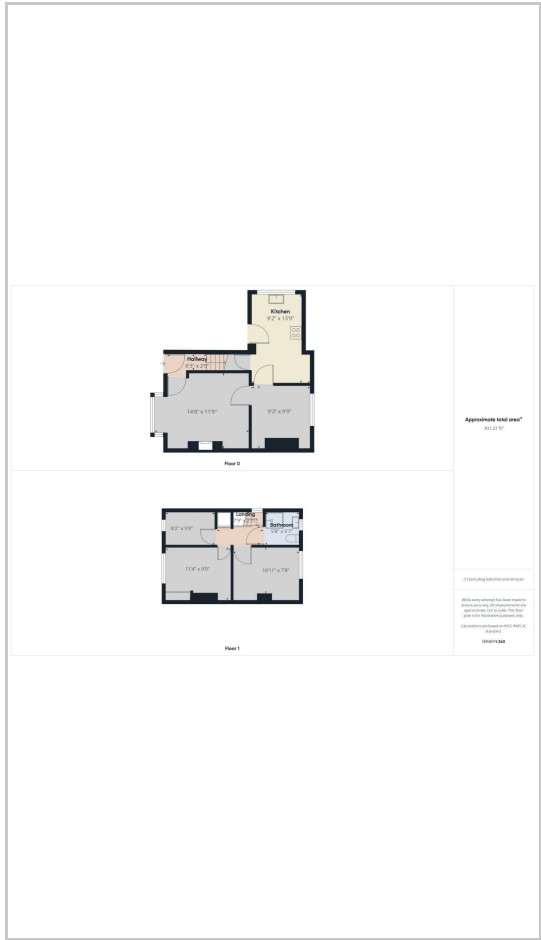

Energy Efficiency Graph

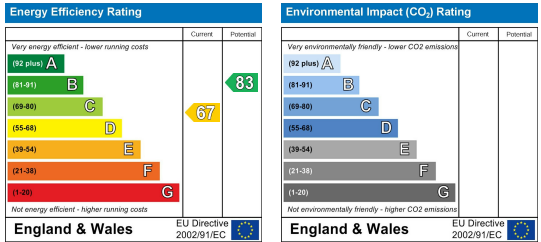

These particulars are intended to give a fair and reliable description of the property but no responsibility for any inaccuracy or error can be accepted and do not constitute an offer or contract. We have not tested any services or appliances (including central heating if fitted) referred to in these particulars and the purchasers are advised to satisfy themselves as to the working order and condition. If a property is unoccupied at any time there may be reconnection charges for any switched off/disconnected or drained services or appliances - All measurements are approximate. **THINKING OF SELLING?** If you are thinking of selling your home or just curious to discover the value of your property, Hunters would be pleased to provide free, no obligation sales and marketing advice. Even if your home is outside the area covered by our local offices we can arrange a Market Appraisal through our national network of Hunters estate agents.