

EADON
LOCKWOOD
& RIDDLE
ESTD 1840

3, Progress Court, Bakewell, DE45 1DA

3, Progress Court, Bakewell, Derbyshire DE45 1DA

Tenure: Freehold

Local Authority: Derbyshire Dales

Council Tax: Band B

EPC Rating: C

A well-presented two bedroomed first floor apartment forming part of Progress Court, an attractive stone built development close to the heart to Bakewell. Conveniently located within walking distance of the Town Centre and having recently been refurbished, the property offers ideal accommodation for a couple or individual, with the benefit of excellent amenities nearby. The property benefits from an allocated parking space, recently installed heating system and new carpets & flooring throughout.

The accommodation comprises: communal entrance hallway with stairs up to front entrance door. Private entrance hall, modern fitted kitchen with high gloss units, dishwasher and washing machine. Sitting room. Two bedrooms, Shower room with wash hand basin and low level w.c. Outside, there is a communal courtyard and allocated parking space.





Only Floor
51 Sq.m/549.33 Sq.ft
Approx

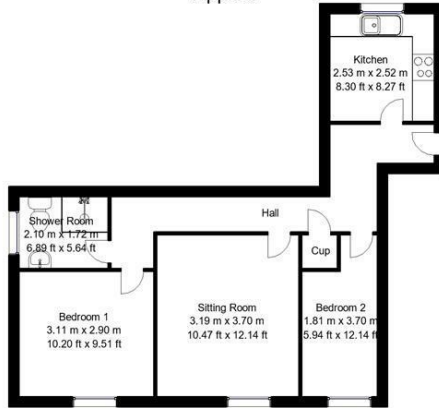

Whilst every attempt has been made to ensure the accuracy of the floor plan contained here, no responsibility is taken for incorrect measurements of doors, windows, appliances and room or any error, omission or misstatement. Exterior and interior walls are drawn to scale based on interior measurements. Any figure given is for initial guidance only and should not be relied on as basis of valuation. These plans are for marketing purposes only and should be used as such by any prospective purchase. Specially no guarantee is should not be relied on as a basis of valuation. These plans are for marketing purposes only and should be used as such by any prospective purchase. Specifically no guarantee is given on the total square footage of the property if quoted on this plan.
CC Ltd ©2018

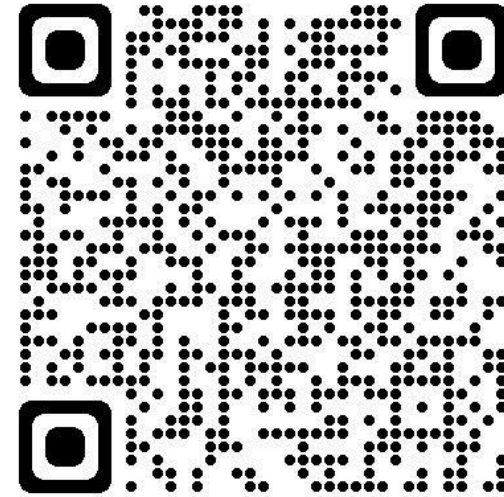

Bakewell
3 Royal Oak Place
Matlock Street
Bakewell DE45 1HD
T: 01629 700699
E: bakewell@elr.co.uk

Banner Cross
888 Ecclesall Road
Banner Cross
Sheffield S11 8TP
T: 01142 683388
E: bannercross@elr.co.uk

Dore
33 Townhead Road
Sheffield
S17 3GD
T: 0114 2362420
E: dore@elr.co.uk

Hathersage
Main Road, Hathersage
Hope Valley
Derbyshire S32 1BB
T: 01433 651888
E: peakdistrict@elr.co.uk

Rotherham
149 Bawtry Road
Wickersley
Rotherham S66 2BW
T: 01709 917676
E: wickersley@elr.co.uk

**EADON
LOCKWOOD
& RIDDLE**
ESTD 1840

All rooms have been measured with electronic laser and are approximate measurements only. None of the services to the above property have been tested by ourselves, and we cannot guarantee that the installations described in the details are in perfect working order. Eadon Lockwood & Riddle for themselves, and for the vendors or lessors, produce these brochures in good faith, and are a guideline only. They do not constitute any part of a contract and are correct to the best of our knowledge at the time of going to press.