



1 North Park, Dale Road North, Darley Dale, DE4 2HY

1 North Park, Dale Road North

Darley Dale, DE4 2HY

The property briefly consists of:

Kitchen with, oven, hob, fridge freezer and washing machine.

Dining room with large window letting in ample light, the room is open to the kitchen and also houses the pantry.

Living room to the front of the property with views over the garden.

To the first floor:

Large master bedroom to the front of the house with two windows making it bright and airy.

Second double bedroom to the rear of the property.

Bathroom with shower over bath, WC and basin. There is also a useful storage cupboard.

To the outside:

Lawn garden to the front of the house. To the rear there is a raised patio area and shed which has electric.

Off road parking for one car (two small cars could fit)

- Two double bedroomed semi-detached home
- Bathroom with shower over bath, WC and basin
- Living room to the front of the property
- Dining room with pantry
- Kitchen with oven, hob, fridge freezer and washing machine
- Garden to the front and patio to the rear. Shed with electric also included
- Off road parking for one car (possibly two small cars)
- Freehold, Band B Council Tax
- Close to Bakewell, Matlock and Chatsworth Estate
- Internal viewing essential





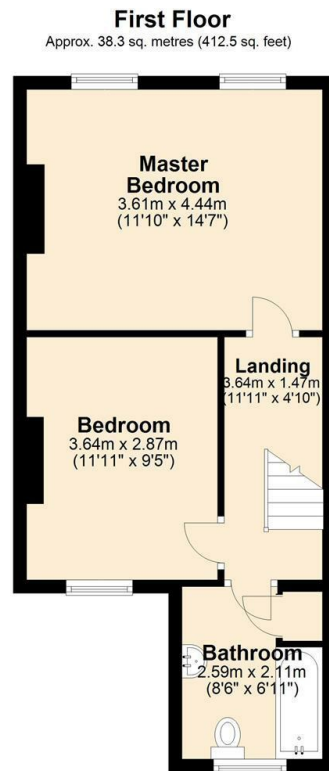
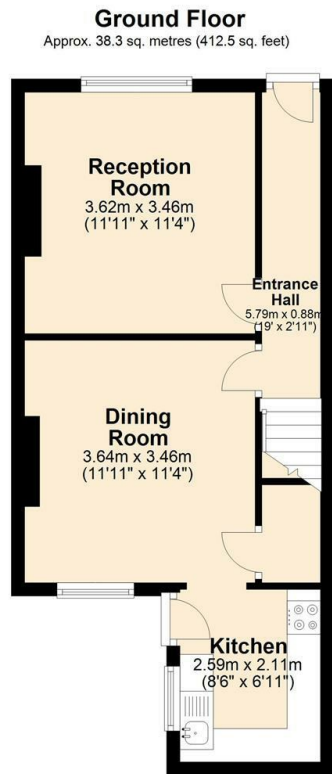

Total area: approx. 76.7 sq. metres (825.1 sq. feet)



Bakewell
3 Royal Oak Place
Matlock Street
Bakewell DE45 1HD
T: 01629 700699
E: bakewell@elr.co.uk

Banner Cross
888 Ecclesall Road
Banner Cross
Sheffield S11 8TP
T: 01142 683388
E: bannercross@elr.co.uk

Dore
33 Townhead Road
Sheffield
S17 3GD
T: 0114 2362420
E: dore@elr.co.uk

Hathersage
Main Road, Hathersage
Hope Valley
Derbyshire S32 1BB
T: 01433 651888
E: peakdistrict@elr.co.uk

Rotherham
149 Bawtry Road
Wickersley
Rotherham S66 2BW
T: 01709 917676
E: wickersley@elr.co.uk

**EADON
LOCKWOOD
& RIDDLE**
ESTD 1840