



6 Velvet Mill, Summer Cross, Tideswell, SK17 8HU

6 Velvet Mill, Summer Cross

Tideswell, SK17 8HU

Description

Apartment 6 forms part of this attractive, converted mill and occupies an enviable position on the edge of Tideswell which boasts a rich history and a thriving community. Historically the village has always been a popular place to live and its long tradition of food markets and industry is very much still in evidence today, making it a great place to live, visit and socialise. Velvet Mill is situated in a slightly elevated position, and therefore commands fine views from the rear, down the valley and over the village, conveniently close to the superb amenities found in the heart of the village. There are numerous cafes, restaurants and public houses close to hand that cater to weary walkers, tourists and local residents, combining to provide a strong sense of community. Apartment 6 is one of the larger properties on this attractive mill conversion and offers generously proportioned accommodation over two floors which will be sure to impress. Storage space in apartments can sometimes be very limited however number 6 benefits from a comprehensive range of fitted and built in cupboards that should be more than enough for your needs. With its generous proportions over two floors, pretty communal grounds and off road parking you will not fail to be impressed by this lovely home.

- Versatile accommodation laid out over two floors.
- Two good double bedrooms, one with fitted wardrobes.
- Large reception room with under stairs storage cupboard.
- Modern kitchen with breakfast bar.
- Bathroom with contemporary sanitaryware.
- Gorgeous, communal gardens.
- Communal parking area at the rear.
- Reception lobby with fitted cloaks storage cupboards.
- 999 year lease from 1982 at an annual ground rent of £15 and EPC rating D57.
- Gas central heating and UPVC double glazed.







First Floor

Approx. 36.6 sq. metres (394.5 sq. feet)

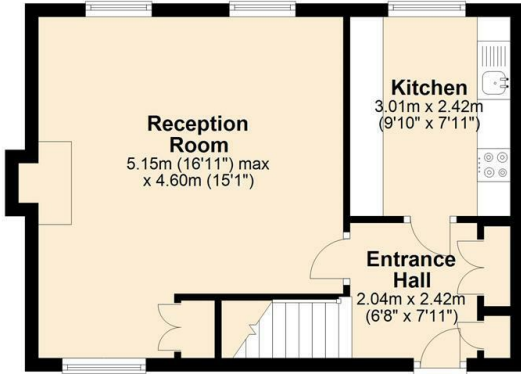

Second Floor

Approx. 37.2 sq. metres (400.6 sq. feet)

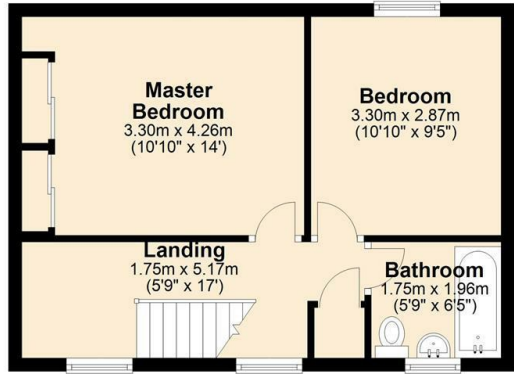

Total area: approx. 73.9 sq. metres (795.1 sq. feet)

Bakewell
3 Royal Oak Place
Matlock Street
Bakewell DE45 1HD
T: 01629 700699
E: bakewell@elr.co.uk

Banner Cross
888 Ecclesall Road
Banner Cross
Sheffield S11 8TP
T: 01142 683388
E: bannercross@elr.co.uk

Dore
33 Townhead Road
Sheffield
S17 3GD
T: 0114 2362420
E: dore@elr.co.uk

Hathersage
Main Road, Hathersage
Hope Valley
Derbyshire S32 1BB
T: 01433 651888
E: peakdistrict@elr.co.uk

Rotherham
149 Bawtry Road
Wickersley
Rotherham S66 2BW
T: 01709 917676
E: wickersley@elr.co.uk



All rooms have been measured with electronic laser and are approximate measurements only. None of the services to the above property have been tested by ourselves, and we cannot guarantee that the installations described in the details are in perfect working order. Eadon Lockwood & Riddle for themselves, and for the vendors or lessors, produce these brochures in good faith, and are a guideline only. They do not constitute any part of a contract and are correct to the best of our knowledge at the time of going to press.