



6 ARRETON SQUARE MANCHESTER

£850 PCM

Student Accommodation Available 1st July 2026 £850pcm

Don't miss this attractive, self-contained ground floor apartment with its own entrance and a security entry system. This apartment has been fully renovated to include a fitted bathroom, kitchen, as well as a large living area and spacious double bedroom. Just off Dickenson Road, a five minute walk to the famous Curry Mile and situated next to major bus routes into Manchester City Centre and to the universities.

Property Reference: P1005

- 12 month tenancy
- Deposit equivalent to 5x weekly rent
- Holding deposit equivalent to 1x weeks rent due to secure the property, this goes towards the total deposit due
- Tenant to arrange their own utilities

Don't miss out, contact the office and quote the property reference above to book your viewing today!

Disclaimer: These particulars are believed to be accurate but they are not guaranteed and do not form a contract. Any images, videos and/or floorplans on this brochure are for guidance purposes only and are not necessarily to scale.



- 1 Bedroom • Flat • Rusholme • Fully furnished • 1 Bathroom/shower room • Shared gardens • Bills not included • 24HR Cover





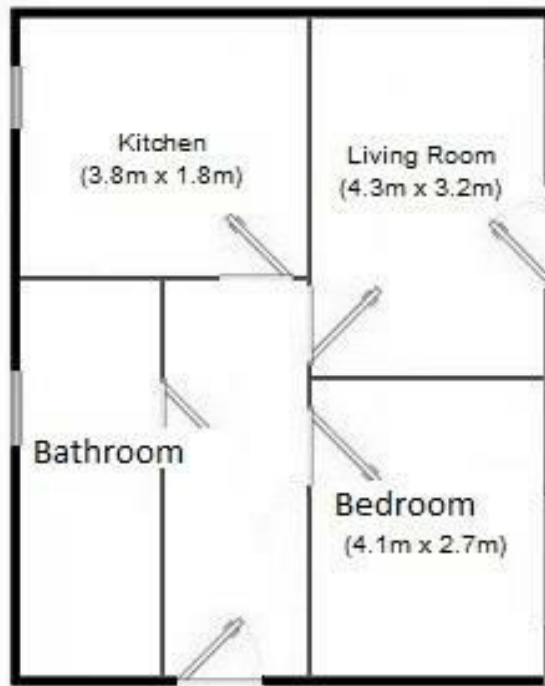

Energy Efficiency Rating		
	Current	Potential
Very energy efficient - lower running costs		
(92 plus) A		
(81-91) B		
(69-80) C	72	74
(55-68) D		
(39-54) E		
(21-38) F		
(1-20) G		
Not energy efficient - higher running costs		
England & Wales		
EU Directive 2002/91/EC		

EPC Rating: C **Council Tax Band: A**

Agents Note: Whilst every care has been taken to prepare these particulars, they are for guidance purposes only. All measurements are approximate and are for general guidance purposes only and whilst every care has been taken to ensure their accuracy, they should not be relied upon and potential buyers/tenants are advised to recheck the measurements

Drake & Co
Anson Parade
161a Dickenson Road
Rusholme
Manchester
M14 5HZ

0161 224 2134
info@drakes.co.uk
<https://www.drakes.co.uk/>

