



Oversley Mill Park , Oversley Green

Alcester, B49 6LL

Jeremy
McGinn & Co 

Offers In The Region Of £130,000



'Oversley Mill Park' is situated on the outskirts of the market town of Alcester within a 5/10 minute walk of the many facilities the town has to offer.

Number 63 Oversley Park has a panoramic river front plot and is surrounded by garden with parking to the front. The accommodation has double glazing, mains electric and lpg gas heating and offers an open-plan living room with bow window to the rear with 'river view' opening to the fitted kitchen. There is also an entrance hall, bathroom and two bedrooms, both with built-in wardrobes.

Offered For Sale with No Upward Chain.



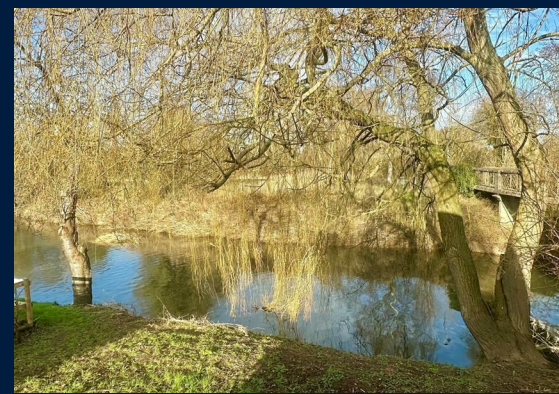

Tax Band: A

Council: Stratford

Tenure: Leasehold

Ground Rent £165.00 pcm



Floor Plan

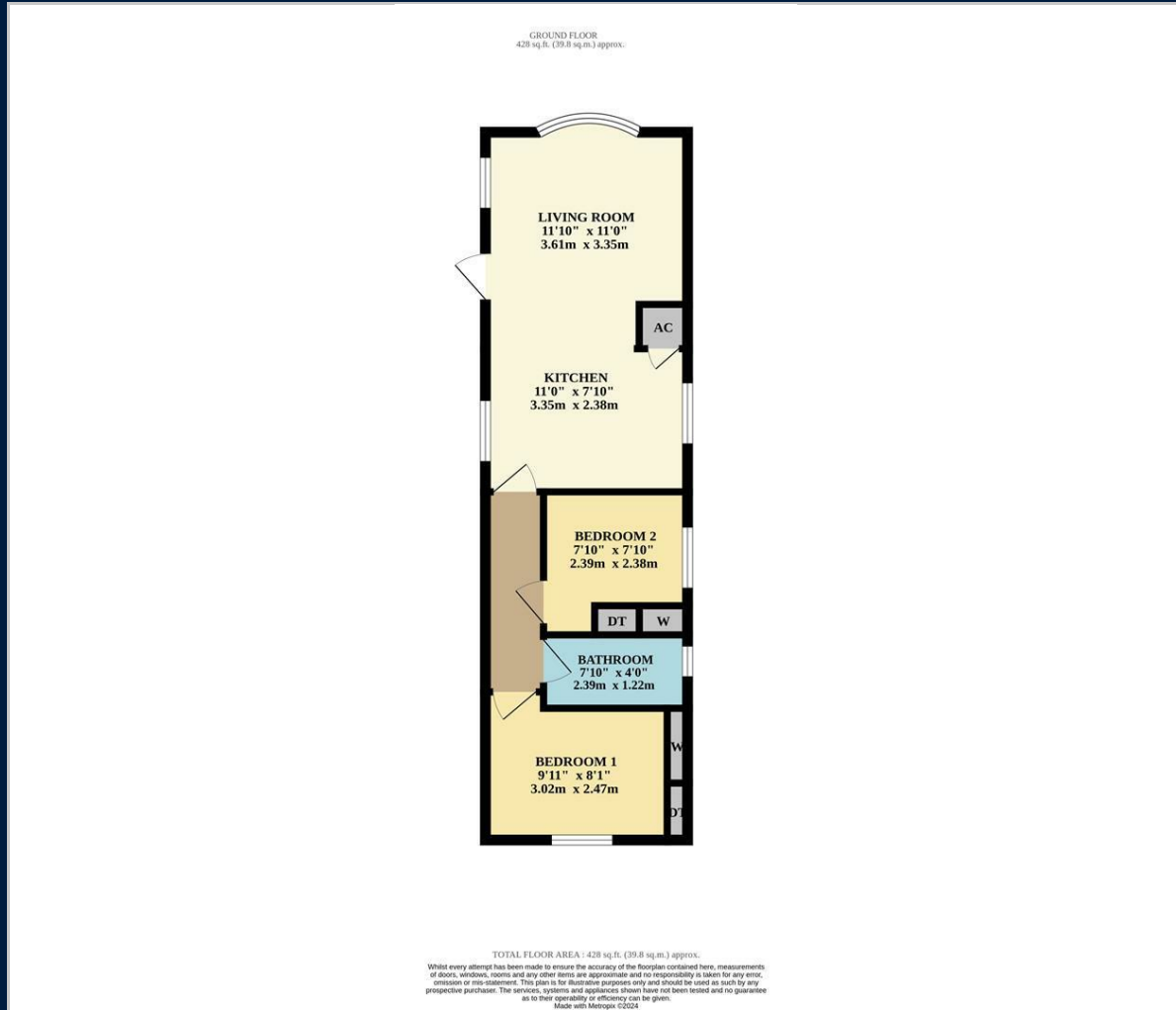

Map

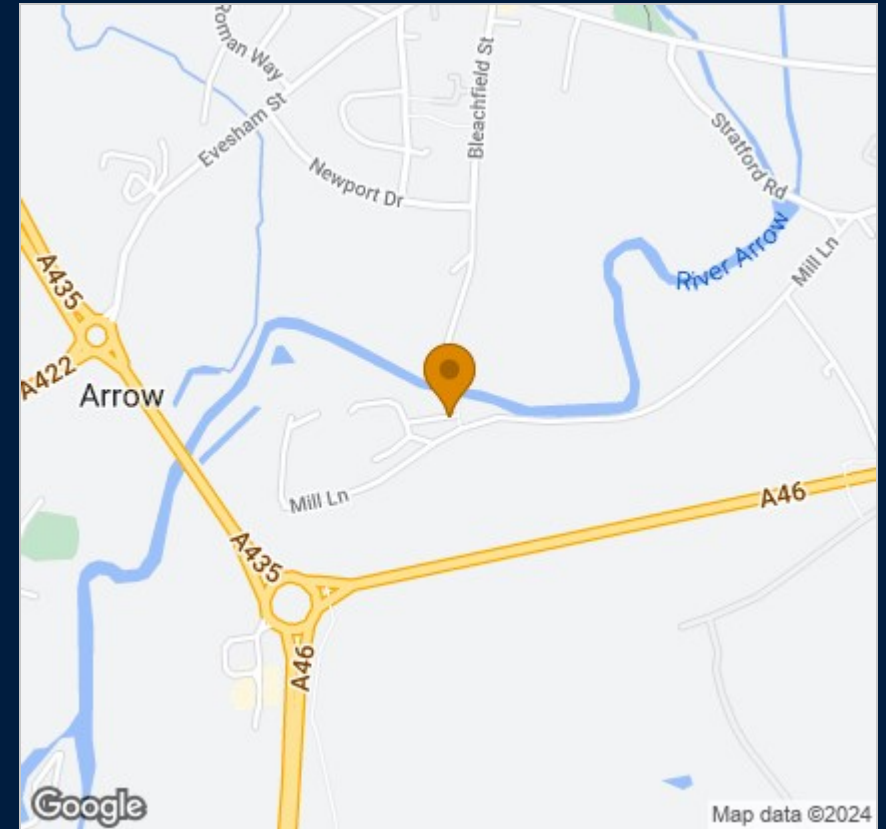

Energy Performance



These particulars, whilst believed to be accurate are set out as a general outline only for guidance and do not constitute any part of an offer or contract. Intending purchasers should not rely on them as statements of representation of fact, but must satisfy themselves by inspection or otherwise as to their accuracy. No person in this firm's employment has the authority to make or give any representation or warranty in respect of the property.

49A High Street, Alcester, Warwickshire, B49 5AF
Tel: 01789 868587 Email: alcester@jeremymcginns.com www.jeremymcginns.com