



St Helens Road, Ormskirk, L39



2



1



1

£120,000

- NO ONWARD CHAIN
- Ground Floor Flat
- Open Plan Kitchen/Family Room
- 2 Double Bedrooms
- TOWN CENTRE LOCATION
- Secure Gated Access
- Leasehold
- EPC rating C



Prime Ormskirk Location - Two Bedroom Ground Floor Apartment offered for sale with NO ONWARD CHAIN.

Located right in the heart Prime Ormskirk Location - Two Bedroom Ground Floor Apartment Requiring Modernisation of Ormskirk town centre, this spacious two-bedroom ground floor apartment offers an exciting opportunity for buyers looking to refresh and modernise a home to their own taste. Set within an attractive and well-kept development, the property is perfectly positioned for easy access to Ormskirk's vibrant shops, cafes, markets, and excellent transport links.



The apartment features a generous open-plan kitchen and family room, providing a versatile space ideal for everyday living and entertaining. There are two well-proportioned bedrooms along with a bathroom ready for modernisation, allowing buyers to create a fresh and inviting suite.

Being on the ground floor, the property also offers convenient level access and sits within a development with neatly maintained communal areas and resident parking.

This is a rare chance to secure a centrally located home in one of Ormskirk's most sought-after spots, with the added appeal of being able to add value through refurbishment.

Offered with no onward chain - early viewing is strongly recommended.

Disclaimer

These details are intended to give a fair description only and their accuracy cannot be guaranteed nor are any floor plans (if included) exactly to scale. These details do not constitute part of any contract and are not to be relied upon as statements of representation or fact. Intended purchasers are advised to recheck all measurements before committing to any expense and to verify the legal title of the property from their legal representative. Any contents shown in the images contained within these particulars will not be included in the sale unless otherwise stated or following individual negotiations with the vendor. Northwood have not tested any apparatus, equipment, fixtures, or services so cannot confirm that they are in working order and the property is sold on this basis.

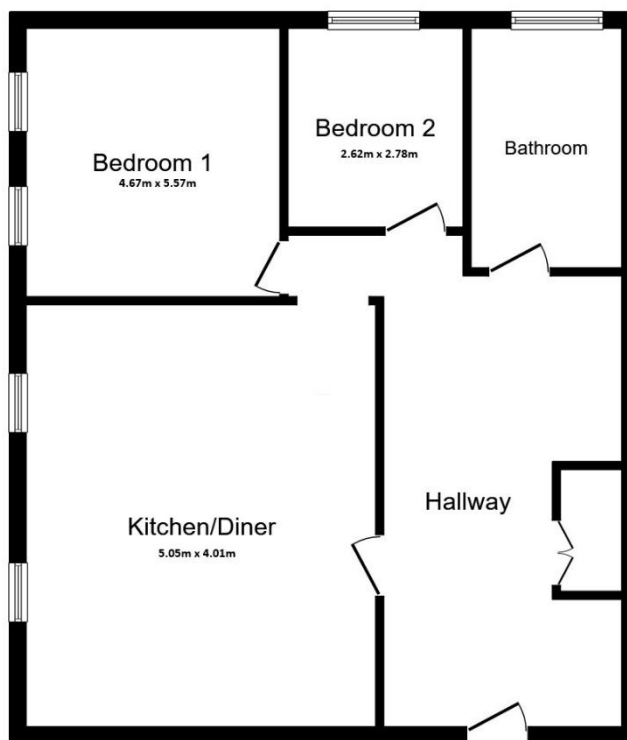

Floor Plan

This floor plan is for illustrative purposes only. It is not drawn to scale. Any measurements, floor areas (including any total floor area), openings and orientations are approximate. No details are guaranteed, they cannot be relied upon for any purpose and do not form any part of any agreement. No liability is taken for any error, omission or misstatement. A party must rely upon its own inspection(s). Powered by www.Propertybox.io



Score	Energy rating	Current	Potential
92+	A		
81-91	B		
69-80	C	75 C	75 C
55-68	D		
39-54	E		
21-38	F		
1-20	G		