



Althorpe Drive, Kew, Southport, PR8



**£290,000**

- DETACHED TRUE BUNGALOW
- BEAUTIFULLY PRESENTED
- Living Room & Kitchen/Diner
- 2 Double Bedrooms
- Garage & Off-Road Parking
- Sunny Rear Garden
- Freehold
- EPC rating C



Northwood are delighted to present this beautiful detached true bungalow for sale, situated in a popular location with enviable access to Kew retail park and associated public transport links. The property is a charming blend of convenience and comfort, making it an attractive prospect for a range of potential buyers.

The bungalow features a neutrally decorated living room, adorned with large windows that infuse the space with an abundance of natural light. The kitchen is finished with a range of modern gloss cabinets complete with integrated appliances and a dedicated dining space, ideal for entertaining guests or enjoying family meals. The property also boasts two well-appointed bedrooms, the master of which benefits from built-in wardrobes, offering ample storage space. The second bedroom is a generous double, providing excellent accommodation for guests or family members.

Externally, the property does not disappoint either. To the front there is ample off-road parking provided by a paved driveway and an attached garage. To the rear is a generous sized, well-kept garden, providing ample outdoor space for relaxation or recreation.

In conclusion, this property, with its unique blend of location and features, provides an excellent proposition for those seeking a comfortable and convenient lifestyle in a popular residential area.

## Entrance Porch

Composite front door leading into enclosed porch with a window to the side aspect and door into...

## Living Room 5.01m x 4.28m (16'5" x 14'0")

Windows to front and side aspects creating a bright open feel. Wall mounted electric flame fire.

## Hallway

Doors leading to all room, generous size linen storage cupboard.

## Kitchen/Diner 6.18m x 3.27m (20'4" x 10'8")

An open kitchen/diner has patio doors out onto the rear garden and makes this the perfect space for family gatherings. The kitchen is finished with a range of modern gloss units with contrasting countertops and full range of integrated appliances including dishwasher, electric oven, induction hob and extractor. Ceiling spotlights and tiled floor.

## Bedroom One 3.03m x 4.35m (9'11" x 14'4")

A generous sized master bedroom has a window to the rear aspect and full range of built in mirrored wardrobes.

## Bedroom Two 2.17m x 3.81m (7'1" x 12'6")

Another double bedroom faces the front aspect and has plenty of space for freestanding furniture.

## Shower Room 1.87m x 1.78m (6'1" x 5'10")

A modern shower room is finished with a walk-in shower enclosure, wall mounted sink basin and WC. Fully tiled walls, floor and ceiling spotlights.

## External

Externally, the property does not disappoint either. To the front there is ample off-road parking provided by a paved driveway and an attached garage. Whilst to the rear is a generous sized, well-kept garden, providing ample outdoor space for relaxation or recreation.

## Disclaimer

These details are intended to give a fair description only and their accuracy cannot be guaranteed nor are any floor plans exactly to scale. These details do not constitute part of any contract and are not to be relied upon as statements of representation or fact. Intended purchasers are advised to recheck all measurements before committing to any expense and to verify the legal title of the property from their legal representative. Any contents shown in the images contained within these particulars will not be included in the sale unless otherwise stated or following individual negotiations with the vendor. Northwood have not tested any apparatus, equipment, fixtures, or services so cannot confirm that they are in working order and the property is sold on this basis.



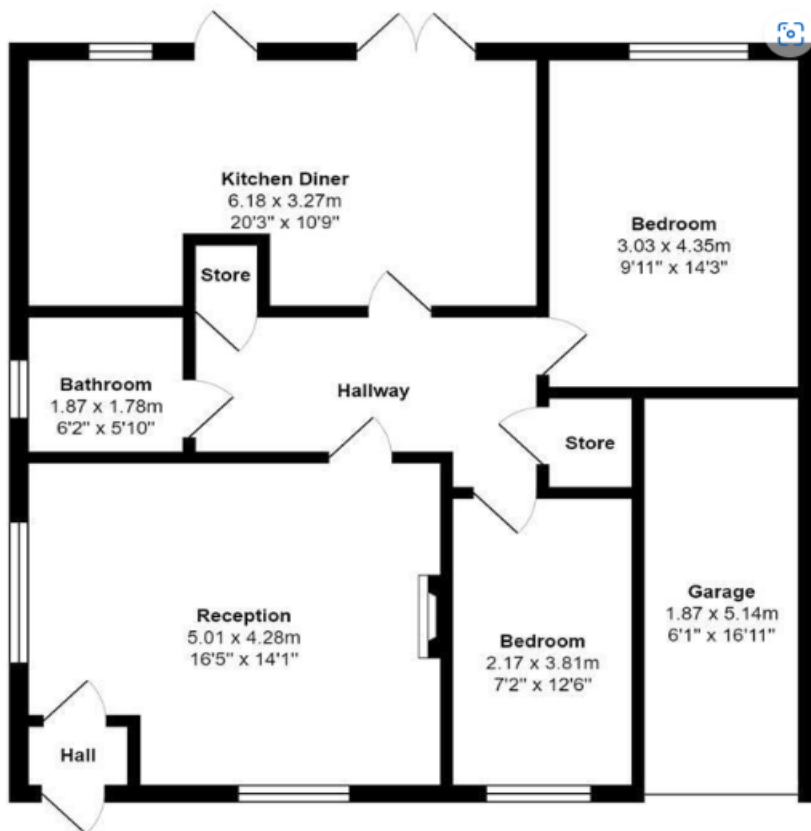

Total Area: 90.4 m<sup>2</sup> ... 973 ft<sup>2</sup>

All measurements are approximate and for display purposes only



Score	Energy rating	Current	Potential
92+	A		
81-91	B		85   B
69-80	C	71   C	
55-68	D		
39-54	E		
21-38	F		
1-20	G		



Northwood Southport and Ormskirk

01704 545 657

southport@northwooduk.com