



Sandown Road

Watford, WD24 7PL

£240,000



One Double bedroom second floor flat is situated Chiswell Court, North Watford.

The property comprises a modern fitted kitchen, lounge/ dining room, modern bathroom with shower over bath, double bedroom with fitted wardrobes and loft access for storage. Permit parking for residents and communal gardens.

Located within walking distance to Watford Junction Train station and within close proximity to major road links, local shops and amenities.



Area Map



Floor Plans

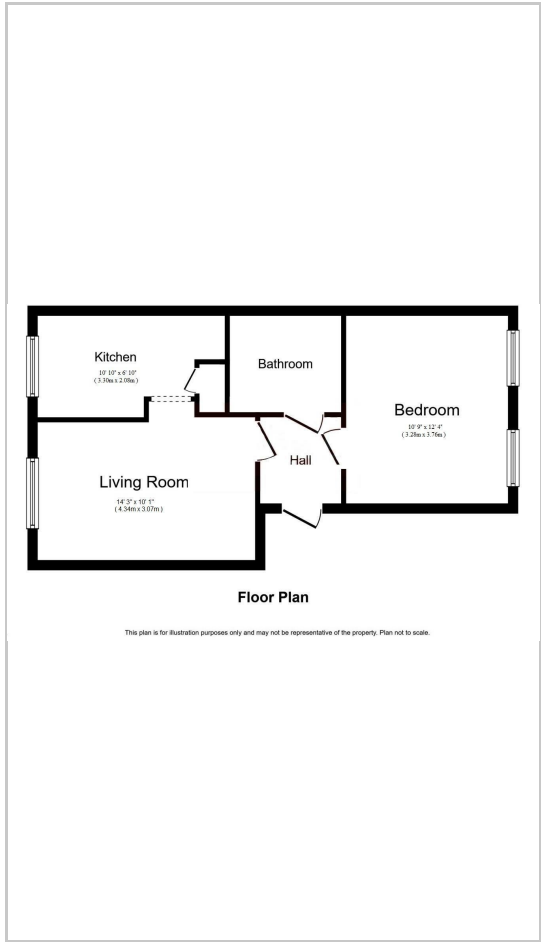

Energy Efficiency Graph

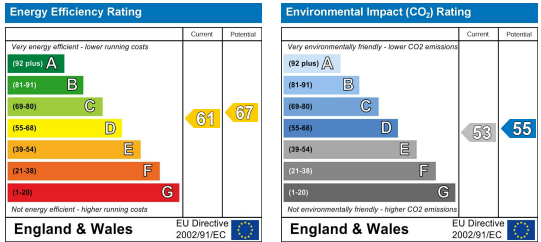

These particulars, whilst believed to be accurate are set out as a general outline only for guidance and do not constitute any part of an offer or contract. Intending purchasers should not rely on them as statements of representation of fact, but must satisfy themselves by inspection or otherwise as to their accuracy. No person in this firm's employment has the authority to make or give any representation or warranty in respect of the property.