

TQ

BOATHOUSE

TO LET - Refurbished Offices with sea views and on site parking



**AVAILABLE
TO LET
EARLY 2020**

Boathouse office accommodation

The Boathouse at Town Quay offers everything you could need for a growing business, with its own self-contained building, boasting spectacular views of Southampton Water and 1275 sq m (13,724 sq ft) of flexible space across 4 floors.

Ground floor	574 sq m	6,179 sq ft
First floor	537 sq m	5,780 sq ft
Second floor	164 sq ft	1,765 sq ft
Third floor	Two flats	
Total	1275 sq m	13,724 sq ft

Refurbished offices include:

- Air conditioning
- Visitor and allocated car parking
1 space per 254 sq ft
- Free use of BBQ area with stunning views across the marina
- On site cycle storage
- Kitchen facilities
- Showers
- Suspended ceilings
- Double glazing
- 2 Self contained flats with separate entrance
- Outdoor balconies
- Large roof terraces

**THE QUAY FOR
INSPIRATION**

TOWNQUAY.COM
SOUTHAMPTON SO14 2AQ

THE QUAY FOR CREATIVITY & CONNECTION

Working by the water connects us with nature, allowing unrestricted freedom of thought, enhanced wellbeing and increased productivity.

The Boathouse at Town Quay boasts exceptional views of Southampton Water and Town Quay Marina, while providing a city centre business location with excellent road, rail and ferry links, creating a unique environment for your business employees and a perfect work-life balance.

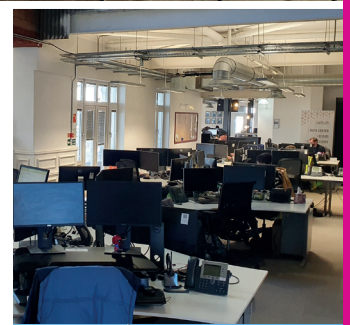
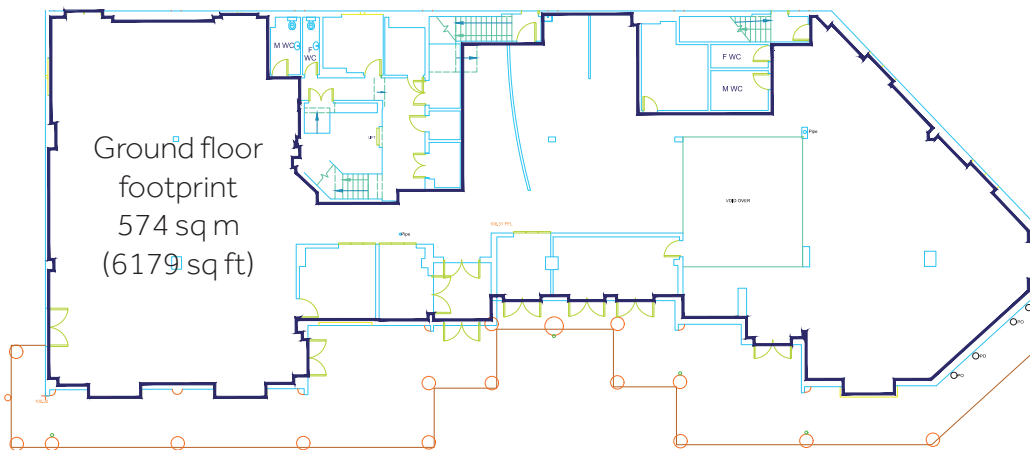

For further information, or to arrange a viewing, contact Vail Williams or JLL



ABP Property has the land, the space and the in-house funding to deliver existing or bespoke property solutions. With 960 hectares of available port-based development land and a wealth of experience in the provision of industrial, logistics and office space, talk to us about how we can help you.

