

Brunswick Road, Kingston Upon Thames, KT2

Monthly Rental Of £1,400 Freehold

1 Bedrooms | 1 Bathrooms | 1 Reception

IVY GATE™



Summary:

Ivy Gate are very proud to present to market this beautiful ground floor period conversion flat, decorated to a very high standard throughout whilst retaining its character and charm. The property comprises; communal rear garden with access from the back of the property, entrance hallway, spacious reception room with high ceilings and an open plan modern kitchen accessed via the reception room as well as a large double bedroom. The property further benefits from sash windows, substantial storage and a lovely family bathroom. Brunswick Road is a quiet residential road within a few minutes walking distance of Kingston Town Centre and even closer to Norbiton Mainline Station, the property also offers access to several bus routes. Kingston offers some of the best shopping facilities outside central London and has a wide array of bars and restaurants

One Bedroom Ground Floor Flat

Period Conversion

Immaculate Condition

Direct Access To Communal Garden

Excellent Public Transport

EPC Rating D

Brunswick Road, Kingston Upon Thames, KT2

Monthly Rental Of £1,400 Freehold

1 Bedrooms | 1 Bathrooms | 1 Reception

IVY GATE™

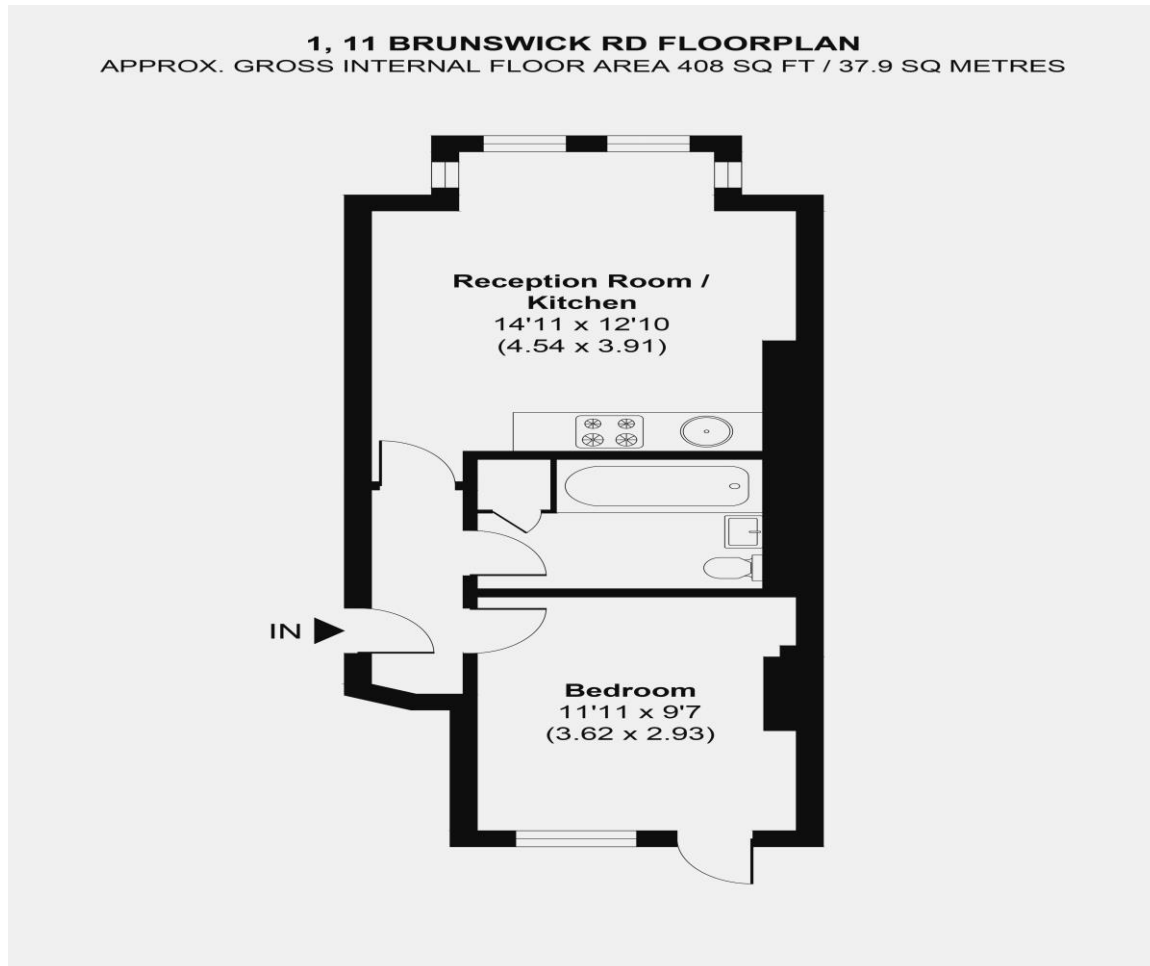

Tenure: Freehold

Council Tax: B

Local Authority: Royal Borough of Kingston upon Thames

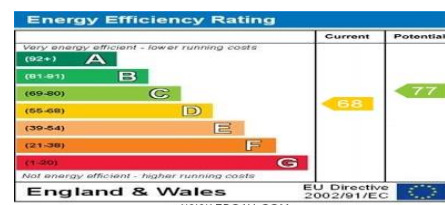

MONEY LAUNDERING REGULATIONS 2003

Intending purchasers will be asked to produce identification and proof of financial status when an offer is received. We would ask for your co-operation in order that there will be no delay in the offer process.

THE PROPERTY MISDESCRIPTIONS ACT 1991

The agent has not tested any apparatus, equipment, fixtures and fittings or services and so cannot verify that they are in working order or fit for the purpose. A Buyer is advised to obtain verification from their Solicitor or Surveyor. References to the Tenure of a Property are based on information supplied by the Seller. The Agent has not had sight of the title documents. The mention of any appliances and services within these details does not imply that they are in full and efficient working order. These particulars are intended as a guide and act as information to prospective buyers. They are not an offer or contract, or part of one. All details, areas, measurements floorplans and distances referred to are given as a guide only and should not be relied upon, they are approximate and illustrative only and **not to scale**. Lease details, service charges and ground rent (where applicable) are given as a guide only and the agent has not had sight of the original documentation, they should be checked by your solicitor prior to exchange of contracts.