

Ewell Court Avenue, Epsom, KT19

£565,000 Freehold

3 Bedrooms | 2 Bathrooms | 1 Reception

IVY GATE™



Summary:

Ivy Gate are delighted to offer to the market this extended three bedroom semi-detached bungalow situated in the extremely sought after area of Ewell Court Park and within walking distance of Ewell Village. Property comprises; two double and one single bedroom, with the main bedroom boasting an ensuite bathroom, a modern family bathroom, fully fitted kitchen that provides direct access to the rear garden which in turn extends to approximately 65ft and is mostly laid to lawn and a cosy rear reception room which provides further views of the tranquil garden. Close by are local shops and amenities and there are also excellent transport links and for the motorist, the A3 is within easy reach

Large garden

Driveway

En-suite bathroom

New Carpets throughout

No Chain

Ewell Court Avenue, Epsom, KT19

£565,000 Freehold

3 Bedrooms | 2 Bathrooms | 1 Reception

IVY GATE™

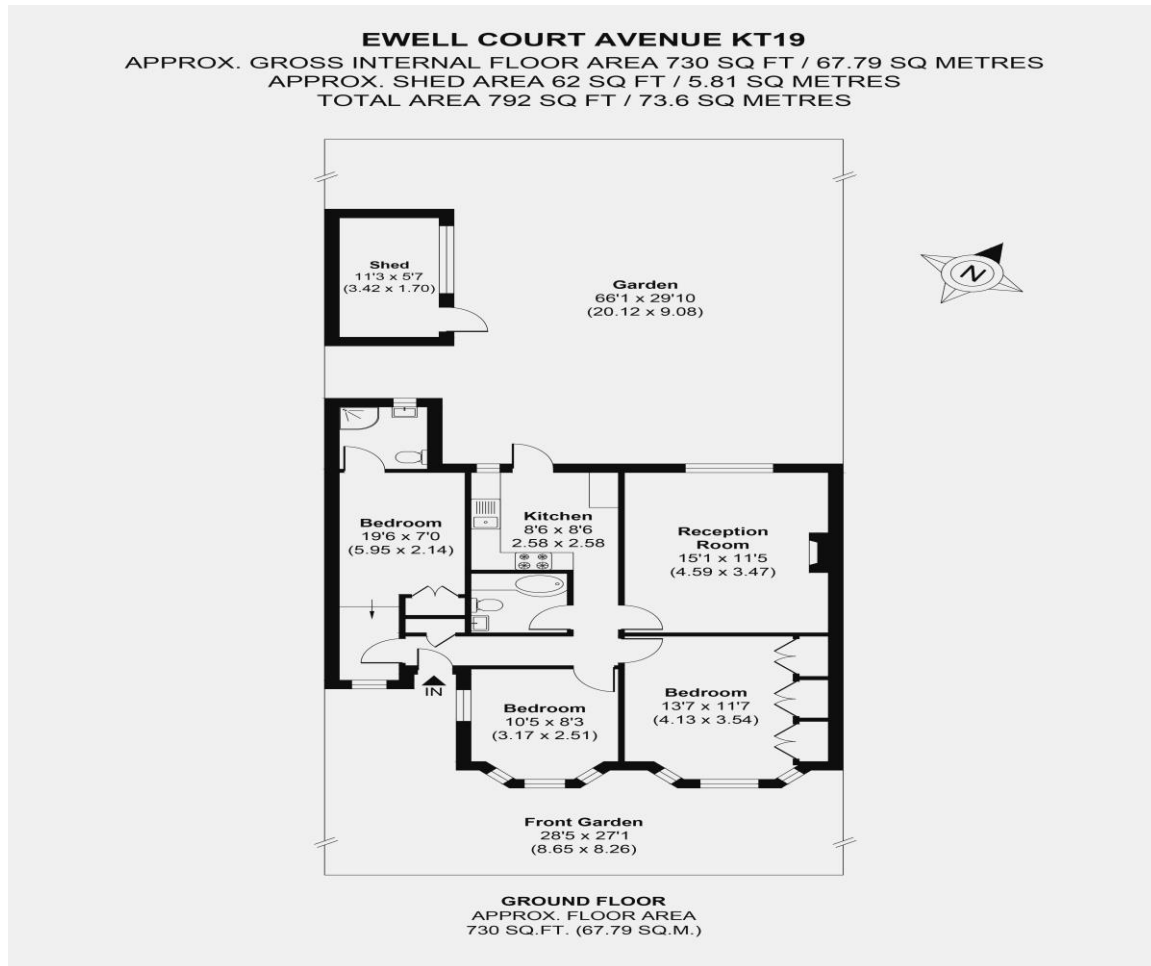

Tenure: Freehold

Council Tax: D

Local Authority: Epsom & Ewell Borough Council

EPC Rating: C

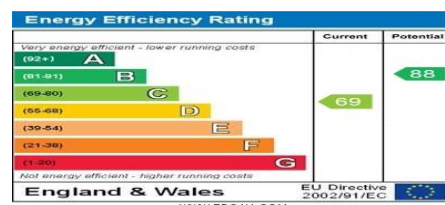

MONEY LAUNDERING REGULATIONS 2003

Intending purchasers will be asked to produce identification and proof of financial status when an offer is received. We would ask for your co-operation in order that there will be no delay in the offer process.

THE PROPERTY MISDESCRIPTIONS ACT 1991

The agent has not tested any apparatus, equipment, fixtures and fittings or services and so cannot verify that they are in working order or fit for the purpose. A Buyer is advised to obtain verification from their Solicitor or Surveyor. References to the Tenure of a Property are based on information supplied by the Seller. The Agent has not had sight of the title documents. The mention of any appliances and services within these details does not imply that they are in full and efficient working order. These particulars are intended as a guide and act as information to prospective buyers. They are not an offer or contract, or part of one. All details, areas, measurements floorplans and distances referred to are given as a guide only and should not be relied upon, they are approximate and illustrative only and **not to scale**. Lease details, service charges and ground rent (where applicable) are given as a guide only and the agent has not had sight of the original documentation, they should be checked by your solicitor prior to exchange of contracts.