



**Wenlock Drive, West Bridgford, Nottingham, NG2 6UB**

Guide Price £170,000-£180,000 Leasehold

  
**MARTIN & CO**



# Wenlock Drive, West Bridgford

2 Bedrooms, 1 Bathroom

Guide Price £170,000-£180,000

- Two Bedroom First Floor Apartment
- Quiet Location
- Private Balcony
- No Onward Chain
- Allocated Parking Space
- Popular Development
- Leasehold

GUIDE PRICE £170,000-£180,000. Well presented throughout, this two bedroom first floor apartment sits an enviable position, quietly nestled to the rear of this popular development. Being offered with no onward chain the property comprises of a hallway, spacious lounge/diner, fitted kitchen, two bedrooms and a bathroom. The apartment also enjoys a private balcony, overlooking the leafy and well maintained grounds and an allocated parking space. Early viewing is strongly recommended.



Energy Efficiency Rating			
Score	Energy rating	Current	Potential
92+	A		
81-91	B		
69-80	C	79   C	82   B
55-68	D		
39-54	E		
21-38	F		
1-20	G		

**HALLWAY** With an entrance porch, fitted carpet, wall mounted radiator, intercom system, storage cupboard, airing cupboard and two ceiling lights.

**LOUNGE/DINER** 15' 1" x 13' 6" (4.6m x 4.11m) With a fitted carpet, two uPVC double glazed windows to the front elevation, two wall mounted radiators and two ceiling lights.

**KITCHEN** 9' 5" x 8' 8" (2.87m x 2.64m) With a range of fitted high and low level units with a rolled edge worktop over incorporating a stainless steel sink and drainer, splashback tiling, integrated electric oven, inset gas hob with extractor hood over, washing machine plumbing and slimline dishwasher plumbing, wood effect vinyl flooring, ceiling light and uPVC double glazed French doors leading out to the private balcony.

**MASTER BEDROOM** 13' 3" x 8' 10" (4.04m x 2.69m) With a fitted carpet, uPVC double glazed window to the rear elevation, wall mounted radiator and ceiling light.

**BEDROOM TWO** 9' 6" x 7' 7" (2.9m x 2.31m) With a fitted carpet, uPVC double glazed window to the rear elevation, wall mounted radiator and ceiling light.

**BATHROOM** Comprising of a panelled bath with a mains fed mixer bar shower over, low flush w.c., pedestal wash hand basin, wood effect vinyl floor covering, wall mounted radiator, opaque uPVC double glazed window to the rear elevation, part wall tiling and ceiling light.

**EXTERNAL** The property enjoys a private balcony overlooking the well maintained grounds and an allocated parking space.









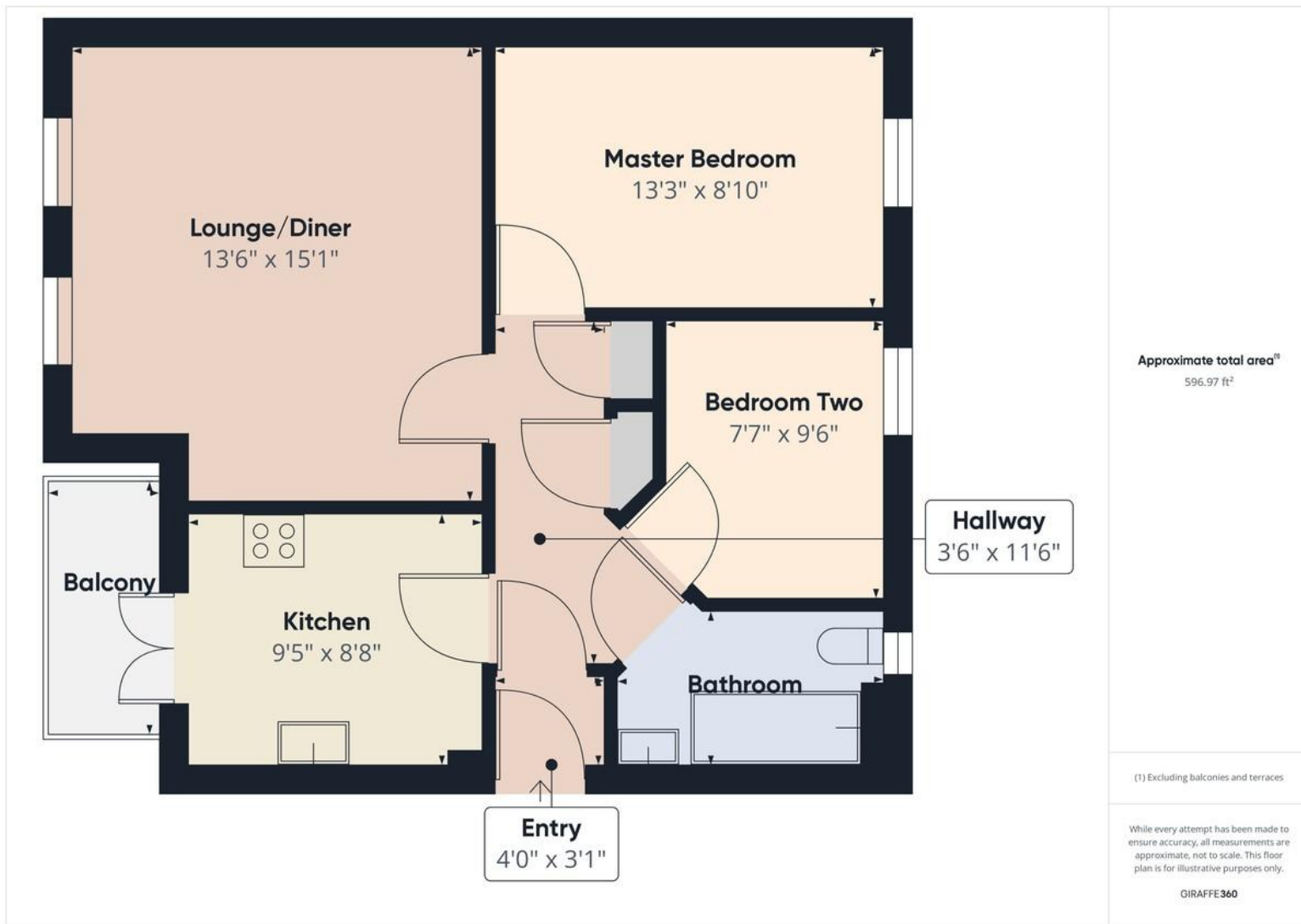

## Martin & Co Beeston

23 Wollaton Road • Beeston • Nottingham • NG9 2NG  
T: 0115 9225555 • E: beeston@martinco.com

# 0115 9225555

<http://www.martinco.com>



**Accuracy:** References to the Tenure of a Property are based on information supplied by the Seller. The Agent has not had sight of the title documents. A Buyer is advised to obtain verification from their Solicitor. Items shown in photographs including but not limited to carpets, fixtures and fittings are not included unless specifically mentioned within the sales particulars. They may however be available by separate negotiation. Buyers must check the availability of any property and make an appointment to view before embarking on any journey to see a property. No person in the employment of the agent has any authority to make any representation about the property, and accordingly any information given is entirely without responsibility on the part of the agents, sellers(s) or lessors(s). Any property particulars are not an offer or contract, nor form part of one. **Sonic / Laser Tape:** Measurements taken using a sonic / laser tape measure may be subject to a small margin of error. **All Measurements:** All Measurements are Approximate. **Services Not tested:** The Agent has not tested any apparatus, equipment, fixtures and fittings or services and so cannot verify that they are in working order or fit for the purpose. A Buyer is advised to obtain verification from their Solicitor or Surveyor.