

Hammersmith Grove, Brackenbury Village, W6

Kinleigh Folkard & Hayward





Hammersmith Grove, Brackbury Village, W6

OIEO

£800,000

Leasehold

A 2 bed bespoke apartment leading to a 62'6ft private garden.

- Two Bed Garden Flat
- Over 60ft Private Garden
- Two Baths
- Bespoke Finish
- Brackbury Village
- Newly Refurbished
- Own Front Door
- EPC rating D

A 2 bed 2 bath garden flat finished to a very high standard on Hammersmith Grove. This property has open living with bi folding doors leading to a 62'6ft private garden.

For more information or to arrange a viewing please contact:

Brook Green

134 Shepherds Bush Road
Brook Green, W6 7PB
020 3542 2020
brookgreen.sales@kfh.co.uk

Kinleigh Folkard & Hayward



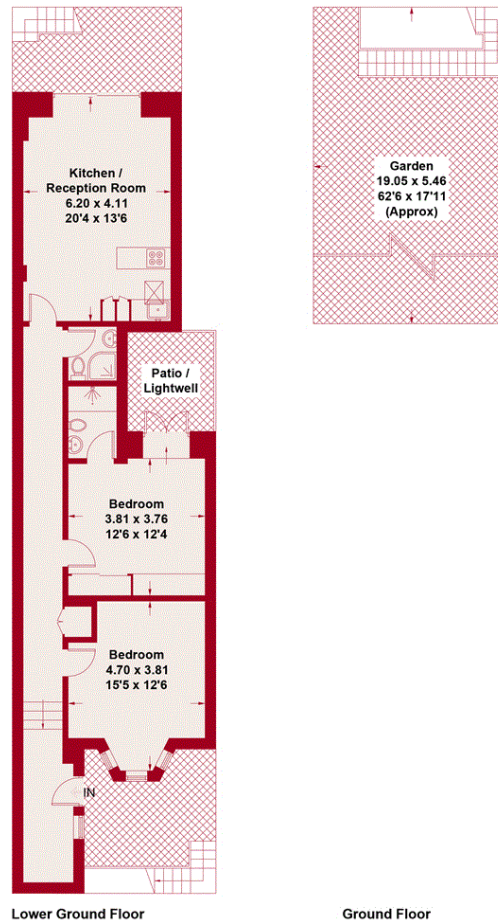

Hammersmith Grove

Approximate Gross Internal Area = 81.1 sq m / 873 sq ft

Patio / Lightwell = 6.6 sq m / 71 sq ft

Total = 87.7 sq m / 944 sq ft



Illustration for Identification Purpose Only. Not to Scale.

These particulars are believed to be correct but their accuracy is not guaranteed and they do not form part of any contract. Whilst every effort is made to ensure the accuracy of these details, it should be noted that the above measurements are approximate only. Floorplans are for representation purposes only and prepared according to the RICS Code of Measuring Practice by our floorplan provider. Therefore, the layout of doors, windows and rooms are approximate should be regarded as such by any prospective purchaser. Any internal photographs are intended as a guide only and it should not be assumed that any of the furniture/fittings are included in any sale. Where shown, details of lease, ground rent and service charge are provided by the vendor and their accuracy cannot be guaranteed, as the information may not have been verified and further checks should be made either through your solicitor/conveyancer or by referring to the home information pack for this property. Where appliances, including central heating, are mentioned, it cannot be assumed that they are in working order, as they have not been tested. Please also note that wiring, plumbing and drains have not been checked.

