



1 Coopers Cottages Bletchingley Road.

Nutfield

In Excess of £700,000



1 Coopers Cottages.

Nestled in the picturesque village of Nutfield, this beautiful gated four bedroom halls a joining semi-detached house offers a truly idyllic family home experience. Built in 2005, this property welcomes you with three inviting reception rooms - a spacious sitting room featuring a large fireplace and bay window, an open plan kitchen/dining room perfect for entertaining, and a separate living room with garden access. The property boasts four generous double bedrooms, including a master bedroom with built-in wardrobes and a luxurious en-suite featuring a large bath-tub. The large single garage and ample secure parking via electric gates provide convenience and security, making this home both stylish and practical. Surrounded by countryside, this residence in Nutfield is the epitome of tranquillity and comfort, offering an exquisite living space for the discerning homeowner.

Step out into the expansive rear garden, a haven of serenity and relaxation. The private secure parking accessed via electric gates ensures both convenience and peace of mind. Experience the joy of outdoor living in this charming property, where you can create lasting memories with family and friends against a backdrop of natural beauty. Nutfield itself is a sought-after village, renowned for its excellent schools and close proximity to nature, offering a perfect blend of community charm and rural escape. Don't miss this opportunity to make this delightful property your own, where every day feels like a retreat in your own little slice of heaven in the heart of the countryside.

Council Tax band: F

Tenure: Freehold





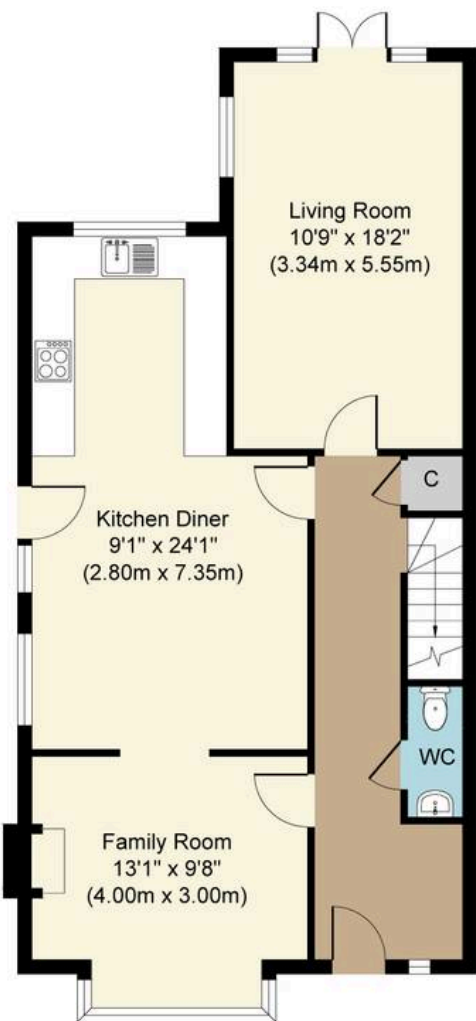

Ground Floor
Approximate Floor Area
793 sq. ft
(73.67 sq. m)

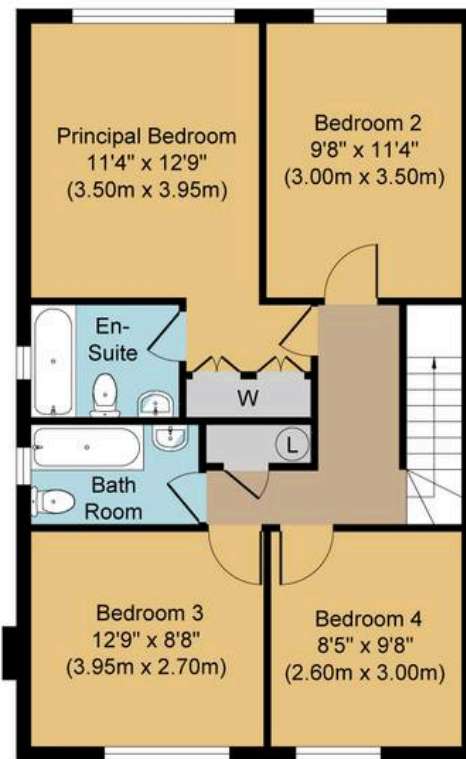

First Floor
Approximate Floor Area
687 sq. ft
(63.82 sq. m)

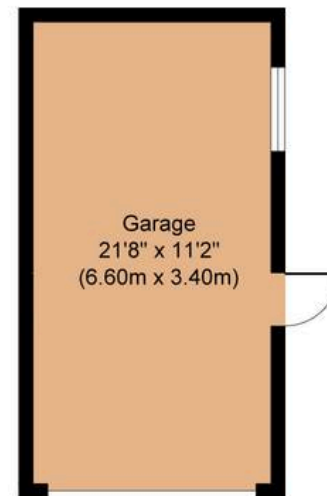

Garage
Approximate Floor Area
242 sq. ft
(22.48 sq. m)



Bletchingley Road, RH1
Approx. Gross Internal Floor Area 1,722 sq. ft / 159.97 sq. m

Whilst every attempt has been made to ensure the accuracy of the floor plan contained here, measurements of doors, windows, rooms and any other items are approximate and no responsibility is taken for any error, omission, or mis-statement. The measurements should not be relied upon for valuation, transaction and/or funding purposes. This plan is for illustrative purposes only and should be used as such by any prospective purchaser or tenant. The services, systems and appliances shown have not been tested and no guarantee as to their operability or efficiency can be given.

