



melvyn
Danes
ESTATE AGENTS

Vera Road

Yardley

Offers Over £340,000

Description

A spacious, heavily extended and recently refurbished semi detached house on a sought after road in Yardley with no onward chain.

This lovely property will make a great family home and is in a superb location near to a wealth of facilities, schools and transport links.

Comprising enclosed porch, entrance hall, two reception rooms and an extended kitchen to the ground floor. On the first floor there are three bedrooms, the bathroom and a separate WC and on the second floor, two further bedrooms and a shower room.

Further benefiting from central heating, double glazing, driveway, rear garden, rear garage and rear parking.



Accommodation

Driveway

Enclosed Porch

6' x 2'5 (1.83m x 0.74m)

Entrance Hall

6' x 13' (1.83m x 3.96m)

Reception One

12'5 x 13'7 to bay (3.78m x 4.14m to bay)

Reception Two

11'9 max x 15'4 to bay (3.58m max x 4.67m to bay)

Extended Kitchen

18'11 max x 13'5 (5.77m max x 4.09m)

First Floor Landing

6'11 x 10'10 (2.11m x 3.30m)

Bedroom One

11'9 into wardrobe x 15' to bay (3.58m into wardrobe x 4.57m to bay)

Bedroom Two

11'9* max x 14'3 to bay (3.58m* max x 4.34m to bay)

Bedroom Five

6'9 x 6'10 (2.06m x 2.08m)

Bathroom

6'7 x 5'10 (2.01m x 1.78m)

Separate WC

2'5 x 3'2 (0.74m x 0.97m)

Second Floor Landing

6'6 x 7'10 (1.98m x 2.39m)

Bedroom Three

9'7 x 10'7 (2.92m x 3.23m)

Bedroom Four

9'7 x 10'7 (2.92m x 3.23m)

Shower Room

6'6 max x 8'8 max (1.98m max x 2.64m max)

Rear Garden

Rear Garage And Rear Parking



TENURE: We are advised that the property is FREEHOLD

BROADBAND: We understand that the standard broadband download speed at the property is around 8 Mbps, however please note that results will vary depending on the time a speed test is carried out. The estimated fastest download speed currently achievable for the property post code area is around 1800 Mbps. Data taken from checker.ofcom.org.uk on 19/11/2025. Actual service availability at the property or speeds received may be different.

MOBILE: We understand that the property is likely to have current mobile coverage (data taken from checker.ofcom.org.uk on 19/11/2025. Please note that actual services available may be different depending on the particular circumstances, precise location and network outages. VIEWING: By appointment only with the office on the number below.

These particulars are for general guidance only and are based on information supplied and approved by the seller. Complete accuracy cannot be guaranteed and may be subject to errors and/or omissions. They do not constitute representations of fact or form part of any offer or contract. Any Prospective Purchaser should obtain verification of all legal and factual matters and information from their Solicitor. Licensed Conveyancer or Surveyors as appropriate. The agent has not sought to verify the legal title of the property and the buyers must obtain verification from their solicitor. Photographs are provided for illustrative purposes only and the items shown in these are not necessarily included in the sale, unless specifically stated. The agent has not tested any apparatus, equipment, fixtures, fittings or services mentioned and do not by these Particulars or otherwise verify or warrant that they are in working order.

MONEY LAUNDERING REGULATIONS: Under anti-money laundering legislation, we are obliged to confirm the identity of individuals and companies and the beneficial owners of organisations and trusts before accepting new instructions, and to review this from time to time. To avoid the need to request detailed identity information from vendors and intending purchasers, we may use approved external services which review publicly available information on companies and individuals. However, should those checks, for any reason, fail adequately to confirm identity, we may write to you to ask for identification evidence. If you do not provide satisfactory evidence or information within a reasonable time, we may have to stop acting for you and we would ask for your co-operation in order that there will be no delay in agreeing a sale. Any purchaser who has a provisional offer accepted via this company will be liable to pay a purchase administration fee of £25 inclusive of VAT to cover these checks.

REFERRAL FEES: We may refer you to recommended providers of ancillary services such as Conveyancing, Financial Services and Surveying. We may receive a commission payment fee or other benefit (known as a referral fee) for recommending their services. You are not under any obligation to use the services of the recommended provider.

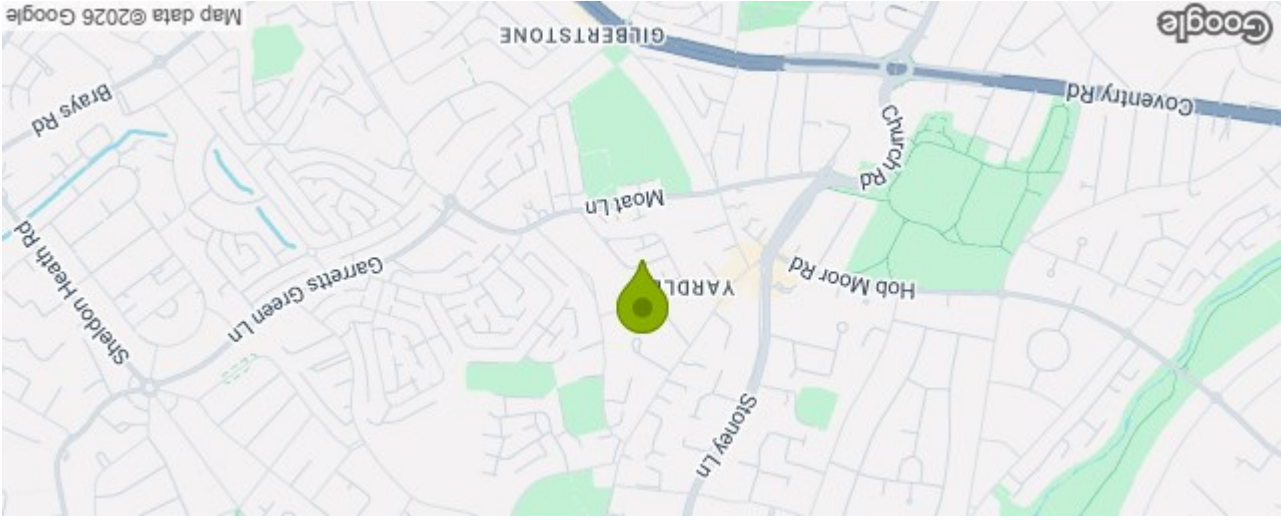

Ground Floor
Approx. 56.2 sq. metres (605.3 sq. feet)

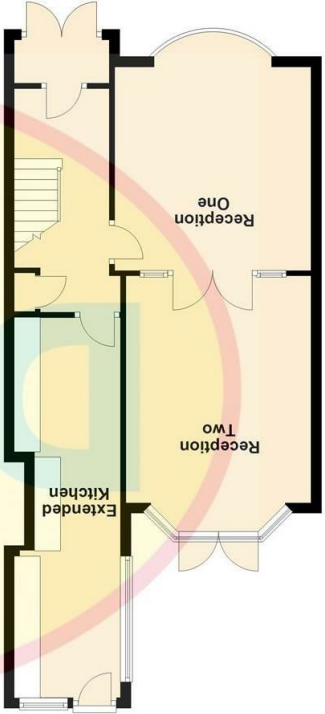

First Floor
Approx. 44.7 sq. metres (481.3 sq. feet)



Second Floor
Approx. 27.7 sq. metres (298.6 sq. feet)

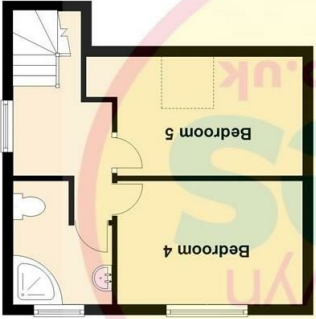

Total area: approx. 128.7 sq. metres (1385.2 sq. feet)

17 Vera Road Yardley Birmingham B26 1TU
Council Tax Band: C

Energy Efficiency Rating		
Very energy efficient - lower running costs		
(92 plus) A		
(81-91) B		
(69-80) C		
(55-68) D		
(39-54) E		
(21-38) F		
(1-20) G		
Not energy efficient - higher running costs		
Current		Potential
65		78
EU Directive 2002/91/EC		

Please note that all measurements and floor plans are approximate and quoted for general guidance only and whilst every attempt has been made to ensure accuracy, they must not be relied on and do not form part of any contract.