



Building & Project Consultancy  
The Lawns, 33 Thorpe Road,  
Peterborough, PE3 6AB  
01733 233445  
rory.addisonsmith@eddisons.com

COPYRIGHT OF EDDISONS COMMERCIAL LTD ALL RIGHTS RESERVED. DRAWING NOT TO BE REPRODUCED WITHOUT EXPRESS PERMISSION.



### NOTES:

Do not scale from drawing except for the purpose of planning and all dimensions to be checked on site.

Drawings are indicative only and subject to CA approval following the Structural Engineer's and Contractor's design and drawings.

Exact setting out should be agreed with CA prior to commencement on site.

Drawings are subject to Building Control Approval.

### KEY:

Existing	—
New	—

PROJECT TITLE:  
LAKEVIEW-HOUSE  
BOND-AVENUE  
BLETCHLEY  
MILTON-KYNES  
MK1-1TJ

CLIENT:  
PETCHEY-INDUSTRIAL-PROPERTIES-LTD

DRAWING TITLE:  
LAKEVIEW-HOUSE  
PROPOSED-WAREHOUSE-GROUND-FLOOR

<b>DRAWN:</b> RS	<b>CHECKED:</b> RAS	<b>APPROVED:</b> RAS
---------------------	------------------------	-------------------------

<b>DATE:</b> 20-06-23	<b>SCALE:</b> 1:250	<b>PAPER SIZE:</b> A3
--------------------------	------------------------	--------------------------

**DRAWING STATUS:**  
TENDER

<b>DRAWING No:</b> -	<b>REVISION:</b> REV-B
-------------------------	---------------------------

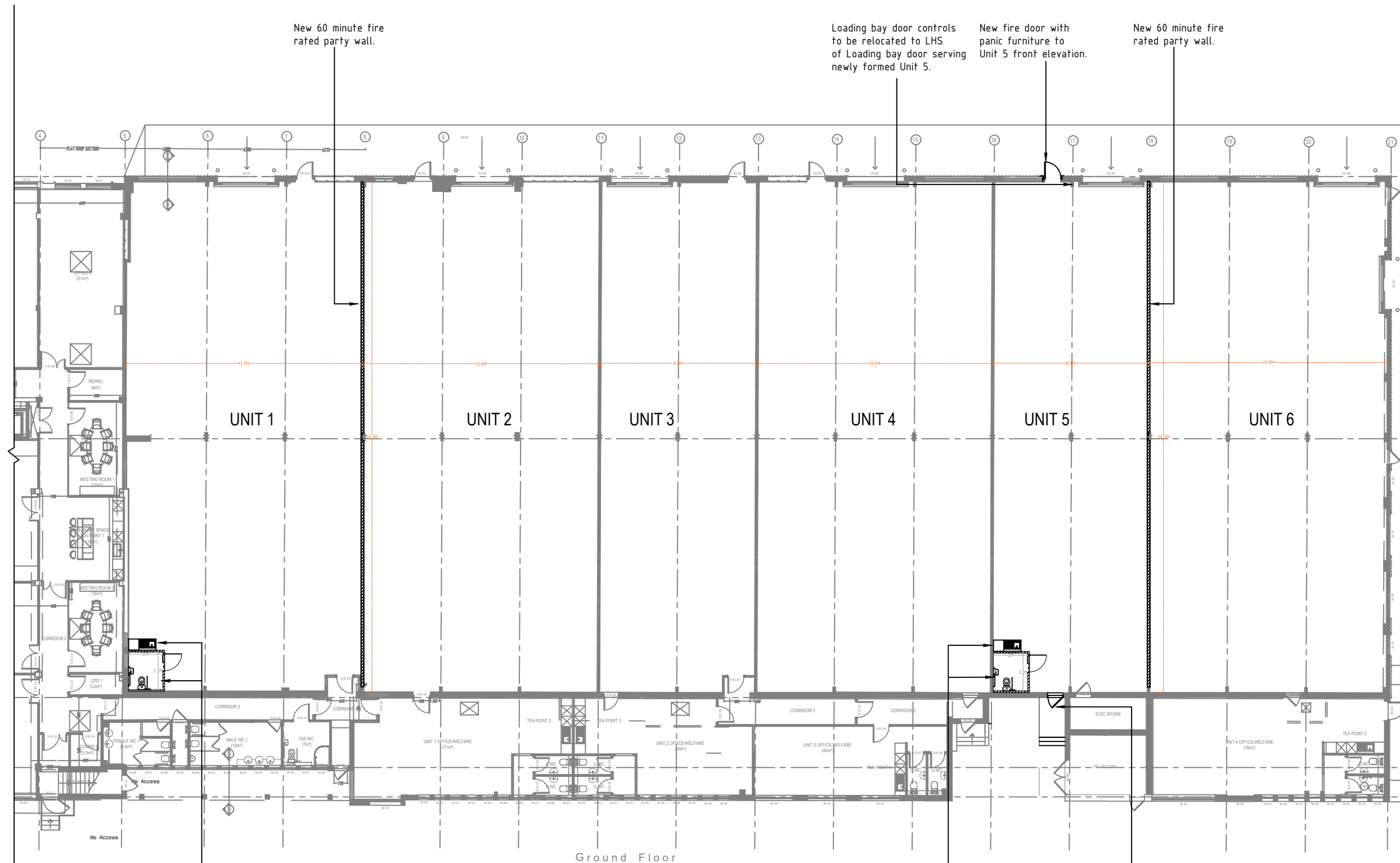

New 60 minute fire rated party wall.

Loading bay door controls to be relocated to LHS of Loading bay door serving newly formed Unit 5.

New fire door with panic furniture to Unit 5 front elevation.

New 60 minute fire rated party wall.

UNIT 1

UNIT 2

UNIT 3

UNIT 4

UNIT 5

UNIT 6

Ground Floor

Unit 1 New Kitchenette and Doc M Pack WC.

Unit 5 New Kitchenette and Doc M Pack WC.

New Fire Escape, inc. new fire door with panic furniture, stepped walkway and landing.