

Basement Plan as Existing

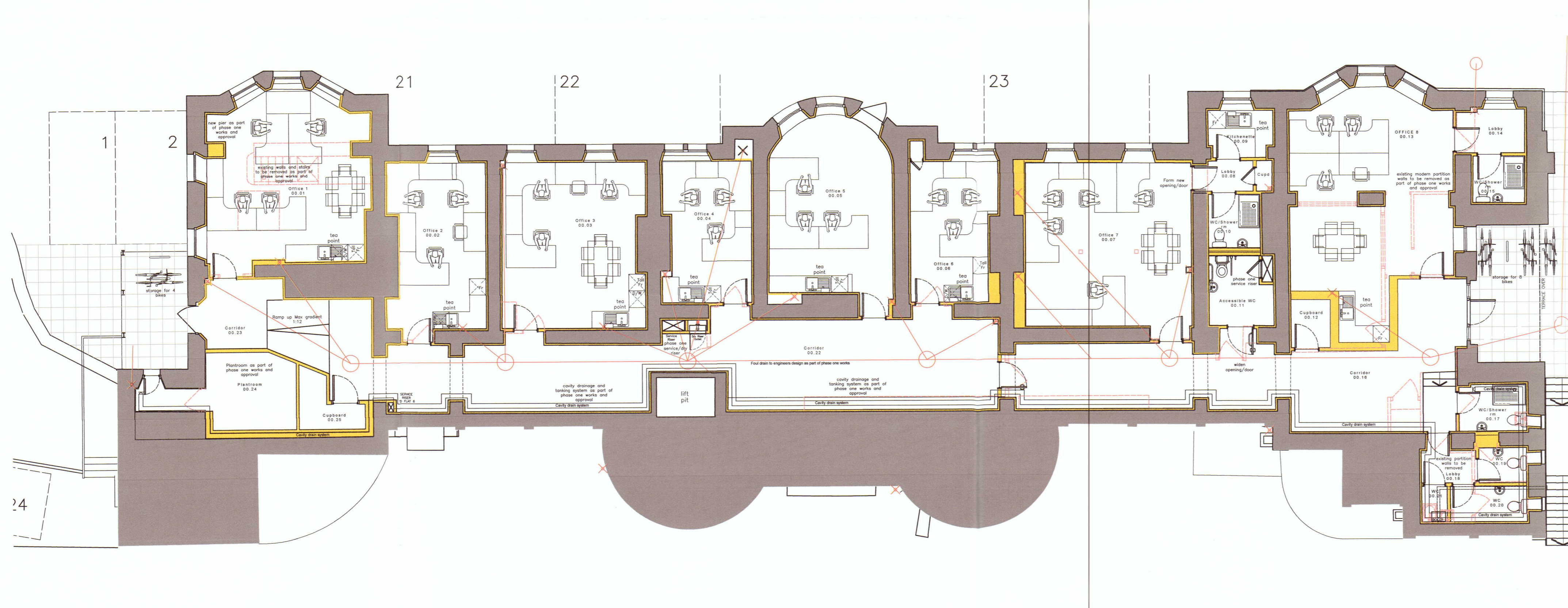

Basement Plan as Proposed

Proposed metal stud walls and dry lining

Plymouth City Council  
25 OCT 2018  
Planning Department

**Planning Application**

**CHA RTERED ARCHITECTS**  
**HEIGHWAY FIELD ASSOCIATES**  
Bradinch Court, Castle Street, Exeter, Devon. EX4 3PL.  
Tel : 01392 490800 Fax : 01392 499639  
E-Mail : architects@heighwayfield.co.uk Web Site : heighwayfield.co.uk

23.10.18	A	Planning Issue
18.10.18	P1	Provisional Issue
Date	No.	Rev.

Job	Client	
Royal Eye Infirmary	GBH (Devon) Ltd	
Apsley Road	Scale	Drawn
Mutley	1:100 @ A1	BG
Plymouth	Date	Checked
PL4 6PJ	Oct 2018	AF
Drawing	Drwg No.	Rev.
Basement Redevelopment	1815 - 102	A
Floor Plan as Existing & Proposed		

No dimensions to be scaled from this drawing. All sizes and dimensions to be verified on site. All dimensions on this drawing are in millimetres unless otherwise stated.

