



North Road, Darlington

Darlington



In Excess of £70,000



408 North Road

Darlington, Darlington

Discover Your Perfect Home: A Two-Bedroom End Terrace Property, now available for sale with no onward chain. This attractive option is ideal for both first-time buyers and investors seeking a promising opportunity. Nestled in the sought-after Harrowgate Hill area of Darlington Town, it offers a coveted location with convenient access to schools, shops, and public transport routes. Prime Location for Commuters: Situated just a short 5-minute drive from the A1 motorway, this property is a commuter's dream. Its enviable position grants easy access to both the north and south, ensuring a smooth and efficient journey. Embrace the convenience and save precious time on your daily travels. Comfortable and Versatile Living Spaces:

Step into this property and be greeted by a welcoming entrance hall, setting the tone for a cozy and inviting home. The lounge provides a relaxing space to unwind after a long day, while the well-appointed kitchen/diner offers ample room for culinary adventures and enjoyable meals with loved ones. With two generously sized bedrooms, there is plenty of space to create your own personal sanctuary. The family bathroom completes the picture, offering a practical and stylish space for your daily routines. Outdoor Area: Discover the delights of the rear enclosed yard area, a charming outdoor space ready to be transformed into your own oasis. Enjoy al fresco dining, create a vibrant garden retreat, or simply relax in the fresh air.

Arrange a Viewing: Don't miss the opportunity to see this remarkable property for yourself. To arrange a viewing and experience the potential of this enticing two-bedroom end terrace, please reach out to our dedicated office on 01227 722222. For more information, visit our website at www.darlingtonestateagents.co.uk



Vestibule

3'8 x 3'1 (1.14 x 0.96m)

Lounge

13'1 x 12'8 (3.99 x 3.88m)

Kitchen

8'8 x 12'11 (2.64 x 3.95m)

Rear hallway

3'1 x 3'0 (0.96 x 0.92m)

Bathroom

6'2 x 4'11 (1.90 x 1.50m)

Landing

2'10 x 2'9 (0.88 x 0.86m)

Bedroom 1

12'7 x 12'10 (3.84 x 3.92m)

Bedroom 2

9.4 x 13'0 (2.86 x 3.97m)



YARD









Northgate
estate agents

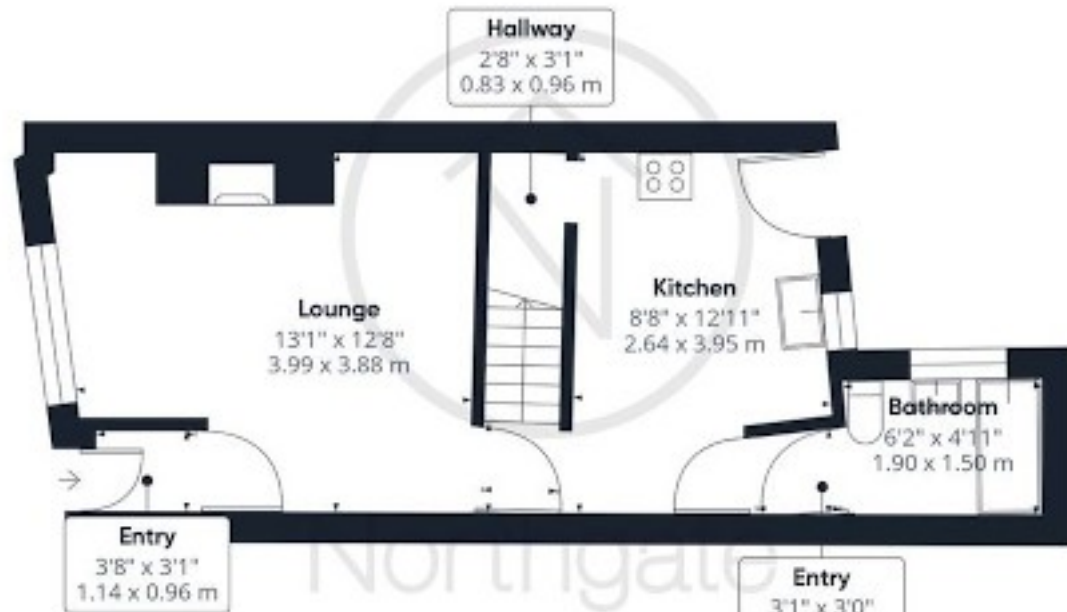

Ground Floor



Floor 1

Approximate total area⁽¹⁾

624.2 ft²

57.99 m²

(1) Excluding balconies and terraces

While every attempt has been made to ensure accuracy, all measurements are approximate, not to scale. This floor plan is for illustrative purposes only.

Calculations are based on RICS IPMS 3C standard.

GIRAFFE 360



Northgate - County Durham

Northgate Estate Agents, Suite 3 - DL5 4DH

01325 728333 • info@northgates.net • www.northgates.co.uk/



These particulars do not constitute, nor constitute part of, an offer or contract. No warranties are provided. Verify details through inspection. Northgate estate agents, nor any person in their employment has any authority to make or give any representation or warranty whatever in the relation to this property. All measurements are approximate.